



446 Derby Road
, Chesterfield, S40 2EU
£1,300 PCM



446 Derby Road

, Chesterfield, S40 2EU

Deceptively spacious 4 bedroom semi detached dormer bungalow located on Derby Road. The property offers 1088 sq ft of living accommodation and has a spacious kitchen/dining area which opens up into an airy conservatory overlooking a mature private garden. Also to the ground floor, there is a living room and the master bedroom, two bathrooms and dressing room/study/single bedroom. On the first floor there are two further bedrooms.

To the front of the property there is ample parking for several vehicles and gated access.

Rental information





Floor Plan

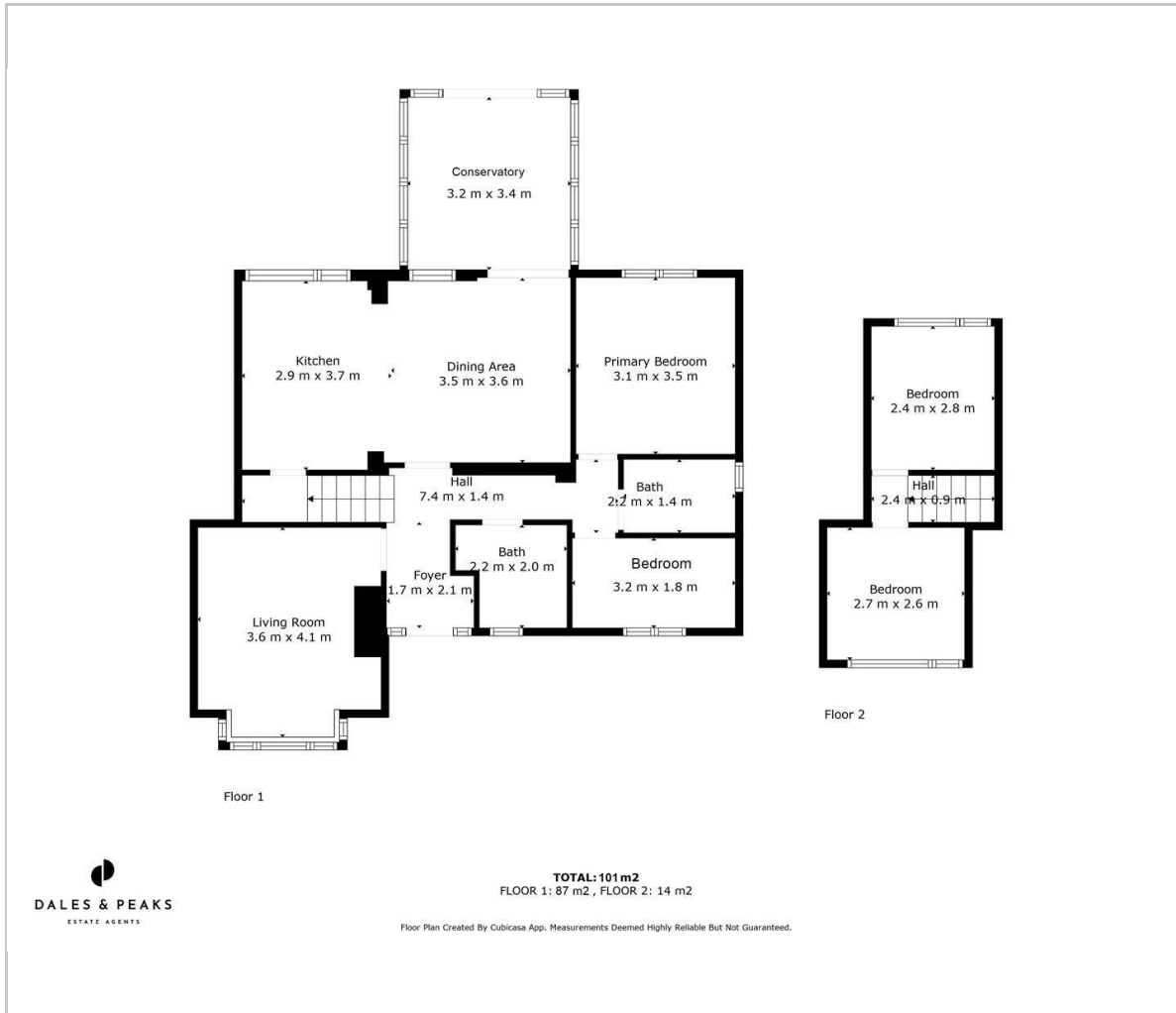

Viewing

Please contact our Chesterfield Office on 01246 567540 if you wish to arrange a viewing appointment for this property or require further information.

These particulars, whilst believed to be accurate are set out as a general outline only for guidance and do not constitute any part of an offer or contract. Intending purchasers should not rely on them as statements of representation of fact, but must satisfy themselves by inspection or otherwise as to their accuracy. No person in this firm's employment has the authority to make or give any representation or warranty in respect of the property.

Area Map

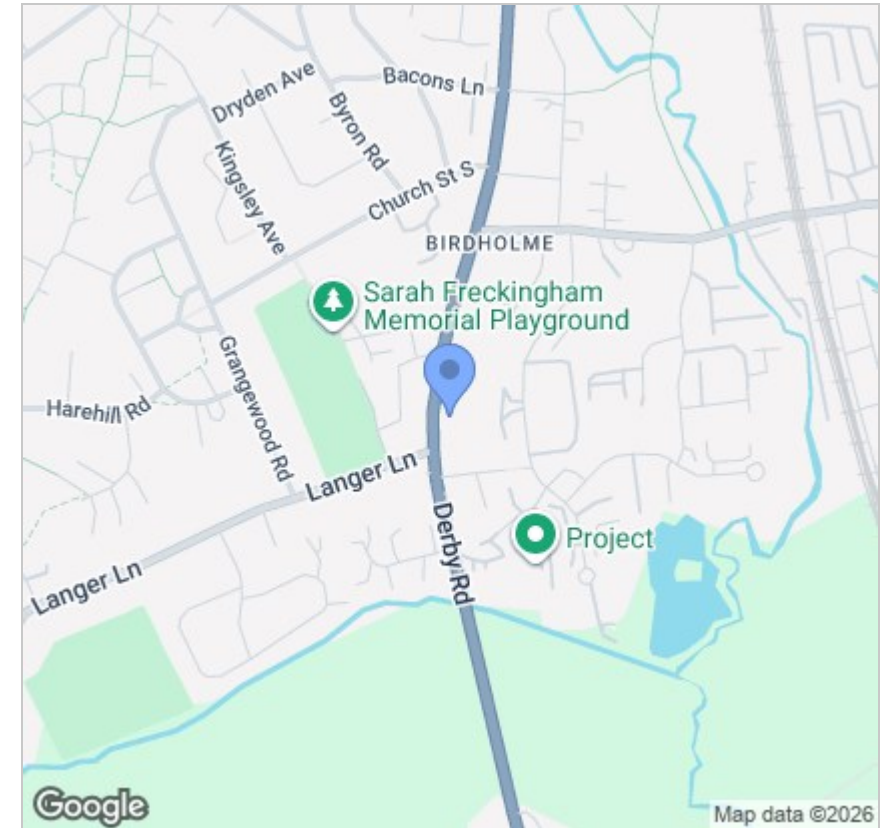

Energy Efficiency Graph

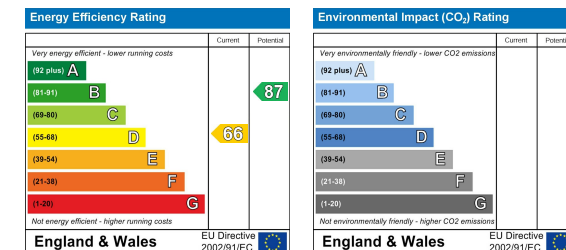

131 Chatsworth Road, Chesterfield, Derbyshire, S40 2AP
T: 01246 567540



E: info@dalesandpeaks.co.uk
www.dalesandpeaks.co.uk