

for sale

offers over **£200,000**



Lyde Road YEOVIL BA21 5PN

Well presented three bedroom family home which is located within 1/4 of a mile of schools and amenities. With kitchen/diner, downstairs wc, living room, three bedrooms, family bathroom and an enclosed rear garden. The perfect first home!

Lyde Road YEOVIL BA21 5PN

Entrance Porch

Entrance porch featuring a double-glazed front door providing a welcoming entryway, offering a bright and sheltered space before entering the main home.

Hallway

Hallway featuring an under-stair storage cupboard providing practical space, a radiator for warmth, and doors leading to the downstairs W/C, kitchen, and living room.

Cloakroom

Downstairs cloakroom featuring a double-glazed front window allowing natural light, fitted with a WC and wash hand basin for convenience.

Kitchen / Diner

Modern kitchen/diner installed less than a year ago, featuring a range of wall and base units with stylish marble-effect worktops, sink and drainer, and a useful storage larder. Includes an extractor fan and designated spaces for a low-level fridge freezer, oven, and washing machine. A double-glazed front window provides natural light to the space.

Dining area offering ample space for a dining table, creating a comfortable setting for family meals and entertaining.



Lounge

Lounge featuring a double-glazed rear window allowing plenty of natural light, a radiator for warmth, and a TV point. Double doors open through to the conservatory, enhancing the flow of living space.

Conservatory

Conservatory of brick and uPVC construction, featuring a radiator for year-round comfort and a double-glazed rear window overlooking the garden.

Landing

Landing providing access to the loft and featuring an airing cupboard offering additional storage space.

Bedroom One

Bedroom one featuring a double-glazed front window, radiator, and both a built-in double wardrobe and a built-in single wardrobe, providing excellent storage options.

Bedroom Two

Bedroom two featuring a double-glazed rear window, radiator, and a built-in double wardrobe offering generous storage space.

Bedroom Three

Bedroom three featuring a double-glazed rear window and a radiator, providing a bright and comfortable space.

Bathroom

Bathroom featuring a double-glazed front window, bath with shower over, WC, wash hand basin, tall radiator, and a mirrored unit providing both style and practicality.

Outside

Front Garden

Front garden featuring a shared pathway leading to the entrance and a neatly maintained lawned area.

Rear Garden

Rear garden, fence enclosed for privacy, with a gate to the rear providing access to a parking area operated on a first-come, first-served basis. The garden includes a lawned area and a patio, ideal for outdoor relaxation.

Outbuilding

Outbuilding of brick construction featuring a double-glazed front door and window, equipped with light and power, ideal for use as a workshop.





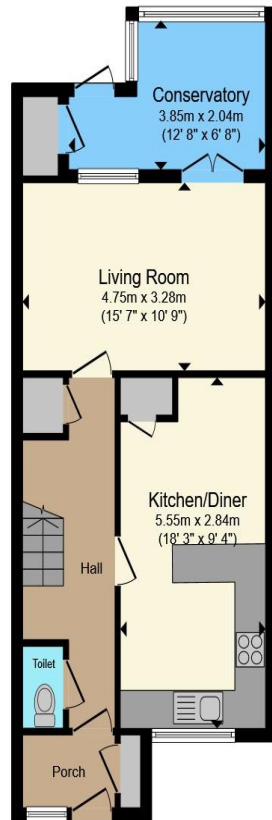

Ground Floor

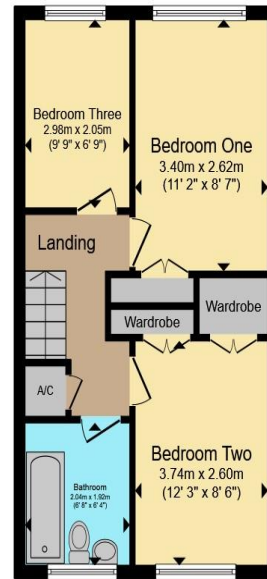

First Floor

Total floor area 94.3 m² (1,015 sq.ft.) approx

This floor plan is for illustrative purposes only. It is not drawn to scale. Any measurements, floor areas (including any total floor area), openings and orientation are approximate. No details are guaranteed, they cannot be relied upon for any purpose and they do not form part of any agreement. No liability is taken for any error, omission or misstatement. A party must rely upon its own inspection(s). Powered by www.propertybox.io



To view this property please contact Connells on

T 01935 431 129
E yeovil@connells.co.uk

1-3 Princes Street
 YEOVIL BA20 1EW

Property Ref: YOY314043 - 0002

Tenure:Freehold EPC Rating: C

Council Tax Band: B

view this property online connells.co.uk/Property/YOY314043

1. MONEY LAUNDERING REGULATIONS Intending purchasers will be asked to produce identification documentation at a later stage and we would ask for your co-operation in order that there will be no delay in agreeing the sale. 2. These particulars do not constitute part or all of an offer or contract. 3. The measurements indicated are supplied for guidance only and as such must be considered incorrect. Potential buyers are advised to recheck measurements before committing to any expense. 4. We have not tested any apparatus, equipment, fixtures, fittings or services and it is in the buyers interest to check the working condition of any appliances.

Connells Residential is registered in England and Wales under company number 1489613, Registered Office is Cumbria House, 16-20 Hockliffe Street, Leighton Buzzard, Bedfordshire, LU7 1GN. VAT Registration Number is 500 2481 05.

see all our properties at www.connells.co.uk | www.rightmove.co.uk | www.zoopla.co.uk