



TRENCHARD STREET, SE10

£900,000

Three double bedroom house
Two bathrooms
Spacious kitchen/diner
South facing courtyard garden
Conservation area
Energy rating: d

@marshandparsons
marshandparsons.co.uk

MARSH &
PARSONS

ABOUT THE PROPERTY

Asking Price - £900,000 to £925,000.

A beautifully refurbished Edwardian home in the heart of Greenwich. Meticulously restored, this period home pairs heritage detail with modern comfort.

Located in a conservation area, the house retains its beautiful original coloured glass windows, and sits just minutes from Greenwich Park, Maze Hill station, town centre and riverside pubs.







FURTHER DETAILS

The elegant living room features a stunning tiled fireplace, while the bespoke kitchen/diner has a cast-iron fireplace, quartz worktops, larder storage and boiling-water tap. French doors open to a sunny, south facing courtyard garden complete with an electric awning, irrigation, lighting, and a brick store.

On the top two floors are three double bedrooms with fireplaces and quality carpeting, two stylish fully-tiled bathrooms with high-spec smart toilets, utility cupboard, and a boarded loft. Additional premium finishes include restored ornate plasterwork, column radiators, bespoke plantation shutters, USB sockets, oak herringbone floors, water softener, and farrow & ball paint.



STEP INSIDE TRENCHARD STREET

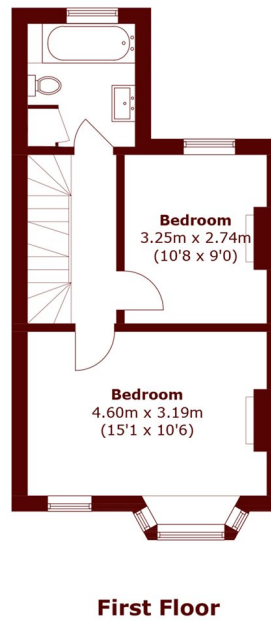
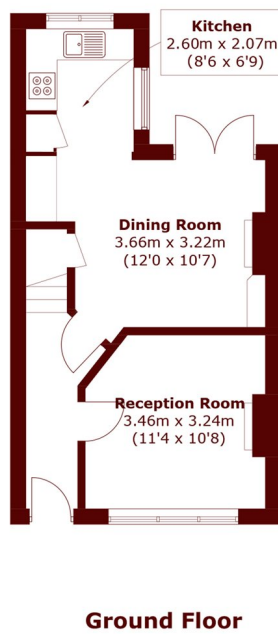

Total area (approx.): 92.3 sq. m (993.4 sq. ft)
(Excluding Eaves)
External Storage (approx.): 1.0 sq. m (10.7 sq. ft)

Greenwich
020 8312 8312

Energy Rating: We aim to make our particulars both accurate and reliable. However, they are not guaranteed; nor do they form part of an offer or contract. If you require clarification on any points then please contact us, especially if you're traveling some distance to view. Please note that appliances and heating systems have not been tested and therefore no warranties can be given as to their good working order

MARSH &
PARSONS