



Beechwood Road, Hillsborough, Sheffield, S6 4LN

Offers In Region Of £150,000

1 1 1



Why You'll Love It

Set back from Beechwood Road, this charming detached home immediately feels private and peaceful – a rare find for such a central S6 location. A front garden area welcomes you in, offering a pleasant spot for a morning coffee or a touch of greenery to personalise.

Step through the entrance hallway and you'll appreciate the thoughtful layout. To the left sits a modern bathroom, recently updated by the current owner with clean, contemporary finishes. To the right, the double bedroom provides a calm and cosy retreat, well-proportioned and ready to move straight into.

Stairs rise to the first floor, where the property really comes into its own. The upside-down design creates a bright and sociable living space, with a comfortable lounge and dining area that feels airy and inviting. There's ample room to relax, entertain, or work from home, all enhanced by the elevated position.

The kitchen is a great size for a one-bedroom home – stylish, practical, and recently improved. With plenty of storage and workspace, it's ideal for everyday cooking as well as hosting friends. Throughout the property, the current owner has carried out a programme of updates, meaning it's ready for its next chapter without the need for immediate work.

Quirky, detached, and beautifully presented, this is a home that stands out from the crowd – perfect for those wanting something with personality.

Why We Love It

Hillsborough remains one of Sheffield's most popular districts, and it's easy to see why. Just a short stroll away you'll find the shops, cafés and amenities of Hillsborough Centre, along with excellent transport links including the Supertram for easy access to the city centre and beyond.

Green space is in abundance, with Hillsborough Park close by – perfect for weekend walks, park runs, and summer events. For those



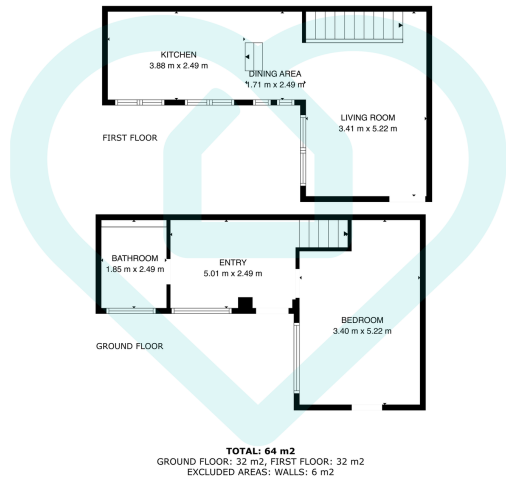

This floor plan is for illustrative purposes only. All measurements and layouts are approximations and do not necessarily capture the precise specifications of the property. No responsibility is taken for any error, omission, or misstatement. We always recommend viewing in person to confirm the exact floor plan of a property. Made with Metropix.



- No Chain
- Tucked Away In The Heart of Hillsborough
- Well Presented Throughout As Recently Refurbished
- Close To Shops, Pubs and Cafe's
- On Street Parking
- Detached One Bedroom Home
- Perfect For First Time Buyers
- Well Proportioned Throughout
- Great Transport Links In The City and Surrounding Areas
- Enclosed Garden Area



Score	Energy rating	Current	Potential
92+	A		
81-91	B		83 B
69-80	C	77 C	
55-68	D		
39-54	E		
21-38	F		
1-20	G		

Sales | Lettings | New Homes

VAT Reg Number: 191 3588 84
 Company Reg Number: 08610489
 Company Reg Address: 67 Middlewood Road, Hillsborough, Sheffield, S6 4GX.

The MorfittSmith Building
 67 Middlewood Road
 Hillsborough
 Sheffield
 S6 4GX

Get in touch - arrange an appointment

- 0114 232 1764
- sales@morfittsmith.co.uk
- lettings@morfittsmith.co.uk
- newhomes@morfittsmith.co.uk
- www.morfittsmith.co.uk

- @MorfittSmith
- @MorfittSmith
- MorfittSmith Estate & Letting Agent