



Walkers
People & Property

Penny Royal Road, Danbury. CM3 4ED
Guide Price £1,100,000 - £1,200,000



Purleigh Penny Royal Road

Danbury, CM3 4ED

Set within the charming surroundings of Danbury, this beautiful detached bungalow offers exceptional space, versatility, and a wonderful sense of privacy with views over protected national trust countryside.

The home opens into a spacious hallway leading to a welcoming lounge complete with a cosy log burner that flows seamlessly into a separate dining room. At the heart of the property lies an open-plan kitchen, dining and living space, thoughtfully designed for both everyday family life and entertaining, with doors opening directly onto the picturesque rear garden.

The accommodation continues via an inner hallway leading to four well-proportioned double bedrooms, two of which benefit from their own ensuite facilities, alongside a family bathroom. The layout offers flexibility for growing families or those seeking additional guest or workspace. The property also includes a separate utility room and WC, adding to the home's practicality.

Externally, the property truly excels. The rear garden is a standout feature, offering a tranquil and private retreat with mature trees and hedging framing the space. A combination of patio areas, a lush lawn, and a charming summer house creates an ideal setting for relaxation and outdoor entertaining. To the front, the property continues to impress with a large lawn, countryside views, and an in-and-out driveway providing extensive parking, complemented by a detached double garage.

The location is equally appealing, positioned just a short stroll from Danbury Village centre, where a range of local amenities can be found. Excellent transport links are nearby, including a bus stop within walking distance and convenient access to Chelmsford City centre and the A12. The area is well known for its highly regarded schools, including both public and private options, with Chelmsford's sought-after grammar schools also within easy reach.

this is a rare opportunity to acquire a substantial bungalow in such a sought-after village setting, offered to the market with no onward chain for a smooth and swift purchase. Homes of this calibre, combining generous space, privacy, and a prime location, are seldom available and rarely remain on the market for long, early viewing is highly recommended.

Penny Royal Road

Danbury, CM3 4ED

Council Tax band: F

Tenure: Freehold

EPC Energy Efficiency Rating: TBC

EPC Environmental Impact Rating: TBC

- Generous 0.35 acre plot (stls) with beautifully established gardens
- Spacious open-plan kitchen, dining and living area
- Four double bedrooms with two ensembles and additional family bathroom
- Impressive in-and-out driveway with ample parking and detached double garage
- Peaceful village setting within walking distance of amenities





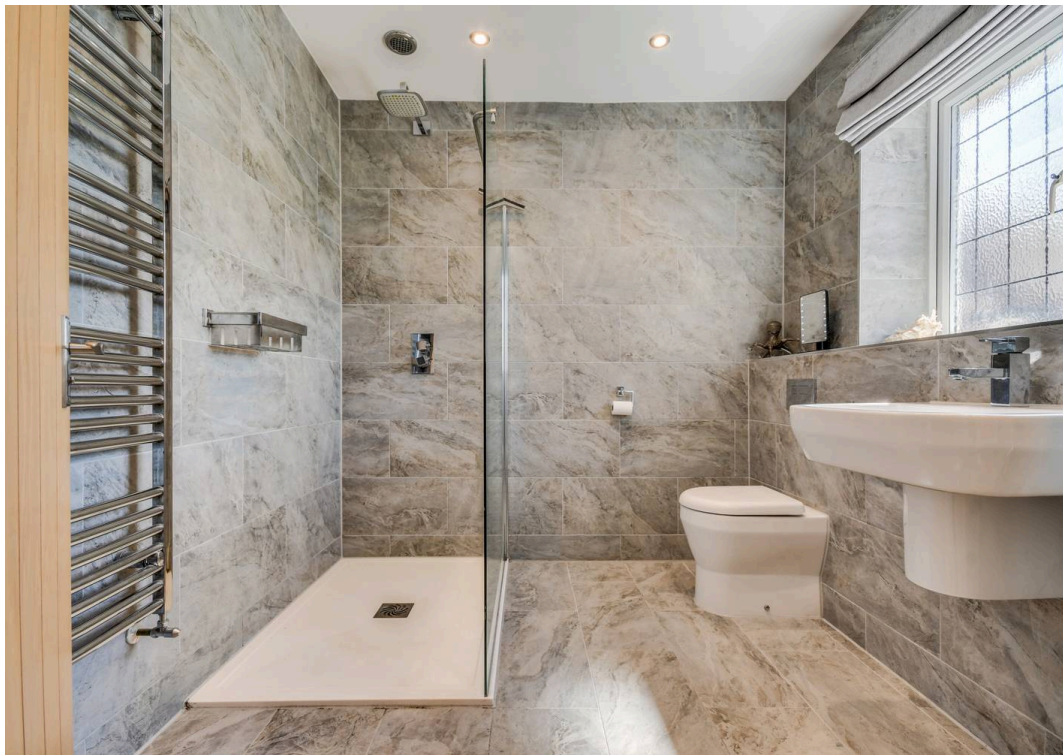





APPROX INTERNAL FLOOR AREA
MAIN HOUSE 183 SQ M 1970 SQ FT
OUTBUILDINGS 46 SQ M 490 SQ FT
TOTAL 229 SQ M 2460 SQ FT

This plan is for layout guidance only and is
NOT TO SCALE
Whilst every care is taken in the preparation of
this plan, please check all dimensions, shapes &
compass bearings before making any decisions
reliant upon them.
Copyright Walkers

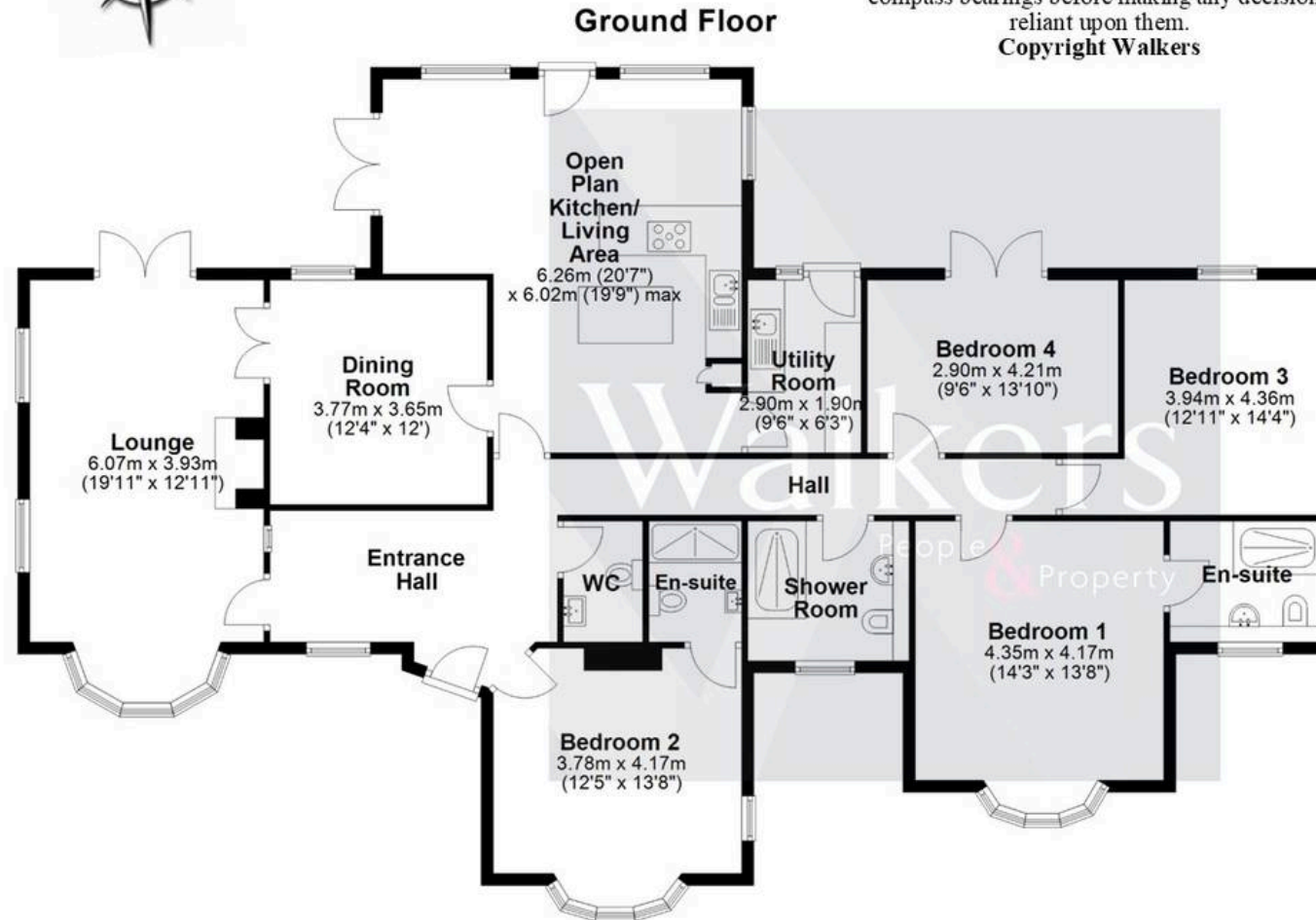

Garden Room

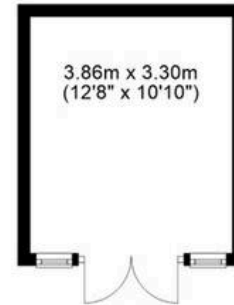

Double Garage

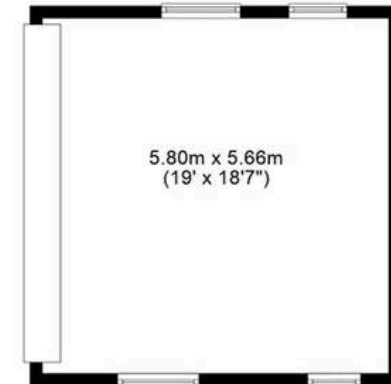

Psst... Have you heard of

Walkers discreet marketing?

Many people lose out on their dream home to someone in a better position.

Often, it is because they have delayed putting their house on the market, preferring to find somewhere first and then sell,

That is why we have innovated a totally unique and highly confidential moving home solution to put you in a competitive position.

Let us find you a buyer *without any advertising or pressure* and without the neighbours knowing.

Your secret is safe with us....

Get in touch for a complimentary valuation.

Looking To Sell Or Let Your Home?

Book your free valuation to see how much your home is worth.

Contact Us
01277 355005



Our Website

www.walkersstates.co.uk



Our Address

90 High Street
Ingatstone
CM4 9DW



www.walkersstates.co.uk

About Us

Walkers | People & Property is built on a lifelong family passion for homes. Martin, Gillian and Adam Walker lead a respected, professional team who live and breathe all aspects of property. With over 30 years of experience, we understand the moving process on a personal level and are committed to delivering exceptional results. Most of all, helping people move is our hobby, and handing over the keys to excited buyers remains our favourite moment.

Get In Touch

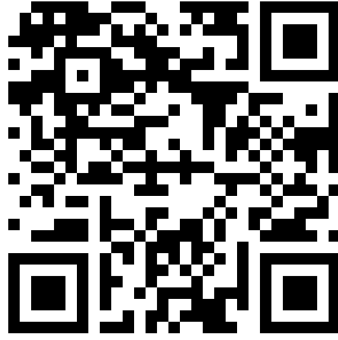

Browse Properties

