



17 Erlestoke Avenue, Didcot, OX11 9FY

£1,400 PCM - Availability Date TBC

- Two Bedroom Ground Floor Apartment
- Two Allocated Parking Spaces
- Open Plan Kitchen/Sitting Room
- EPC Rating B
- Gas Central Heating
- Council Tax Band C.

17 Erlestoke Avenue, Didcot OX11 9FY

Ground floor two bedroom apartment located on Nobel Park development. Comprising of open plan kitchen/sitting room with halogen hob, fridge/freezer, dishwasher, oven and microwave combination oven, two double bedrooms with fitted wardrobes, ensuite shower to bedroom one. Bathroom. Laundry cupboard with washing machine and tumble dryer. Gas central heating. Two allocated parking spaces. Bin store and cycle store.



Council Tax Band: C



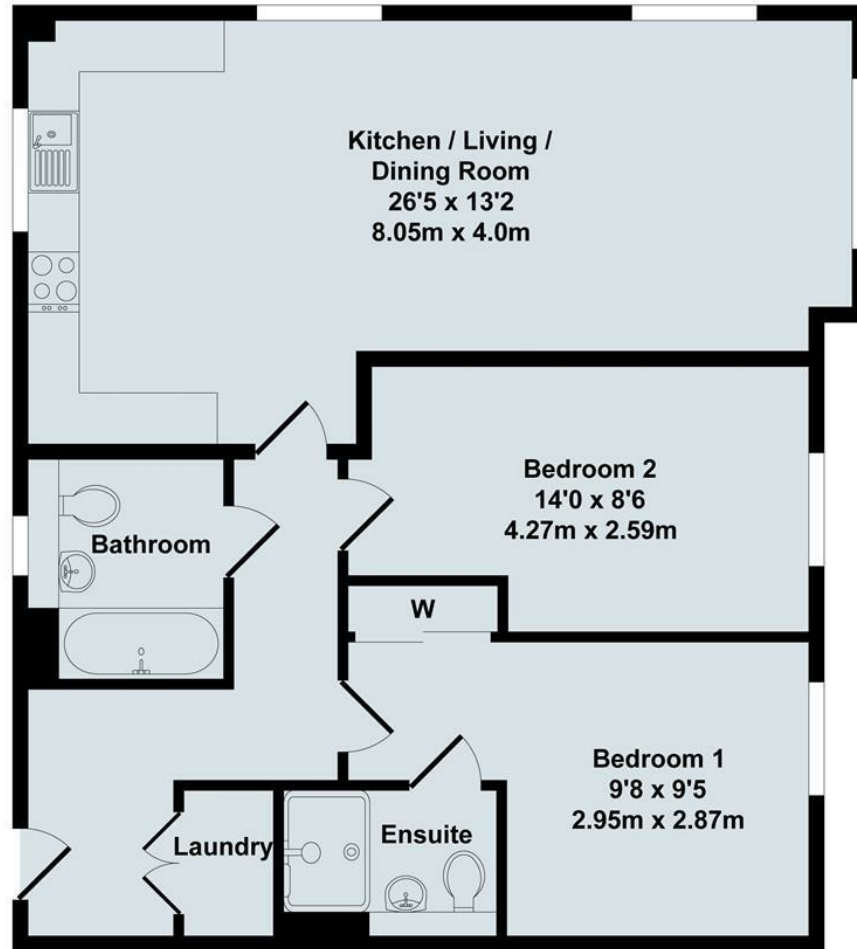

Total Approx. Floor Area 747 Sq.Ft. (69.40 Sq.M.)

All items illustrated on this plan are included in the "Total Approx Floor Area"

Energy Efficiency Rating

| | Current | Potential |
|---|----------------------------|---|
| Very energy efficient - lower running costs | | |
| (92 plus) A | | |
| (81-91) B | 84 | 84 |
| (69-80) C | | |
| (55-68) D | | |
| (39-54) E | | |
| (21-38) F | | |
| (1-20) G | | |
| Not energy efficient - higher running costs | | |
| England & Wales | EU Directive 2002/91/EC |  |

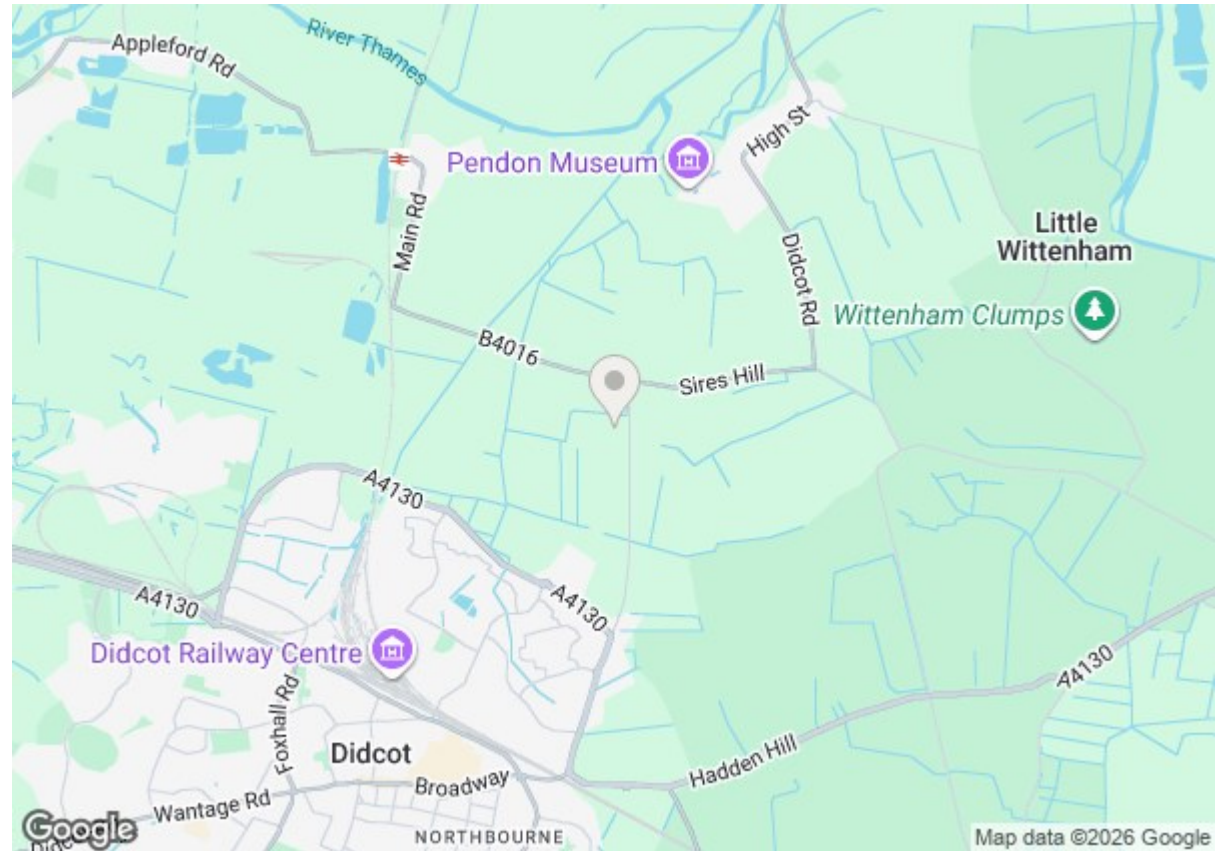

Directions

Viewings

Viewings by arrangement only. Call 01235 514267 to make an appointment.

Council Tax Band

C