



Lambert & Foster



COLTS HILL FARMHOUSE

COLTS HILL | FIVE OAK GREEN | KENT | TN12 6SN

Colts Hill Farmhouse enjoys an attractive semi-rural position surrounded by 1.27 acres of beautifully landscaped gardens. This property presents a rare opportunity to acquire a stunning Grade II Listed home, thoughtfully renovated to a wonderful specification throughout, benefiting from an abundance of character and charm. The property comprises four great-sized bedrooms, three bathrooms, a grand reception hallway, two additional reception rooms, utility room and a bespoke country style kitchen/breakfast room. Approached via a long gated driveway forms an attractive approach. The grounds further benefit from a detached double garage, Victorian-style green house, superb paved terrace and a newly built outdoor kitchen that is fully equipped including an open fire. The popular village of Matfield is close by with its traditional village green, public houses and butcher. Paddock Wood, Tonbridge and Tunbridge Wells all offer more comprehensive amenities that include mainline stations into London.

Guide Price £1,395,000 - £1,495,000

FREEHOLD





COLTS HILL FARMHOUSE

COLTS HILL, FIVE OAK GREEN, TONBRIDGE, KENT, TN12 6SN

- Beautiful Grade II listed farmhouse in a semi-rural location
- Attractive 1.27 acre plot of landscaped gardens
- Gated driveway with a long driveway and double garage
- Fully equipped outdoor kitchen and Victorian green house
- Excellent choice of schools in the area including Kent grammar schools
- Ideally located close to both Paddock Wood and Tonbridge mainline stations with links under 45 minutes into London

VIEWING: By appointment only.

Paddock Wood Office: 01892 832325.

WHAT3WORDS: ///approvals.taken.grounding

TENURE: Freehold

SERVICES & UTILITIES:

Electricity supply: Mains **Water supply:** Mains

Sewerage: Private Sewerage **Heating:** Oil and Log Burners

BROADBAND: Standard and Superfast available

MOBILE COVERAGE: Good outdoor

(Visit <https://checker.ofcom.org.uk/en-gb/broadband-coverage> or enquire with the office for more information).

LOCAL AUTHORITY: Tunbridge Wells

COUNCIL TAX: Band G **EPC:** N/A Grade II Listed

COVENANTS: None known

FLOOD & EROSION RISK: **Property flood history:** None

Rivers and the sea: Very Low **Surface Water:** Very Low

Reservoirs: Unlikely **Groundwater:** Unlikely

(Visit flood-map-for-planning.service.gov.uk or enquire with the office for more information).

PHYSICAL CHARACTERISTICS: Brick built under tiled roof with tiles hung to first floor elevation



PARTICULARS, PLANS AND SCHEDULES: The particulars and acreages stated, together with the plans are believed but not guaranteed to be correct. They are given by the Agents to assist viewers but are specifically excluded from any contract. Prospective purchasers must satisfy themselves as to the information enclosed.

IMPORTANT NOTICE: Lambert & Foster themselves and the vendors and/or lessors of this property whose agents they are, give notice that: The particulars are set out as a general outline only for guidance and do not constitute part of an offer or contract. All descriptions, dimensions, references to condition and necessary permissions for the use and occupation and other details are given in good faith and are believed to be correct. Any intending purchasers/lessees should not rely on them as statements or presentations of fact but satisfy themselves by inspection or otherwise as to the correctness of each of them. If there are any points which are of particular importance to you, please contact the office and we will be pleased to check the information, particularly if you are travelling some distance to view the property.

In accordance with the Digital Market, Competition and Consumers (DMCC) Act 2024, we must advise that we have not tested any of the main services, various electrical or gas appliances and fixtures which may be referred to in these sales particulars. Any prospective purchasers are strongly advised to satisfy themselves that such are in working order. No person in the employment of the Agents has any authority to make or give any representations or warranty whatever in relation to this property.

MONEY LAUNDERING REGULATION: In accordance with Money Laundering Regulations, we are now required to obtain proof of identification for all vendors and purchasers. You will need to supply information required for us to complete our identification checks which will include your date of birth, main residential address and a colour copy of your passport or photo driving licence. Lambert & Foster apologise for any inconvenience this may cause, but it is a legal requirement. Lambert & Foster will not be able to conclude a sale on your behalf to any person or people who are unable to provide confirmation of identification. Note: Lambert & Foster currently employs the services of Smartsearch to verify the identity and address of vendors/purchasers.

For identification purposes only. The position and size of doors, windows, appliances and other features are approximate only.

Colts Hill Farmhouse, Colts Hill, Five Oak Green, Tonbridge, TN12 6SN



Approximate Area = 2529 sq ft / 234.9 sq m
 Garage = 366 sq ft / 34 sq m
 Outbuildings = 659 sq ft / 61.2 sq m
 Total = 3554 sq ft / 330.1 sq m

For identification only - Not to scale

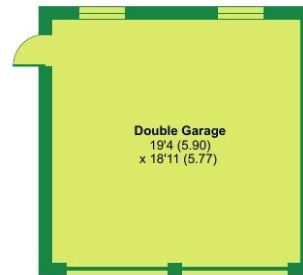
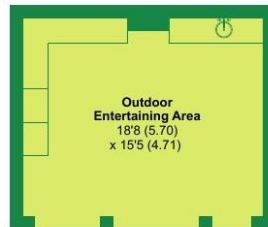
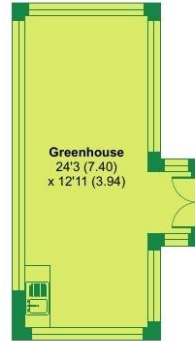

Floor plan produced in accordance with RICS Property Measurement 2nd Edition, Incorporating International Property Measurement Standards (IPMS2 Residential). © nctecom 2026. Produced for Lambert and Foster Ltd. REF: 1459971

OFFICES LOCATED AT:

PADDOCK WOOD, KENT
 Tel. 01892 832 325
 77 Commercial Road,
 Paddock Wood, Kent TN12 6DS

WADHURST, EAST SUSSEX
 Tel. 01435 873 999
 Helix House, High Street
 Wadhurst, East Sussex TN5 6AA

HYTHE, KENT
 Tel. 01303 814 444
 Hillhurst Farm, Stone St,
 Westenhanger, Hythe CT21 4HU

CRANBROOK, KENT
 Tel. 01580 712 888
 Weald Office, 39 High Street
 Cranbrook, Kent TN17 3DN

PROPERTY PROFESSIONALS FOR 125 YEARS

