

Boardwalk

Heyford Avenue , BRISTOL

Heyford Avenue EASTVILLE

APPROXIMATE FLOOR AREA
144.6 SQM / 1556 SQFT



GROUND FLOOR

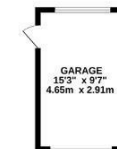

FIRST FLOOR

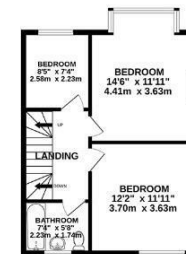

SECOND FLOOR

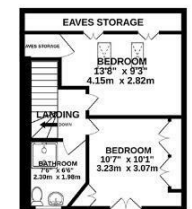

Illustrations are for reference purposes only, measurements are approximate, not to scale.

Boardwalk

Heyford Avenue , BRISTOL

£

£600,000



BS5 6UE

zzz

5 Bedrooms



3 Bathrooms



It is so lovely to leave the house and walk straight on to Purdown, with the children and dogs. In the summer with a picnic and a football. The garden is our favourite space, having dinner on the decking most (dry) evenings in the summer and bbqs on the weekend with friends and family.

