



Bluewater House  
Smugglers Way, SW18

CHESTERTONS





This bright and spacious penthouse apartment is situated within the popular Riverside West development, offering contemporary living with exceptional natural light and attractive river views. Finished in a neutral palette throughout, the property features a combination of wood and tiled flooring, contemporary fittings and floor-to-ceiling windows and doors opening onto a generous wraparound balcony.

The accommodation comprises a spacious reception room with ample space for both relaxing and dining, alongside a sleek, fully fitted modern kitchen. The principal bedroom benefits from built-in wardrobes, an en-suite shower room and access to a private balcony. There is a further well-proportioned double bedroom and a stylish family bathroom.

Residents of Riverside West enjoy secure video entry, a concierge service, lift access and well-maintained communal gardens and common areas. Ideally located, the development is within a short walk of Wandsworth Town mainline station and offers easy access to the shops, restaurants and leisure facilities of the Tonsleys, Fulham, Chelsea and the King's Road.

- Penthouse apartment
- Floor-to-ceiling windows with river views
- Wraparound balcony
- Concierge service, lift and secure video entry
- Short walk to Wandsworth Town station

Asking Price £550,000

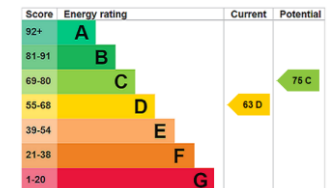

**Tenure:** Leasehold 974 years remaining  
**Service Charge:** £4800 per annum  
**Ground Rent:** £350 per annum  
**Local Authority:** London Borough of Wandsworth  
**Council Tax Band:** F

*Chestertons Wandsworth Sales*

47 East Hill  
 London  
 SW18 2QE

wandsworth@chestertons.co.uk

0208 104 7530

chestertons.co.uk

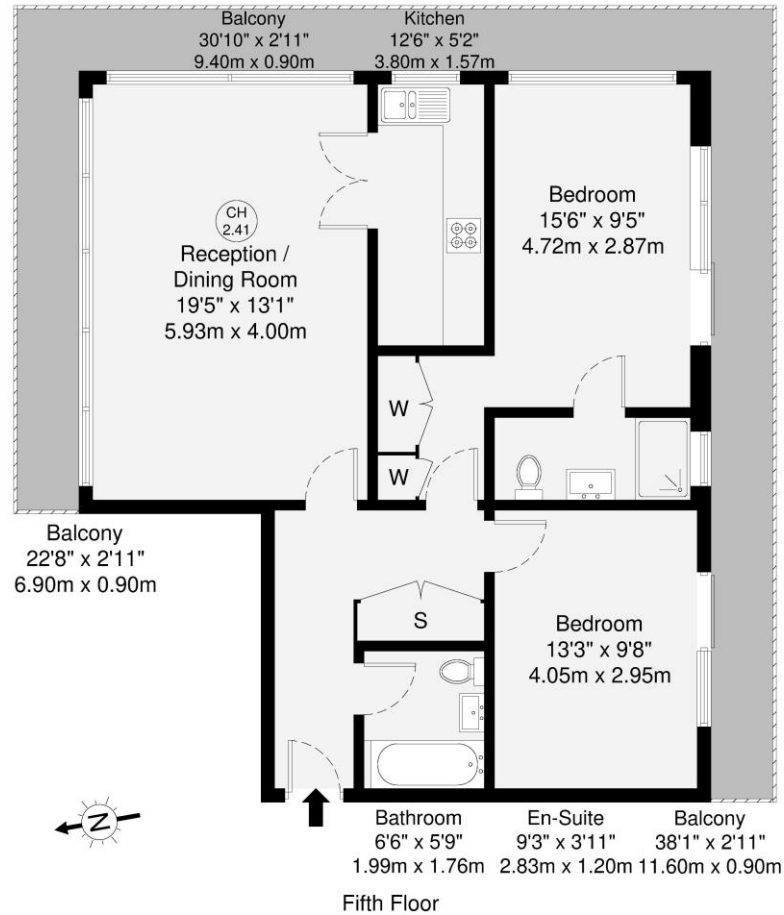

GROSS INTERNAL AREA (GIA)  
The footprint of the property  
78.5 sq m / 844 sq ft

TOTAL STORAGE SPACE  
Storage and wardrobe total area  
2.2 sq m / 23 sq ft

EXTERNAL FEATURES  
Garden, Balcony, Terrace, Verandah etc.  
25.1 sq m / 270 sq ft

RESTRICTED HEAD HEIGHT  
Limited use area under 1.5m  
0.0 sq m / 0.0 sq ft

Disclaimer: Floorplan measurements are approximate and are for illustrative purposes only. While we do not doubt the floorplan accuracy and completeness, you or your advisors should conduct a careful, independent investigation of the property in respect of monetary valuation.

Maison  
VUE

