



Hambalt Road, SW4

£1,595,000

Dexters



Hambalt Road, SW4

Offers in excess of A wonderful freehold home situated on one of the Abbeville Village's most desirable roads. Providing an abundance of naturally bright accommodation over three floors with a south-west facing garden.

The double reception room is located to the left of the entrance hall and features a bay window, bespoke cabinetry, a striking feature fireplace, and ornate ceiling plasterwork.

To the rear of the house, a superbly sized and well-equipped kitchen provides an ideal space for both everyday living and entertaining. French doors open onto a charming garden, seamlessly blending indoor and outdoor living.

The upper floors offer five double bedrooms and two bathrooms, including the principal bedroom in its traditional position.

Hambalt Road is a tree-lined street renowned for its proximity to the many local shops, restaurants and cafés of Abbeville Village, with Clapham South & Common stations just a short stroll away.

Features

- Freehold Home
- Double Reception Room
- Extended Kitchen
- Five Bedrooms
- Two Bathroom
- Garden







Hambalt Road, London, SW4

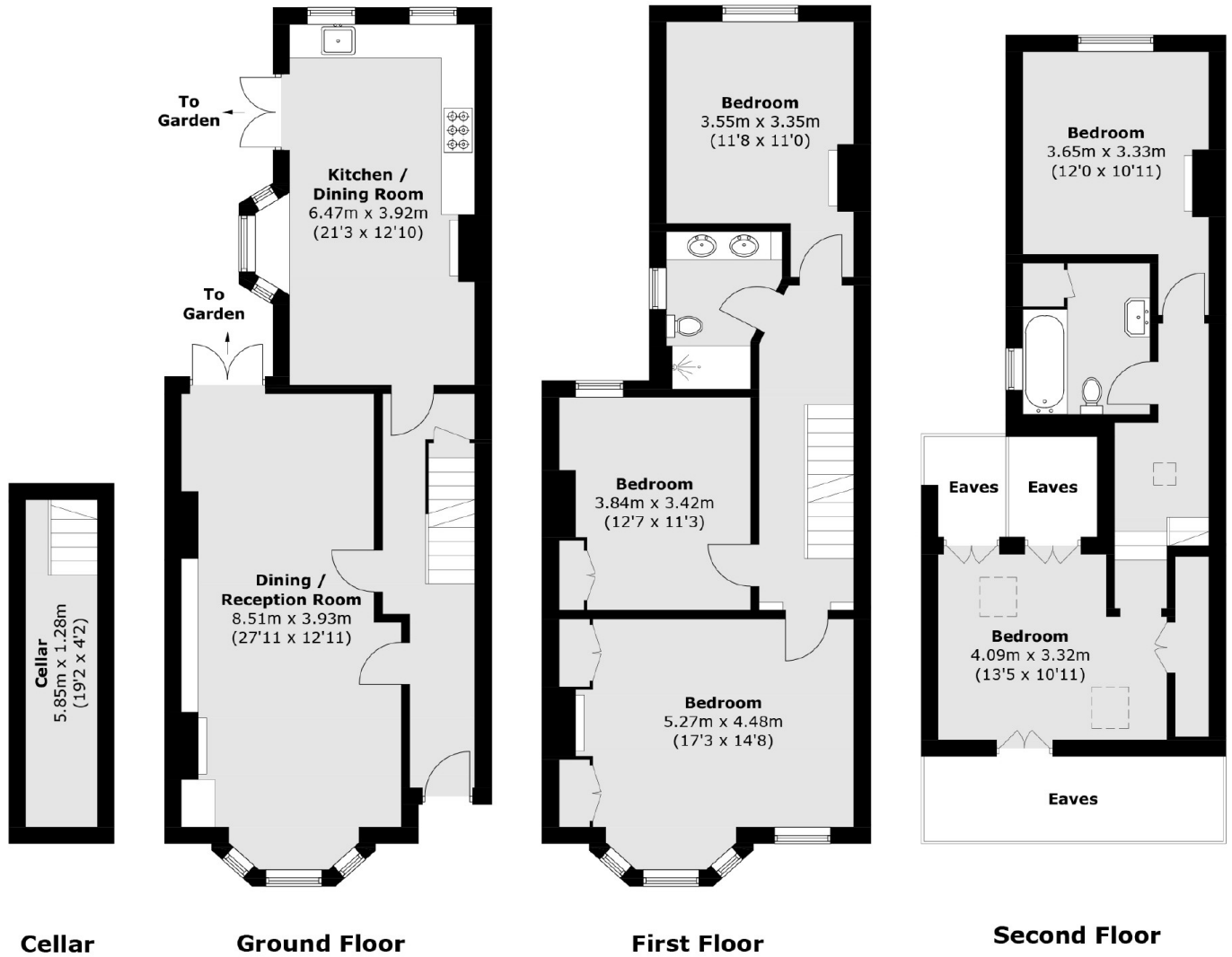

Total area (approx.): 178.8 sq. m (1,924.6 sq. ft)
(Excluding Eaves / Including Cellar)