



Snowdrop Way

Wootton Fields, Northampton

oriordanbond
SALES & LETTINGS



GROUND FLOOR
614 sq.ft. (57.0 sq.m.) approx.

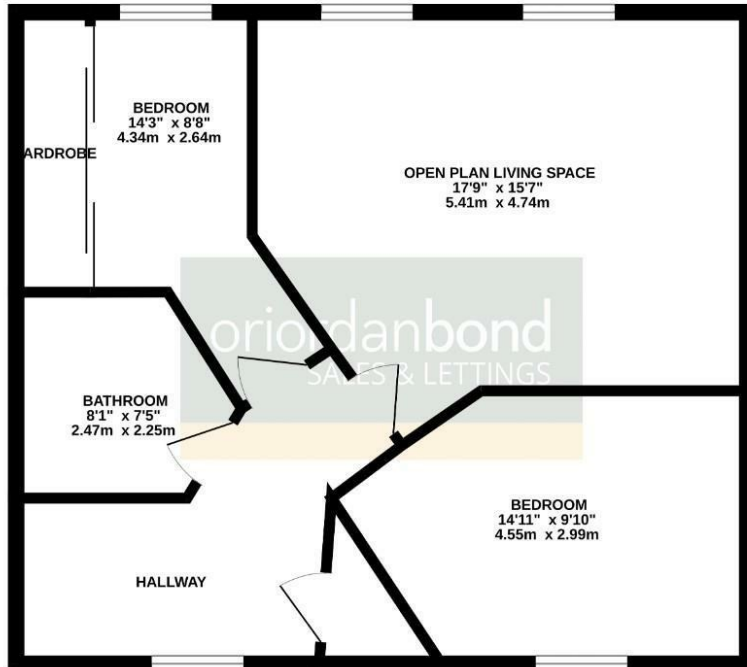

TOTAL FLOOR AREA : 614 sq ft. (57.0 sq.m.) approx.
Whilst every attempt has been made to ensure the accuracy of the floorplan contained here, measurements of doors, windows, rooms and any other items are approximate and no responsibility is taken for any error, omission or misstatement. This plan is for illustrative purposes only and should be used as such by any prospective purchaser. The services, systems and appliances shown have not been tested and no guarantee as to their operability or efficiency can be given.
Made with AutoCAD 2020

Snowdrop Way

Wootton Fields

NN4 6FW

PRICE £195,000

This superbly presented two double bedroom ground floor apartment is located within the popular St. Georges Fields development within sought after Wootton Fields. The apartment is within close proximity of shops, schools and other amenities as well as having easy access to Junction 15 for the M1 and A45.

At only five years old, the accommodation comprises entrance hall, large open plan kitchen/living space, two double bedrooms and a bathroom suite. Externally, there are parking spaces for two cars. Further benefits include gas radiator heating and uPVC double glazing. (A/614/-)

Leasehold Information: Lease Remaining - 994 years (as of 2026) / Ground Rent - included in service charge / Service Charge - £1272 per annum

Additional information

- Council Tax Band: C
- Energy Efficiency Rating: B

Viewing

Viewing strictly by appointment – details below

Disclaimer

O'Riordan Bond Estate Agents Limited has not tested apparatus, equipment, fittings or services and so cannot verify they are in working order. The buyer is advised to obtain verification from their solicitor or surveyor.

O'Riordan Bond Grange Park Sales
01604 432007

grangepark@oriordanbond.co.uk

