

24a Regency  
Square  
Brighton  
BN1 2FH



CALLAWAYS  
RESIDENTIAL  
SALES & LETTINGS

# 24a Regency Square

£325,000



Contact  
01273-735237  
enquiries@callaways.co.uk  
www.wilburyresidential.co.uk

Local Authority  
Brighton & Hove

Council Tax Band B

EPC Rating

## Regency Square

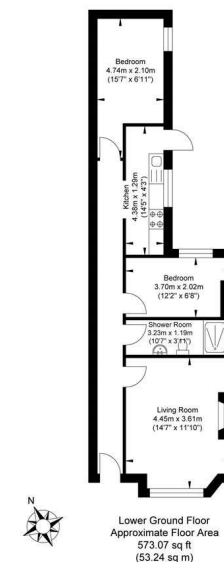

Approximate Gross Internal Area = 53.24 sq m / 573.07 sq ft  
Illustration for identification purposes only, measurements are approximate, not to scale.