

Whilst every attempt has been made to ensure the accuracy of the floor plan and details contained here, measurements of doors, windows, rooms and any other items are approximate and no responsibility is taken for any error, omission, or mis-statement. This plan is for illustrative purposes only and should be used as such by any prospective purchaser. The services, systems and appliances shown have not been tested and have no guarantee as to their operability or efficiency can be given. Floor plan made with Metropix 2014. Fixtures and fittings may vary at point of sale.

www.chrisgeorgeestategent.co.uk

Tel: 01536 524475

Corby
1A SPENCER COURT
CORBY
NORTHAMPTONSHIRE
NN17 1BH

Thrapston
22 HIGH STREET
THRAPSTON
NORTHAMPTONSHIRE
NN14 4JH

Rothwell
30 HIGH STREET
ROTHWELL
NORTHAMPTONSHIRE
NN14 6BQ

Kettering
12B HORSEMARKET
KETTERING
NORTHAMPTONSHIRE
NN16 0DQ

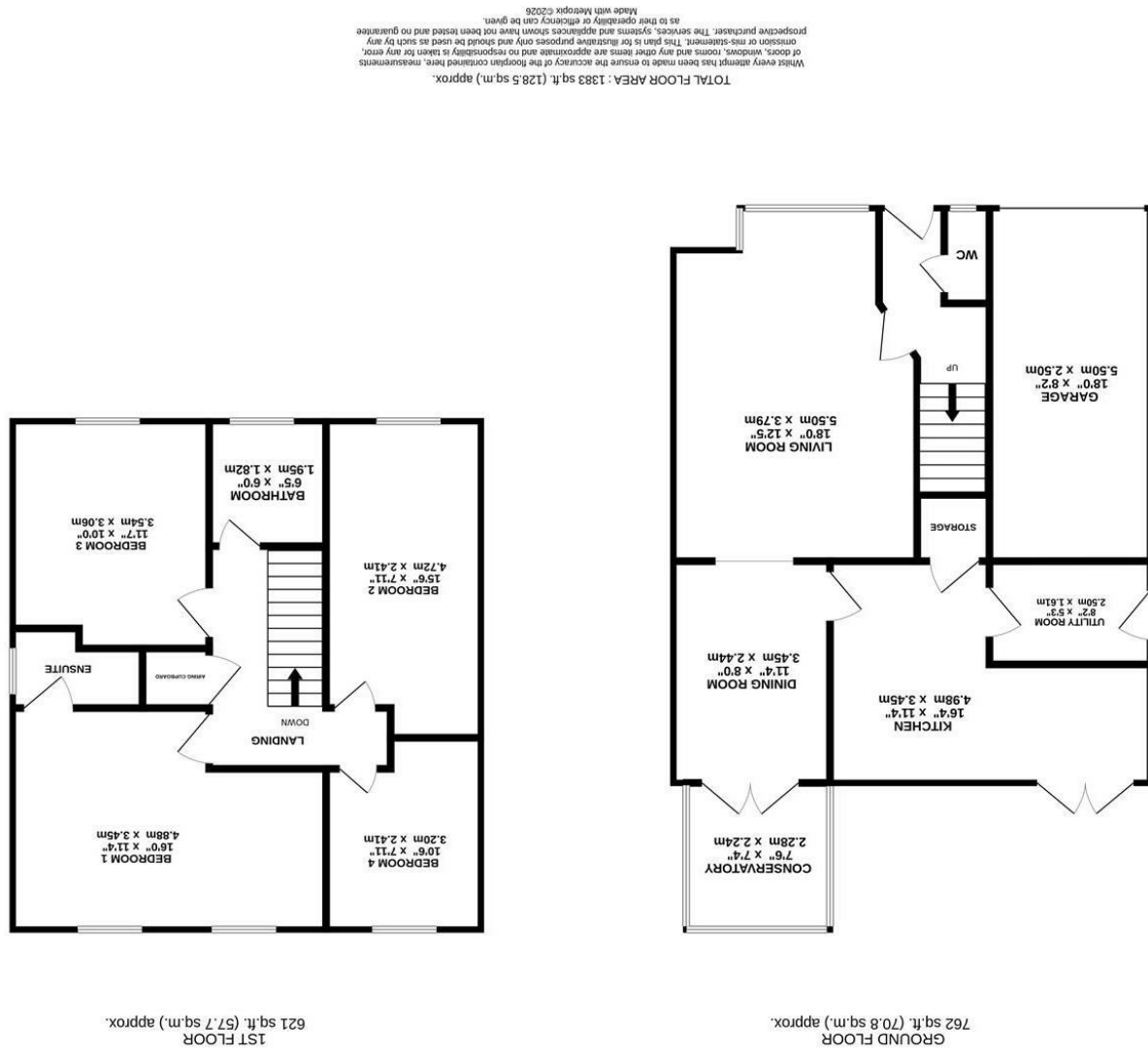

12 Tentsmuir Close, Kettering, NN16 9FR
£325,000



Offered to the market is this four-bedroom detached family home, ideally situated to the north of Kettering within the sought-after Caitlands development. The property offers generous living accommodation, including two reception rooms, a bright conservatory, a kitchen with adjoining utility room, and a convenient guest WC. Upstairs, there are four bedrooms, including a spacious master with en-suite, alongside a modern family bathroom.

Externally, the home benefits from a driveway providing off-road parking and access to an integral garage. The front garden is mainly laid to lawn, while the rear garden is beautifully maintained, featuring a spacious patio area and well-stocked flower beds.

Internally, the property is entered via a welcoming entrance hall with access to the guest WC, living room, and stairs rising to the first floor. The generous bay-fronted living room features a fireplace and flows seamlessly into a formal dining room, which in turn provides access to both the kitchen and conservatory. The kitchen overlooks the rear garden and offers a range of wall and base units with work surfaces over, ample space for appliances, and useful under-stairs storage. The adjoining utility room adds further practicality. Upstairs, the first-floor landing leads to all four bedrooms and the family bathroom. Three of the bedrooms are comfortable doubles, with the particularly spacious master bedroom benefiting from an en-suite shower room and dual windows that fill the space with natural light.

