

# Butler's

thoughtful estate agency



Henley Avenue, Sutton, SM3 9SG  
Guide price £700,000

## Floor Plan

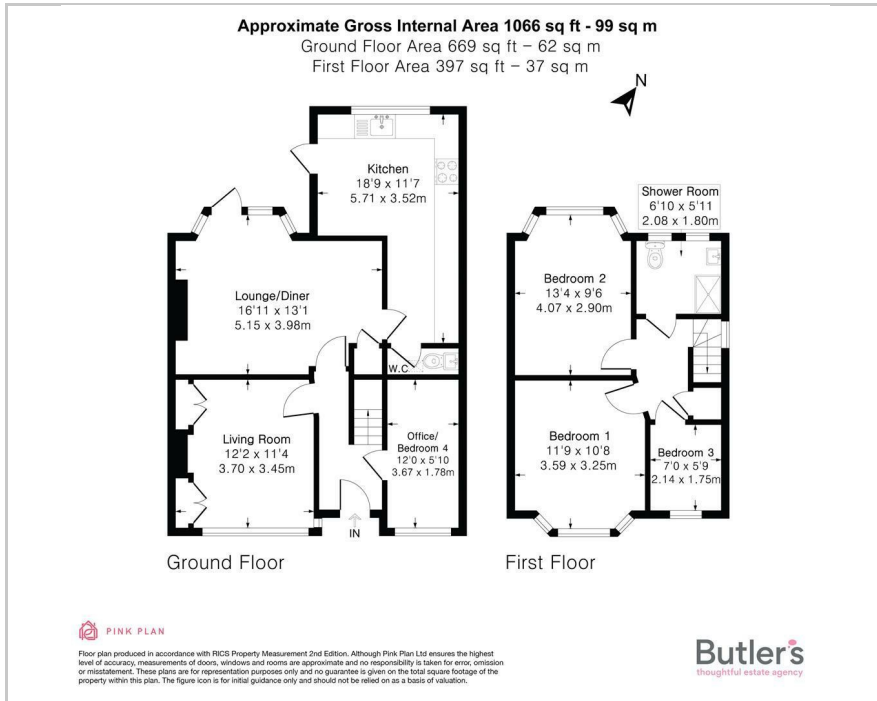

## Area Map

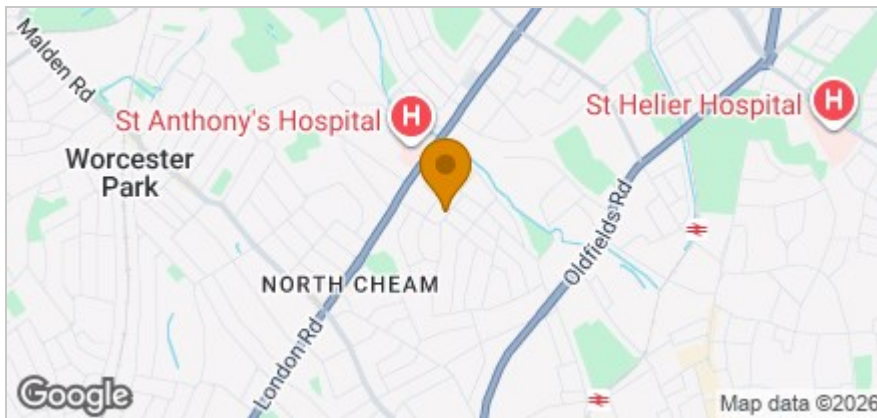

## Accommodation

- Extended 4 bedroom semi-detached house
- Offered in excellent order throughout
- Large kitchen/breakfast room
- Two further spacious reception rooms
- Level, landscaped rear garden
- Ground floor bedroom/study
- Modern kitchen, shower & cloakrooms
- Driveway to front
- Close to outstanding schooling, amenities & transport links
- Potential to further extend - subject to the relevant consents

## Viewing

Please contact our Butler's Worcester Park Office on 020 39 069 169 if you wish to arrange a viewing appointment for this property or require further information.

## Energy Efficiency Graph

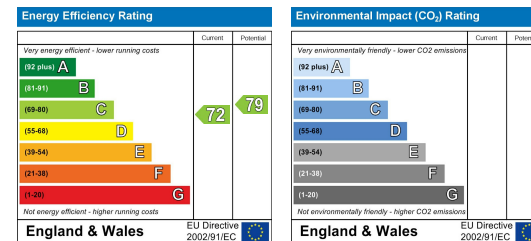

These particulars, whilst believed to be accurate are set out as a general outline only for guidance and do not constitute any part of an offer or contract. Intending purchasers should not rely on them as statements of representation of fact, but must satisfy themselves by inspection or otherwise as to their accuracy. No person in this firm's employment has the authority to make or give any representation or warranty in respect of the property.