

www.jeffreygross.co.uk

CARDIFF

VALE

CAERPHILLY

BRISTOL



Southmead Road

WESTBURY-ON-TRYM



Comments by Ms Ashton Jones



Property Specialist
Ms Ashton Jones
Branch manager

a.jones@thepropertyoutlet.com



Southmead Road, BS10 5EN

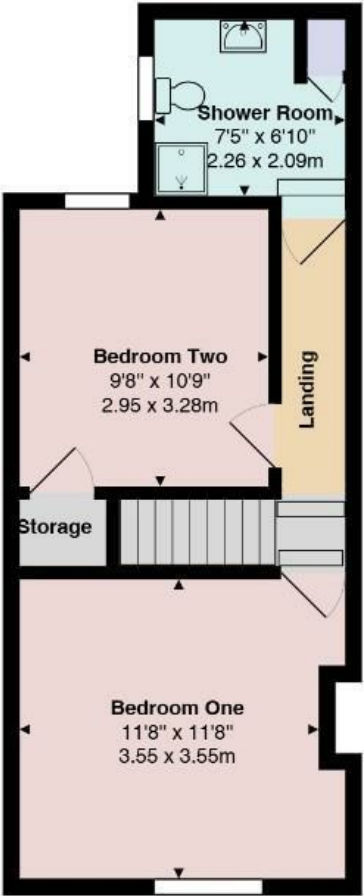
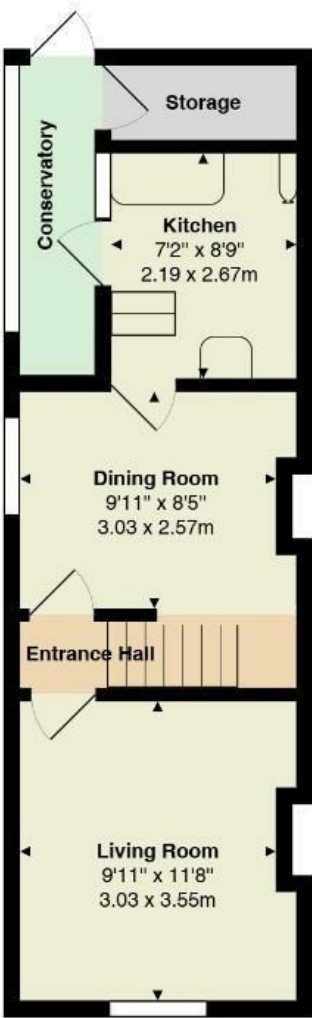

Total Area: 829 ft² ... 77.0 m²

All measurements are approximate and for display purposes only



Southmead Road

Westbury-On-Trym, Westbury-On-Trym, BS10 7FA

Offers In The Region Of

£260,000



2 Bedroom(s)



1 Bathroom(s)



742.71 sq ft



Contact our
Property Outlet Branch

0117 935 4565

FULL DETAILS COMING SOON

Located on Southmead Road with three neighbouring properties on the market. This is a great investment opportunity.

In need of modernisation the property benefits from a generous living space with a reception room to the front of the property and a dinning room leading to a fitted kitchen to the rear. Upstairs the house comprises two spacious bedrooms and a shower room& W/C, ideal for a small family or couple.

One of the standout features of this property is the parking space available for one vehicle, a valuable asset in this location. The proximity to Southmead Hospital makes it particularly appealing for those working in the healthcare sector or anyone who appreciates the convenience of nearby amenities.

Westbury-On-Trym is known for its vibrant community and excellent local facilities, including shops, schools, and parks, all within easy reach. This property presents an excellent opportunity for those looking to settle in a welcoming neighbourhood.

Contact us today to book your viewing.



Entrance Hall

Living Room

Kitchen

Bedroom One

Bedroom Two

Bathroom

Conservatory

Garden

Garage

CARDIFF

VALE

CAERPHILLY

BRISTOL

www.jeffreygross.co.uk



