



## Great West Road, TW8

£370 Per week

A contemporary one bedroom apartment comes with allocated parking, located in this popular development with residents gym, cinema, games rooms and communal work space.

Located to offer a wide range of local services and amenities, including Chiswick High Road, Gunnersbury park, Kew Bridge railway station, Gunnersbury tube station and the M4.

### Features

- One Bedroom
- Communal Terraces
- Concierge Service
- Resident's Cinema
- Resident's Gymnasium
- Allocated Parking



## Great West Road, TW8

Each property has a minimalist bespoke approach whilst including everything you could possibly need. There are cleverly incorporated storage areas, built-in benches, hyperoptic internet connection and climate cooling in each apartment.

This impressive building has a glass fronted facade, a spiral staircase which greets you as soon as you walk in, communal TV areas on each floor, a communal work space, a resident's gym, a resident's cinema, a private meeting room and a resident's games room.

All apartments offer a ceiling height of 3m, have built-in work spaces, naturally engineered oak flooring, video entry phones and high end Bosch and Zanussi appliances.



# Great West Road, Brentford, TW8

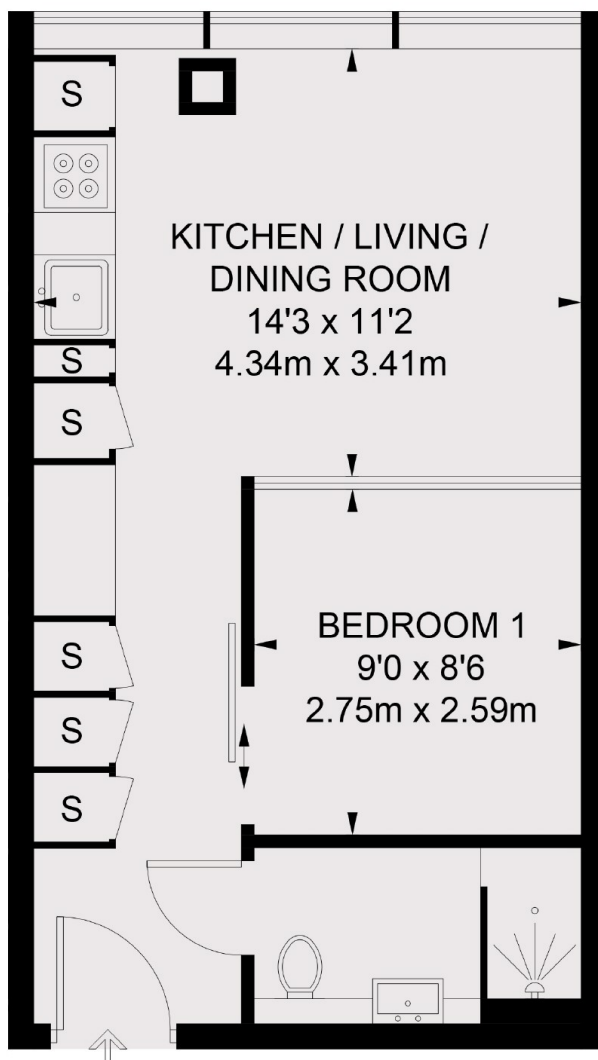

## THIRD FLOOR

TOTAL APPROX. FLOOR AREA 360 SQ. FT. (33.5 SQ. M.)