



ASPIRE

— TO MOVE —



Alfred Street, Bath

Video and physical viewings available. Second floor, two bedroom furnished apartment located on Alfred Street, central Bath. Available from the 6th July.

Alfred Street is located just north of Bath city centre and provides excellent access to local amenities on George Street and Milsom Street, all within 0.3 miles. Hedgemoad Park is 0.3 miles away and there is a bus stop on Lansdown Road 0.1 miles away.

£2,050 Per month

Alfred Street, Bath

- Available 6th July
- Council tax band C, if applicable
- Two double bedrooms
- Second floor flat
- Central location
- Holding deposit: £473
- Furnished
- Gas central heating

Video and physical viewings available. Second floor, two bedroom furnished apartment located on Alfred Street, central Bath. Available from 6th July

Alfred Street is located just north of Bath city centre and provides excellent access to local amenities on George Street and Milsom Street, all within 0.3 miles. Hedgemoor Park is 0.3 miles away and there is a bus stop on Lansdown Road 0.1 miles away.

The apartment is located on the second floor and is offered furnished. There is a modern, stylish kitchen with base and wall units, cooker, induction hob, washing machine, tumble dryer, fridge/freezer, and dishwasher. There is a built in table with chair and cupboard that houses the gas combi boiler. Next to the kitchen is the shower room which has a large shower cubicle, toilet and basin. The living room is located at the front of the apartment and is nice, bright room with double aspect windows and feature fireplace. Sofa and table will be provided. There are two bedrooms, with bedroom one benefitting from a built in wardrobe. The second bedroom is ideal as an office space or guest bedroom. Both bedrooms will come with double beds, mattresses, wardrobe space and chest of drawers. There is a storage cupboard in the hallway with mirror.

The property is offered furnished and would best suit a professional couple, two sharers or two mature students. Available from July.

Council tax band C: £2066.91

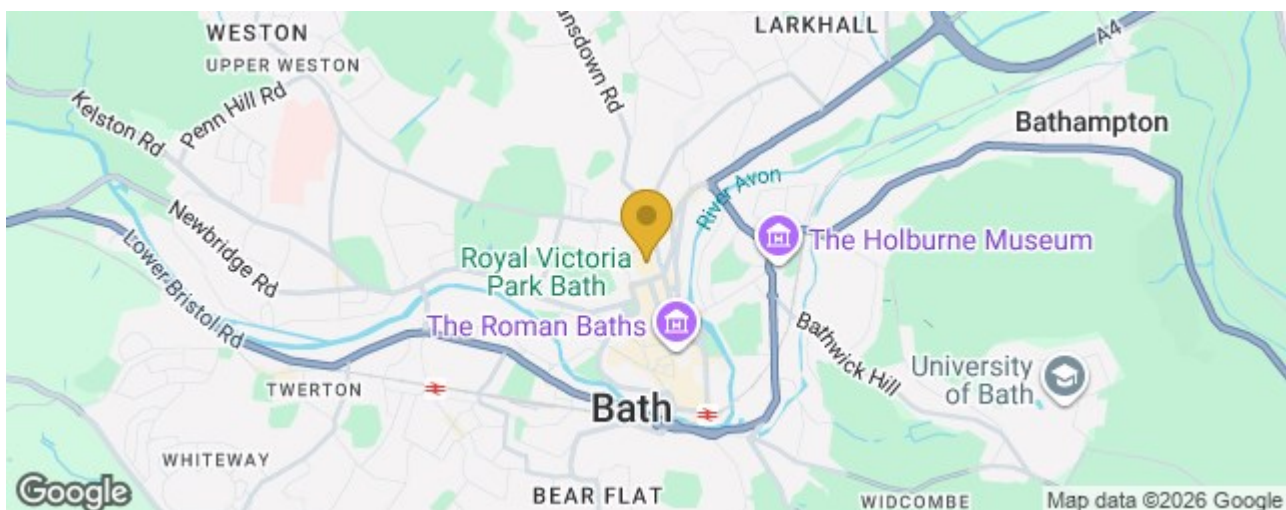



SECOND FLOOR
638 sq.ft. (59.3 sq.m.) approx.

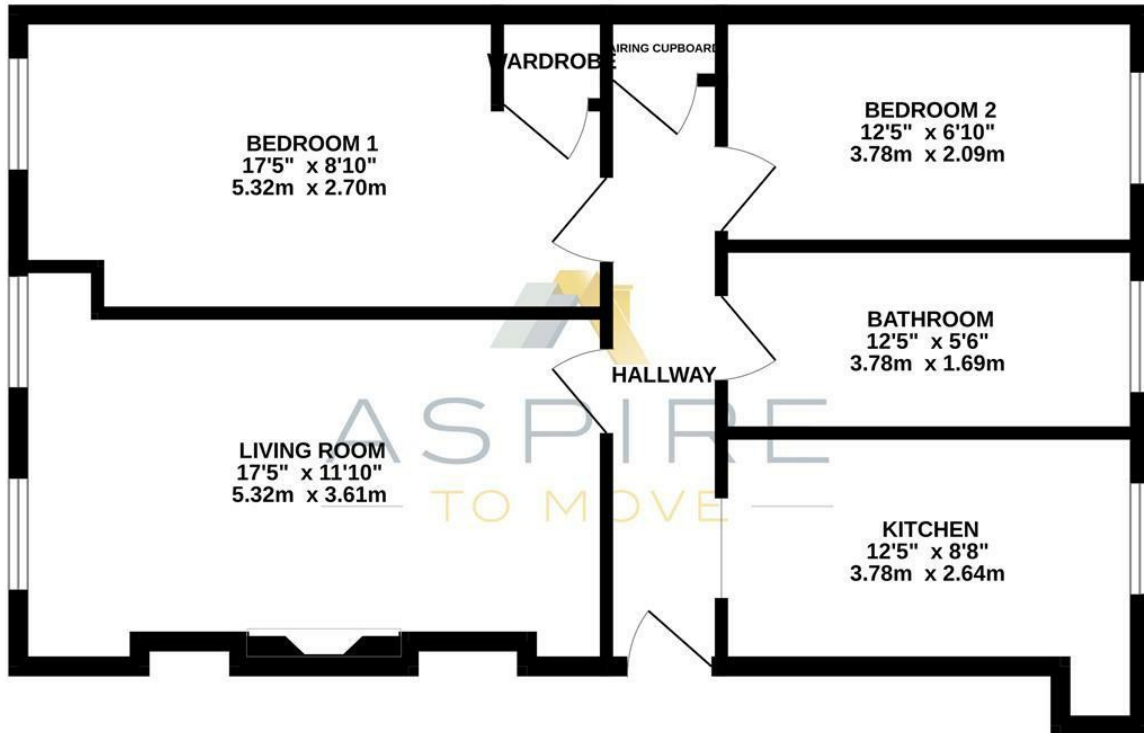

TOTAL FLOOR AREA : 638 sq.ft. (59.3 sq.m.) approx.

Whilst every attempt has been made to ensure the accuracy of the floorplan contained here, measurements of doors, windows, rooms and any other items are approximate and no responsibility is taken for any error, omission or mis-statement. This plan is for illustrative purposes only and should be used as such by any prospective purchaser. The services, systems and appliances shown have not been tested and no guarantee as to their operability or efficiency can be given.
Made with Metropix ©2023.

These particulars, whilst believed to be accurate are set out as a general outline only for guidance and do not constitute any part of an offer or contract. Intending purchasers should not rely on them as statements of representation of fact, but must satisfy themselves by inspection or otherwise as to their accuracy. No person in this firm's employment has the authority to make or give any representation or warranty in respect of the property.

