



## Gloucester Terrace, W2

£350,000

A studio apartment located on the raised ground floor in a Victorian period conversion. The property has wooden flooring, high ceilings, and is an ideal property for anyone looking for a pied-a-terre, first time purchase or rental investment.

Gloucester Terrace W2 is on the door step of Hyde Park and Paddington, with easy access across London and to Heathrow. There's plenty of local shops, restaurants and pubs to choose from.

### Features

- Studio
- Raised Ground Floor
- Seperate Kitchen
- Hyde Park
- White Stucco Fronted

# Gloucester Terrace, London, W2

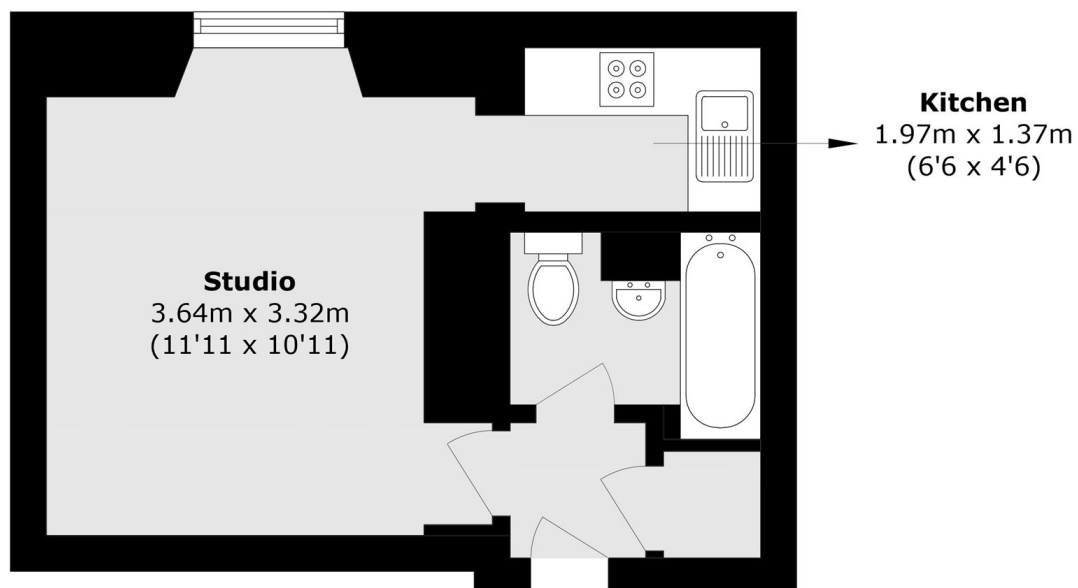

## Ground Floor

Total area (approx.): 23.5 sq. m (252.9 sq. ft)