



Academy Apartments Institute Place, London, E8 1JZ

£600,000



£600,000

Academy Apartments Institute Place

London, E8 1JZ

- Landmark former school conversion
- Impressive 27 ft open-plan living space
- Large industrial-style windows
- Moments from Hackney Downs and London Fields
- Approximately 989 sq ft / 92 sq m
- Original exposed brickwork throughout
- Beautifully preserved communal entrance hall
- Excellent transport links via Hackney Central and Hackney Downs

The Home -

Occupying a striking position within the landmark Academy Apartments conversion, this two-bedroom apartment offers almost 1,000 sq ft of characterful living space within one of Hackney's most distinctive former school buildings. Positioned on the lower ground floor, the apartment combines the robust industrial character of the original architecture with a calm, contemporary interior palette.

The building itself makes an immediate impression. Originally constructed as an educational institute, its striking brick façade, arched windows and beautifully preserved communal entrance hall speak to the building's rich history. Inside, the apartment unfolds around a remarkable open-plan living space where exposed brickwork, polished concrete floors, original radiators and oversized school-style windows create a setting that feels both architectural and inviting.



The Indoors

At the heart of the home is an expansive kitchen, dining and reception room extending over 27 feet in width. The scale is immediately apparent, with exposed brick elevations running the length of the space and original steel-framed windows drawing light deep into the apartment. Polished concrete floors flow throughout, reinforcing the industrial heritage of the building while providing a clean, contemporary backdrop.

The kitchen has been designed as a sociable part of the living space, arranged around a large central island with extensive worktop space and integrated appliances. Open shelving and simple cabinetry keep the aesthetic pared back, allowing the original fabric of the building to remain the focal point.

Two bedrooms sit beyond the main living area. The main bedroom is quietly positioned and offers excellent proportions, soft finishes and built-in storage, while the second bedroom provides flexibility as a guest room, study or work-from-home space. The current arrangement demonstrates how comfortably the room accommodates both home office and occasional guest use.

The bathroom has been finished with a timeless material palette, featuring white metro tiling, patterned floor tiles, a full-sized bath and separate walk-in shower. Practical storage has been incorporated throughout the apartment, ensuring the generous floor area is matched by everyday functionality.

Throughout the home, exposed brickwork, concrete floors, original radiators and visible industrial detailing create a strong architectural identity that feels entirely authentic to the building's origins.





The Outdoors

This home benefits from access to a secluded residents' courtyard, ideal for enjoying quiet afternoons or shared community moments. A WhatsApp and Facebook group among residents makes for a connected, friendly atmosphere, and the building's thick brickwork ensures whisper-quiet interiors despite its bustling location. There is residents' parking available from Hackney Council – Zone D, which covers all of central Hackney.

Loving The Location

Hackney Downs overground station is just a short stroll away and transports you to Liverpool Street in under 10 minutes. Hackney Central is a 7 minute walk, connecting you to east-west routes. Several bus lines also run to Dalston, Angel and the West End from the stop in front of Academy Apartments. Pembury Circus (the junction outside the apartment) is currently being pedestrianised in order to reduce traffic and Amhurst Road is being redeveloped to provide more green spaces, both expected to finish early 2026.

Academy Apartments is located moments from the open green space of Hackney Downs which has tennis and basketball courts and is excellent for dog-walking. Opposite the property is the renowned Pembury Tavern with superb ACE Pizza and, if you like pizza, the notorious Spurstowe Arms / Dough Hands is less than ten minutes too. Papa's Bagels, Oren and (Michelin-starred) Casa Fofò are all five minutes away.



SOUV. ELECTRIC & CLUB 121 PRESENT
CHRISTOPHER TUBBS
ALL NIGHT LONG
SATURDAY JUNE 11TH 2022 - 10PM-4AM



Floor Plans

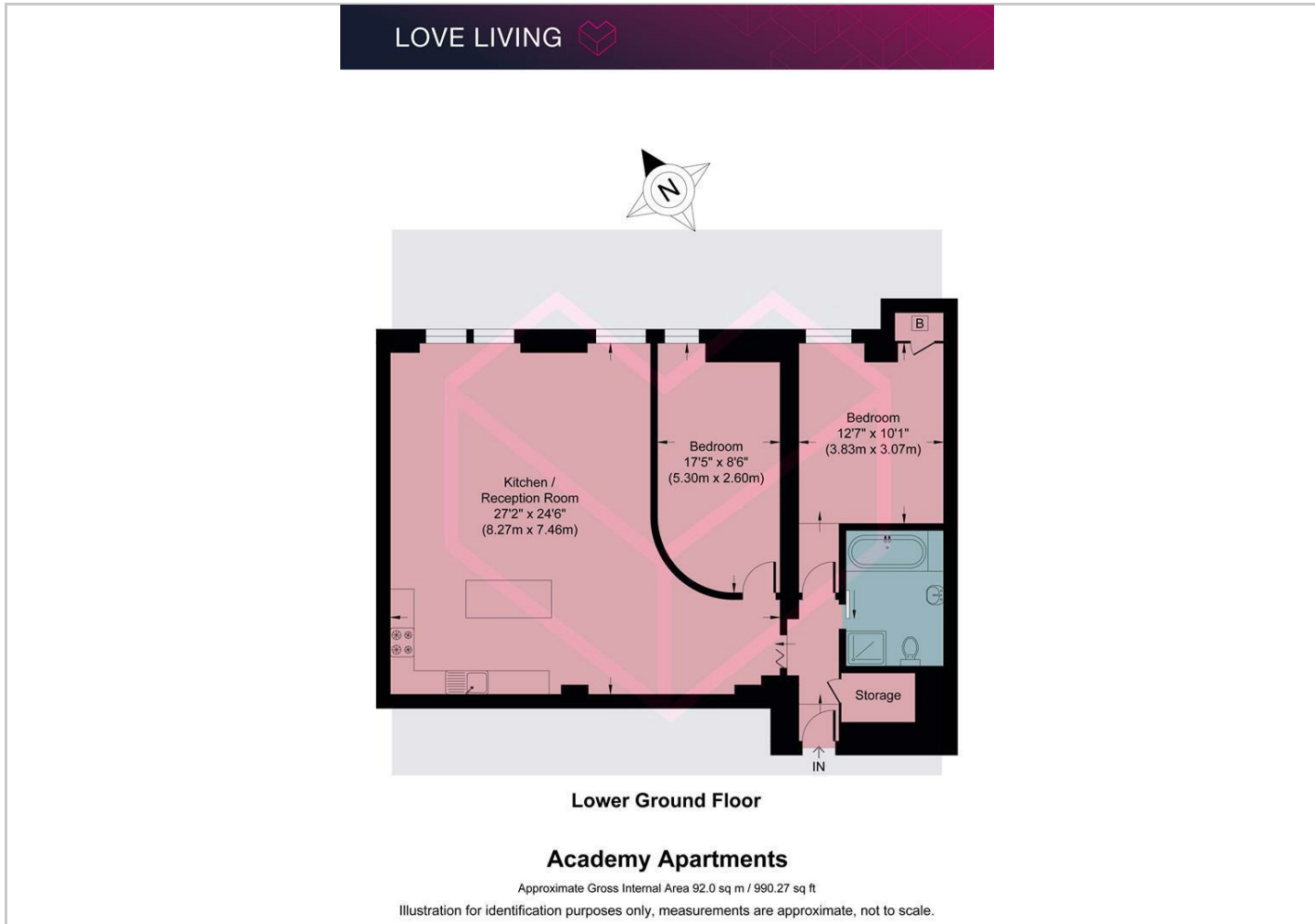

Viewing

Please contact our Love Living Hackney Office on 0203 005 2600 if you wish to arrange a viewing appointment for this property or require further information.

The particulars are set out as a general outline only for the guidance of intended purchasers or lessees, and do not constitute, any part of a contract. Nothing in these particulars shall be deemed to be a statement that the property is in good structural condition or otherwise nor that any of the services, appliances, equipment or facilities are in good working order. Purchasers should satisfy themselves of this prior to purchasing.

Studio 74, Containerville 1 Emma Street, London, E2 9DT
 Tel: 0203 005 2600 Email: hello@loveliving.uk <https://www.loveliving.uk>

Location Map

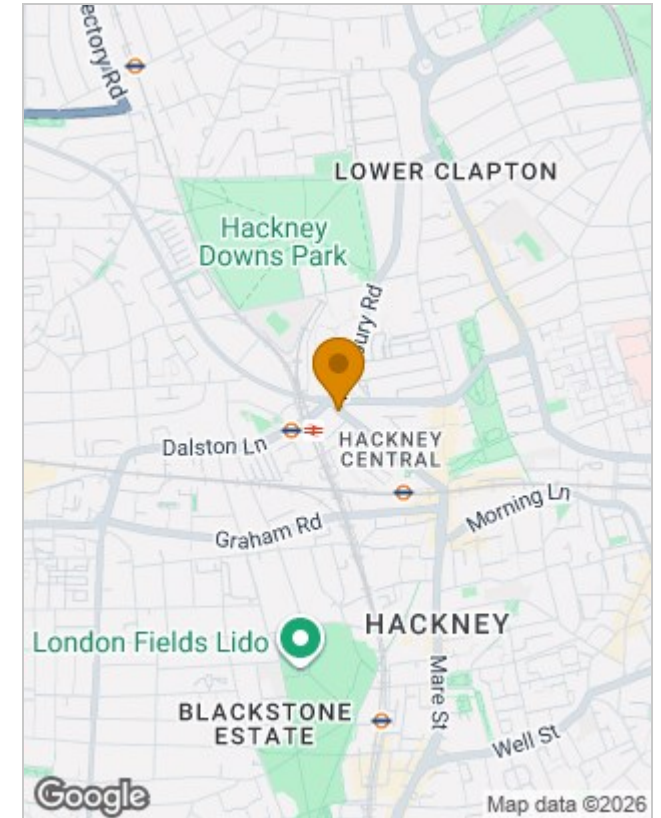

Energy Performance Graph

