



69 Chepstow Road
Corby, NN18 8QQ



Simpson West

Situated within the desirable Oakley Vale development and being sold with NO ONWARD CHAIN this impressive detached house offers a practical and spacious floorplan. Boasting FOUR DOUBLE BEDROOMS to the first floor and a converted garage that has been thoughtfully converted to provide an additional, spacious bedroom complete with its own en-suite. The property comprises an entrance hall, WC, kitchen/breakfast area, and a spacious lounge/dining room.

To the first floor are four further bedrooms, including the master bedroom with an en-suite shower room, along with a modern family bathroom.

Externally, the home benefits from both front and rear gardens, with a private driveway providing ample off-road parking. The fully enclosed rear garden offers a safe and private space, ideal for summer entertaining and family gatherings.

The property is ideally located close to a range of local schools, shops, and excellent transport links, making it perfect for families and commuters alike. Everyday amenities are within easy reach, while nearby road and public transport connections provide convenient access to surrounding areas and town centres. Viewing of this home is highly recommended to truly appreciate the space on offer.

Council Tax band - E. EPC rating - C.



£325,000



5



3



1



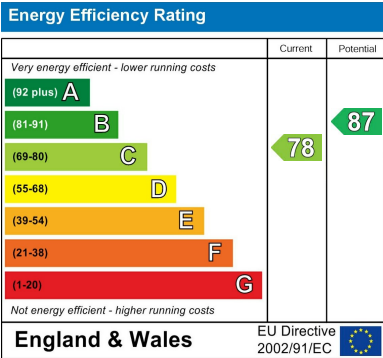
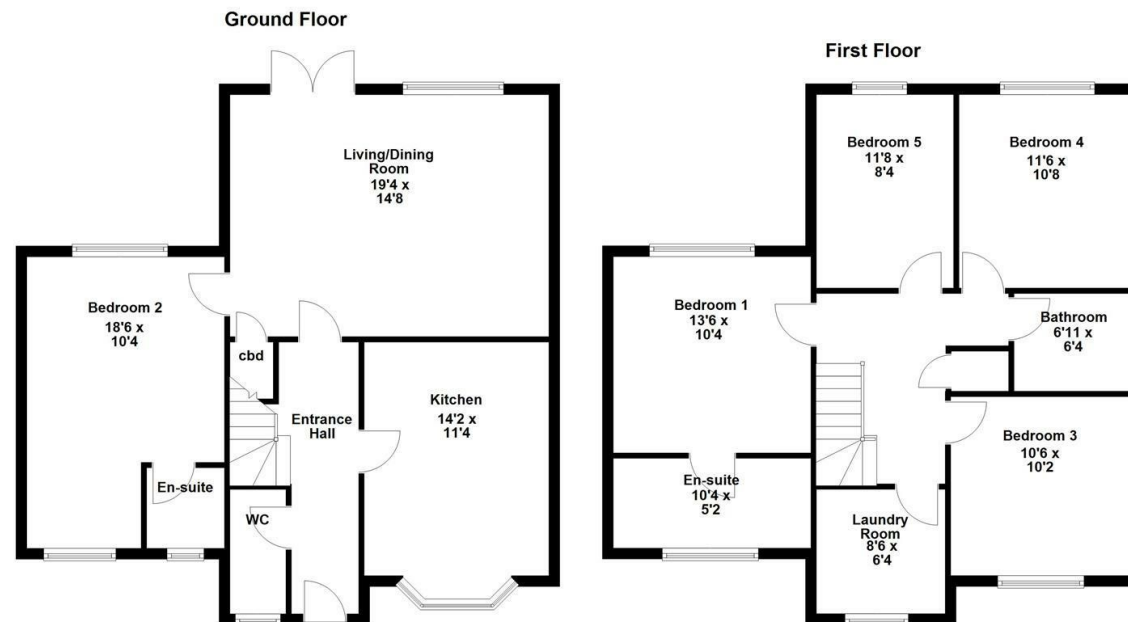

When you buy with Simpson West, you know **you'll be in safe hands**. From the moment you walk through our doors, we'll make you **feel truly welcome**. Our sales consultants and financial advisors will take you through **every step of the process**, offering **free expert advice** along the way, from help choosing the right mortgage and insurance through to finding your conveyancer. And if you need help selling your home too, **with over 20 years of local experience, you can trust us to get you moving**.



**Simpson
West**

Making Every
Journey Personal



01536 202007

info@simpsonwest.co.uk

<https://www.simpsonwest.co.uk/>

64 Corporation Street, Corby, Northants, NN17 1NH