



Connells

Updown Way
Chartham Canterbury



Property Description

Charming Three Bedroom Semi-Detached Home in Chartham with Garage and Off-Road Parking

Situated in the sought-after village of Chartham, this well-presented three-bedroom semi-detached home offers comfortable modern living in a peaceful setting, just a short distance from Canterbury.

The property features a spacious living room, a modern fitted kitchen/dining area with access to the rear garden, and a bright, airy layout throughout. Upstairs, there are three good-sized bedrooms and a family bathroom, perfect for couples or growing families.

Outside, the home benefits from a private rear garden, an attached garage, and off-road parking for multiple vehicles.

Located within easy reach of local amenities, schools, and Chartham train station, this property combines village charm with convenient access to transport links and the city.



Entrance Hall

Lounge Dining Room

17' 4" x 16' 1" (5.28m x 4.90m)

Kitchen

9' 4" x 7' 10" (2.84m x 2.39m)

Conservatory

15' 5" x 6' 5" (4.70m x 1.96m)

Landing

Bedroom One

13' 9" x 10' 4" (4.19m x 3.15m)

Bedroom Two

10' 11" x 7' 3" (3.33m x 2.21m)

Bedroom Three

11' 5" x 8' 6" (3.48m x 2.59m)

Bathroom

Garage

16' 4" x 7' 9" (4.98m x 2.36m)







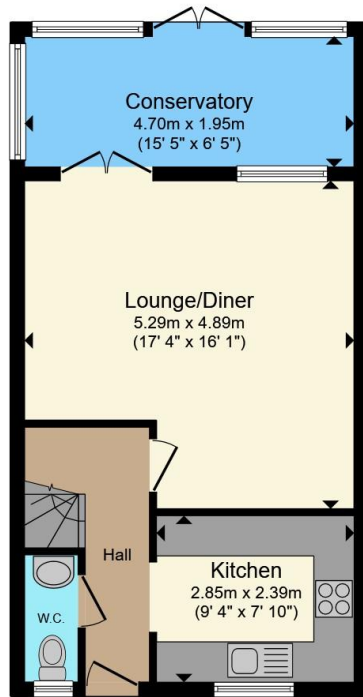

Ground Floor

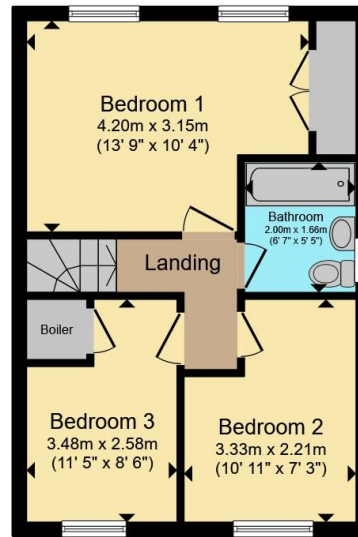

First Floor

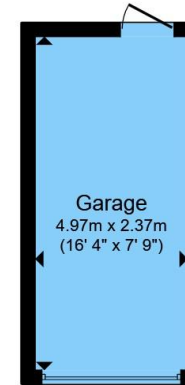

Garage

Total floor area 95.0 m² (1,023 sq.ft.) approx

This floor plan is for illustrative purposes only. It is not drawn to scale. Any measurements, floor areas (including any total floor area), openings and orientation are approximate. No details are guaranteed, they cannot be relied upon for any purpose and they do not form part of any agreement. No liability is taken for any error, omission or misstatement. A party must rely upon its own inspection(s). Powered by www.propertybox.io



To view this property please contact Connells on

T 01227 764 720
E canterbury@connells.co.uk

29-30 Watling Street
 CANTERBURY CT1 2UD

EPC Rating: C Council Tax
 Band: D

Tenure: Freehold

view this property online connells.co.uk/Property/CBY406985



1. MONEY LAUNDERING REGULATIONS Intending purchasers will be asked to produce identification documentation at a later stage and we would ask for your co-operation in order that there will be no delay in agreeing the sale. 2. These particulars do not constitute part or all of an offer or contract. 3. The measurements indicated are supplied for guidance only and as such must be considered incorrect. Potential buyers are advised to recheck measurements before committing to any expense. 4. We have not tested any apparatus, equipment, fixtures, fittings or services and it is in the buyers interest to check the working condition of any appliances.

Connells Residential is registered in England and Wales under company number 1489613, Registered Office is Cumbria House, 16-20 Hockliffe Street, Leighton Buzzard, Bedfordshire, LU7 1GN. VAT Registration Number is 500 2481 05.

See all our properties at www.connells.co.uk | www.rightmove.co.uk | www.zoopla.co.uk

Property Ref: CBY406985 - 0005