



ELMS CRESCENT, SW4

£3,250 PCM

- Victorian conversion
- Over 1000sqft
- Three double bedrooms
- Modern kitchen
- Ideal for sharers
- Energy rating: D





ABOUT THE HOME

A split level three bedroom, two bathroom property, benefitting from a large private garden.

Elms Crescent is a popular road located in Abbeville Village and is less than a mile to either Clapham South and Clapham Common tube stations.





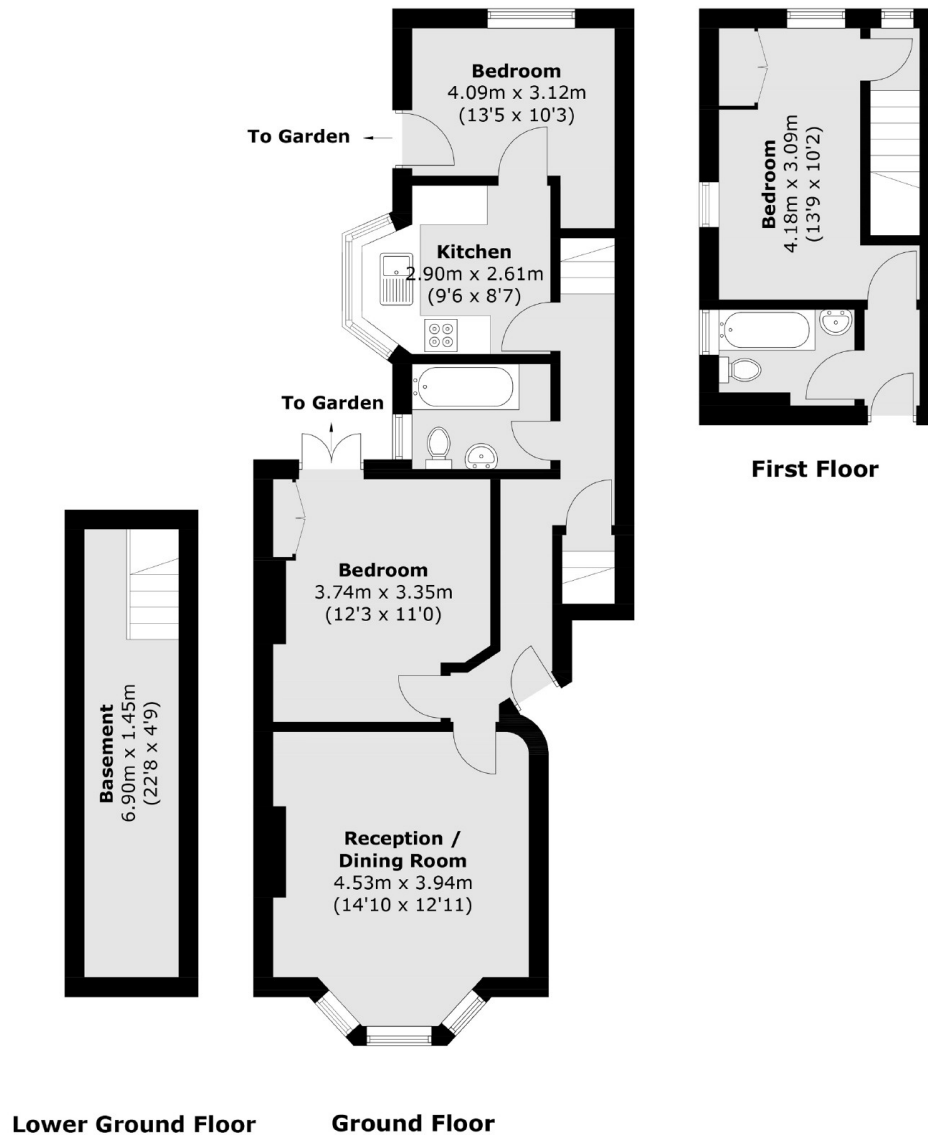

Total area (approx.): 85.6 sq. m (921.3 sq. ft)

JACKSONS CLAPHAM

73 Abbeville Road, London,
SW4 9JN
Sales: 020 8487 3177
Lettings: 020 8487 3178

Energy Rating: D We aim to make our particulars both accurate and reliable. However they are not guaranteed; nor do they form part of an offer or contract. If you require clarification on any points then please contact us, especially if you're traveling some distance to view. Please note that appliances and heating systems have not been tested and therefore no warranties can be given as to their good working order.