



North Side Wandsworth Common, £330,000

A stylish period conversion moments from Wandsworth Common. The apartment boasts a large reception/bedroom, separate kitchen and bathroom. The double bedroom provides a peaceful retreat, complemented by a sleek, modern bathroom. Step outside into your private garden to enjoy morning coffee, evening drinks, or simply soak up the sun in a tranquil setting. The property further benefits from a share of the freehold and has a private entrance.

North Side Wandsworth Common is a short stroll from St. Johns Hill with its excellent selection of shops, bars and restaurants and is located close to all of the amenities of Northcote Road as well. Clapham Junction is very close offering excellent mainline transport links

Features

- Studio Apartment
- Own Front Door
- Period Conversion
- Share Of The Freehold
- Superb Location
- Private Garden

North Side Wandsworth Common, London, SW18

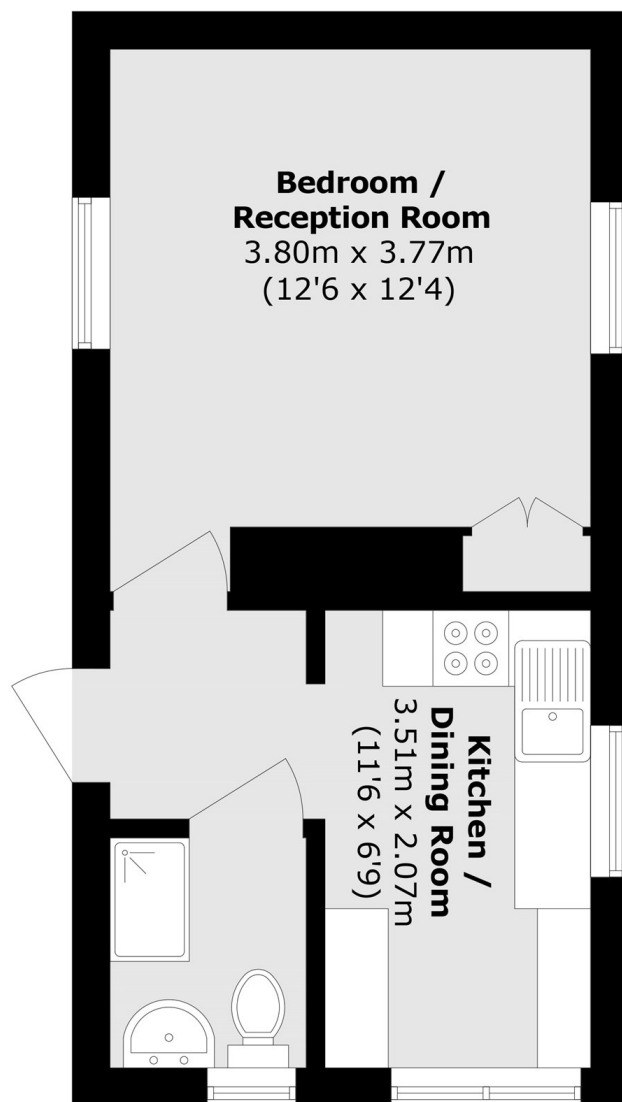

Total area (approx.): 30.6 sq. m (329.3 sq. ft)

Dexters

Northcote Road
93 St. John's Road
London
SW11 1QY
Sales
020 7483 6333

Energy Rating: C. We aim to make our particulars both accurate and reliable. However they are not guaranteed; nor do they form part of an offer or contract. If you require clarification on any points then please contact us, especially if you're traveling some distance to view. Please note that appliances and heating systems have not been tested and therefore no warranties can be given as to their good working order.

 **RICS** | Regulated
Estate Agent
and Letting Agent

[dexters.co.uk](https://www.dexters.co.uk)