

ALLDAY
& MILLER



Martindale, Iver, SL0 0HY
£450,000

3 1 1 D



Martindale, Iver, SL0 0HY

£450,000

- Three Bedrooms
- Located on a Quiet Cul De Sac
- Good Condition Throughout
- Allocated Parking For Two Cars
- Sought After Location
- Semi Detached
- No Chain
- Downstairs W/C & 2nd Floor Family Bathroom
- Private Rear Garden
- EPC Rating - D

Description

This well presented and spacious three bedroom family home is filled with natural light and has been recently painted throughout, offering a bright and welcoming living environment.

The ground floor comprises a generous and airy reception/dining room, ideal for both relaxing and entertaining, with double patio doors opening onto a patio area that extends into a lovely private rear garden. A modern, stylish fitted kitchen complete with appliances, along with a convenient downstairs WC.

To the first floor are three bedrooms, including a large master bedroom with built-in storage, two further well-proportioned bedrooms (one of which would also make an ideal home office or workspace), and a contemporary family bathroom.

Additional features include double glazed windows throughout, off-street parking for two cars, and a well-maintained private rear garden perfect for outdoor dining and family enjoyment.

Situation

Martindale in the popular village of Iver Heath, on the outskirts of Uxbridge. Iver/ Iver Heath has a range of good local amenities such as shops, pubs, restaurants and supermarkets, with more comprehensive shopping and transport facilities at Uxbridge or Slough town centres, which are a short drive away. The area is served with popular leisure facilities such as Black Park and Langley Park. For commuters, Iver train station offers several links to Central London with the Elizabeth line. The M25, M1, M40 & M4 are also easily accessible for those needing good road links. The South Buckinghamshire area also offers access to a number of well regarded schools. The renowned Grammar schools of Slough and Langley are close by.



Floor Plans

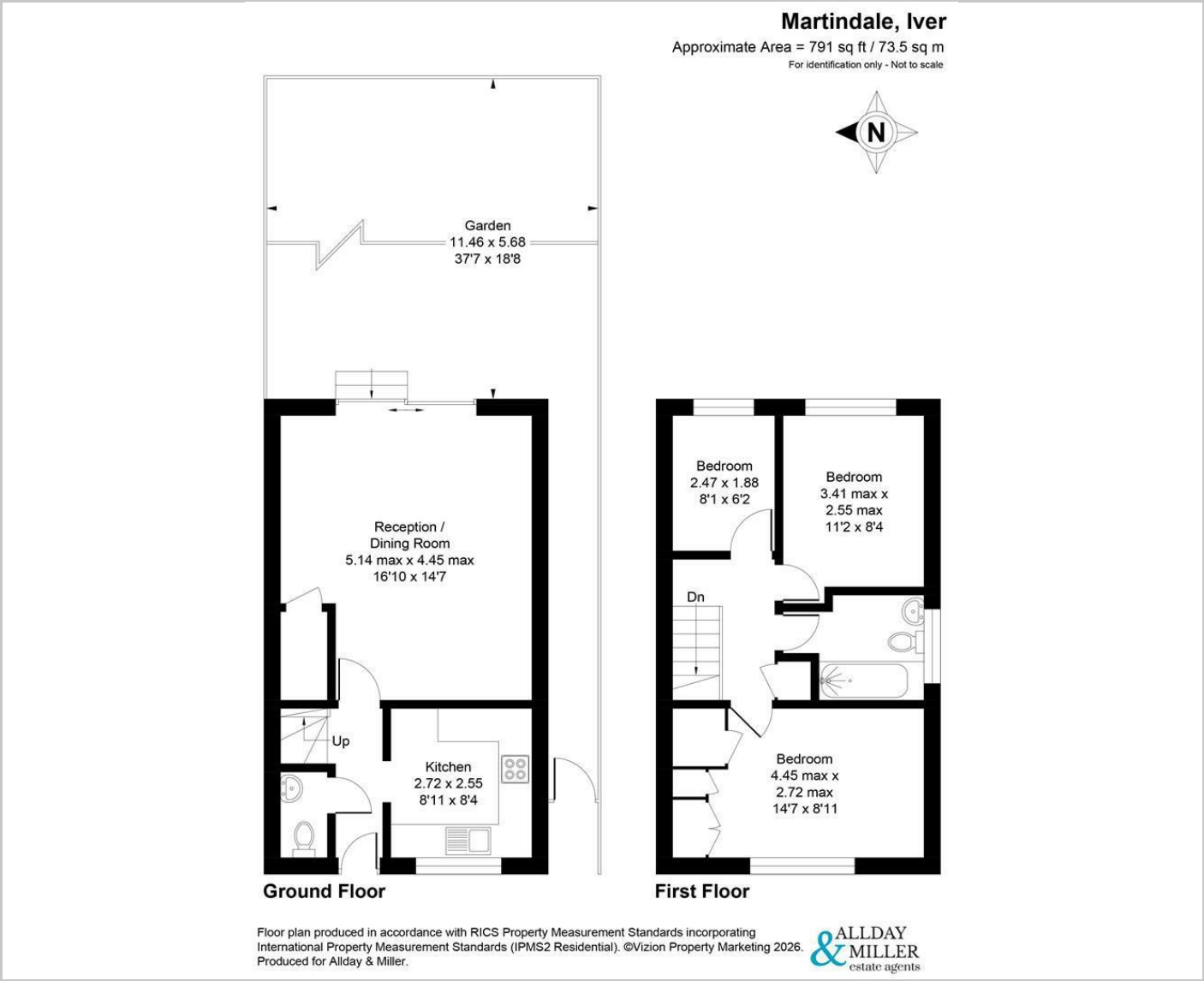

Area Map



Energy Performance Graph

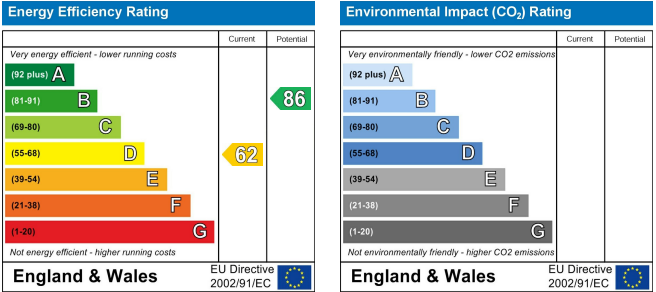

These particulars, whilst believed to be accurate are set out as a general outline only for guidance and do not constitute any part of an offer or contract. Intending purchasers should not rely on them as statements of representation of fact, but must satisfy themselves by inspection or otherwise as to their accuracy. No person in this firms employment has the authority to make or give any representation or warranty in respect of the property.

www.alldayandmiller.co.uk

192 High Street, Uxbridge, Middlesex, UB8 1LB

T: 01895 641 000 | E: sales@alldayandmiller.co.uk

T: 01895 379 549 | E: lettings@alldayandmiller.co.uk