



Sweetpea Way, Cambridge
OIEO £250,000 Leasehold

**Sharman
Quinney**

Key Features



125 Years remaining as of 29 Sep 2009
£200.00 Ground Rent per annum
Review due: [Ask Agent](#)
£2126.46 Service Charge per annum
Review due: [Ask Agent](#)

- Second Floor Apartment
- Open Plan Living
- Two Spacious Bedrooms
- Contemporary Bathroom
- Ample Storage Options

Upon entering the apartment, the bright hallway provides two storage cupboards which are a great option for coats, shoes and any other household belongings, whilst two large windows ensure natural day light throughout.

The spacious and inviting open-plan living area offers a comfortable and versatile environment for modern living with additional room for a dedicated dining area. Set back from the main living space, the kitchen provides a range of built-in appliances



including a fridge-freezer, dishwasher, and oven, along with generous storage options throughout.

Both bedrooms are well-proportioned doubles and include built-in wardrobes with sliding doors, providing practical and stylish storage solutions. The rooms are versatile in their use, offering an ideal setup for guests, children's room or a separate home office and study. The bathroom has a bath with overhead shower, a toilet and hand basin and is partially tiled.

Externally there is a private balcony area which can be accessed via the living room and an allocated parking space and communal bike storage space.

With its desirable combination of modern living spaces, practical features, and excellent location, this property is a fantastic opportunity for those seeking a well-connected and stylish home.

Kitchen / Living room / Dining room - 7.51m x 4.57m (24'8 x 15'0)

Bedroom one - 3.83m x 2.80 (12'7 x 9'2)

Bedroom two - 3.53m x 3.00m (11'7 x 9'10)

Bathroom - 1.70m x 1.61m (5.5m x 5'2)



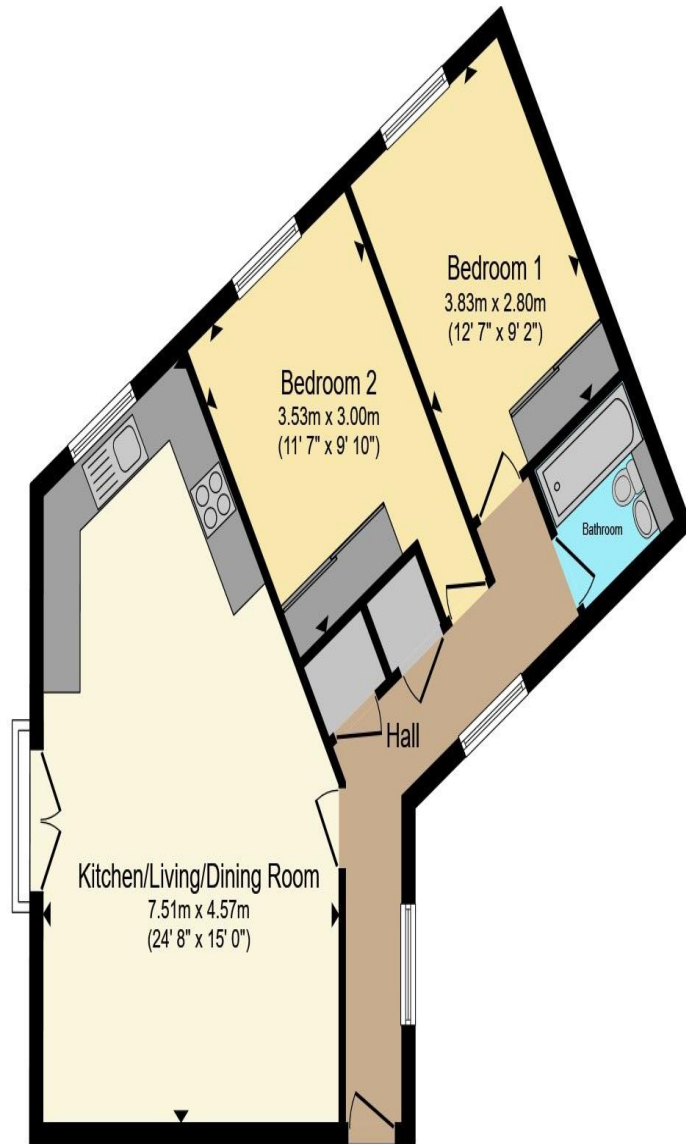

Total floor area 67 m² (705 sq.ft.) approx

This floor plan is for illustrative purposes only. It is not drawn to scale. Any measurements, floor areas (including any total floor area), openings and orientation are approximate. No details are guaranteed, they cannot be relied upon for any purpose and they do not form part of any agreement. No liability is taken for any error, omission or misstatement. A party must rely upon its own inspection(s). Powered by www.propertybox.io

Sharman
Quinney

To view this property call Sharman Quinney on:
01223 426139

Selling your property?

Contact us to arrange a **FREE** home valuation.

 01223 426139

 Unit 5 Orchard House Unwin Square, Orchard Park, CAMBRIDGE, Cambridgeshire, CB4 2AD

 orchardpark@sharmanquinney.co.uk

 www.sharmanquinney.co.uk



 SCAN ME



Sharman Quinney Holdings Limited is registered in England and Wales under company number 4174227, Registered Office is Cumbria House, 16-20 Hockliffe Street, Leighton Buzzard, Bedfordshire, LU7 1GN. VAT Registration Number is 500 2481 05.

1: These particulars do not constitute part or all of an offer or contract. 2: The measurements indicated are supplied for guidance only and as such must be considered incorrect. 3: Potential buyers are advised to recheck the measurements before committing to any expense. 4: Sharman Quinney has not tested any apparatus, equipment, fixtures, fittings or services and it is the buyers interests to check the working condition of any appliances. 5: Sharman Quinney has not sought to verify the legal title of the property and buyers must obtain verification from their legal representative. 6: Intending purchasers will be asked to produce identification documentation at a later stage and we would ask your co-operation in order that there will be no delay in agreeing the sale. Ref: :ORP102151 - 0010