



*jordanfishwick*

Mauldeth Road West  
Manchester





# Mauldeth Road West Manchester M21 7SP

£1,050 Per Calendar Month



## The Property

\*\*\*\*\* AVAILABLE NOW \*\*\*\*\* This Spacious and light recently decorated throughout One Bedroom Flat is perfectly placed for the Centre of Chorlton, Metrolink and Chorlton Park. The property has its own entrance to the rear offering private communal garden space too. The first floor flat has a large landing with Large Double bedroom, Large Lounge with serving hatch through to kitchen, the modern Kitchen has all appliances including Gas hob, tastefully decorated bathroom with shower over bath, there is an addition room set up as an office with built in workspace. Gas is included in the rent. The property is furnished throughout. There is parking to the front of the property not allocated. One not to be missed.

\*\*\*\*\* To arrange a viewing please call 0161 860 4444 \*\*\*\*\*

## Directions

- Council Tax Band A - EPC C
- Spacious and light furnished one Bedroom
- Gas included in rent
- Modern Kitchen & Bathroom
- Additional room for home office
- Parking available
- Available Now

Postcode - M21 7SP

EPC Rating - C

Floor Area - sq ft

Local Authority - Manchester

Council Tax - A

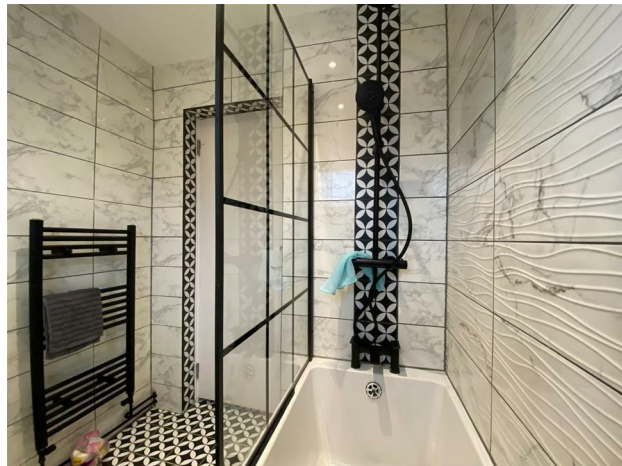



FIRST FLOOR  
514 sq.ft. (47.8 sq.m.) approx.

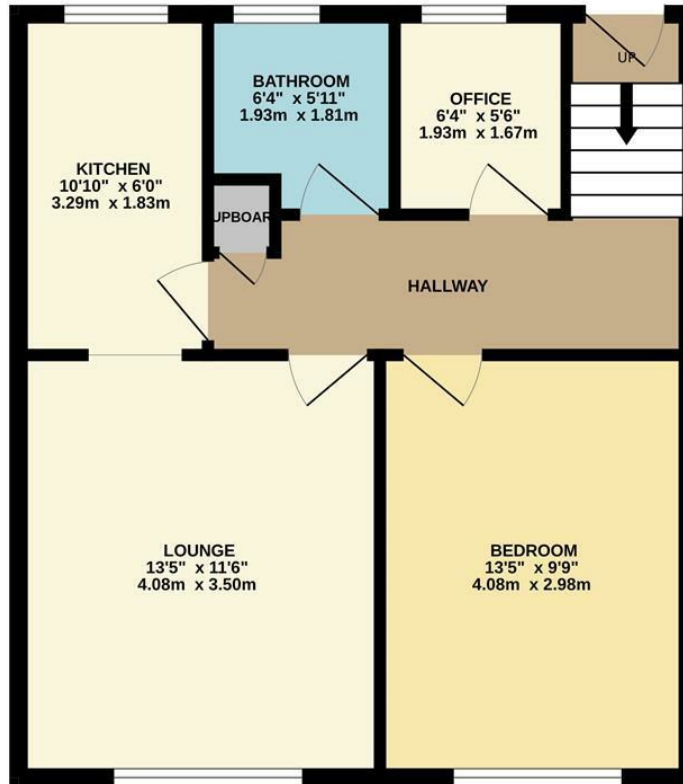

TOTAL FLOOR AREA : 514 sq.ft. (47.8 sq.m.) approx.

Whilst every attempt has been made to ensure the accuracy of the floorplan contained here, measurements of doors, windows, rooms and any other items are approximate and no responsibility is taken for any error, omission or mis-statement. This plan is for illustrative purposes only and should be used as such by any prospective purchaser. The services, systems and appliances shown have not been tested and no guarantee as to their operability or efficiency can be given.  
Made with Metropix ©2026



These particulars are believed to be accurate but they are not guaranteed and do not form a contract. Neither Jordan Fishwick nor the vendor or lessor accept any responsibility in respect of these particulars, which are not intended to be statements or representations of fact and any intending purchaser or lessee must satisfy himself by inspection or otherwise as to the correctness of each of the statements contained in these particulars. Any floorplans on this brochure are for illustrative purposes only and are not necessarily to scale.

Offices at: Offices at Chorlton, Didsbury, Disley, Hale, Glossop, Macclesfield, Manchester Deansgate, Manchester Whitworth Street, New Mills, Sale, Wilmslow and Withington

410-412 Barlow Moor Road, Chorlton, Manchester, M21

01618604444<sup>8AD</sup>

chorlton@jordanfishwick.co.uk  
www.jordanfishwick.co.uk