



Empire Square West, SE1

£507 Per week

A well presented one bedroom apartment situated on the third floor of this modern, landmark development with on-site concierge.

Conveniently located a short walk from London Bridge and Borough Stations. The ever popular Borough Market and Bermondsey Street are also easily accessible.

Features

One Bedroom
Well Presented
24hr Concierge
Great Location
Wood Flooring

Empire Square West, London, SE1

Empire Square SE1
Gross Internal Area:
Third Floor 48 Sq. metres
517 Sq. feet

Dexters

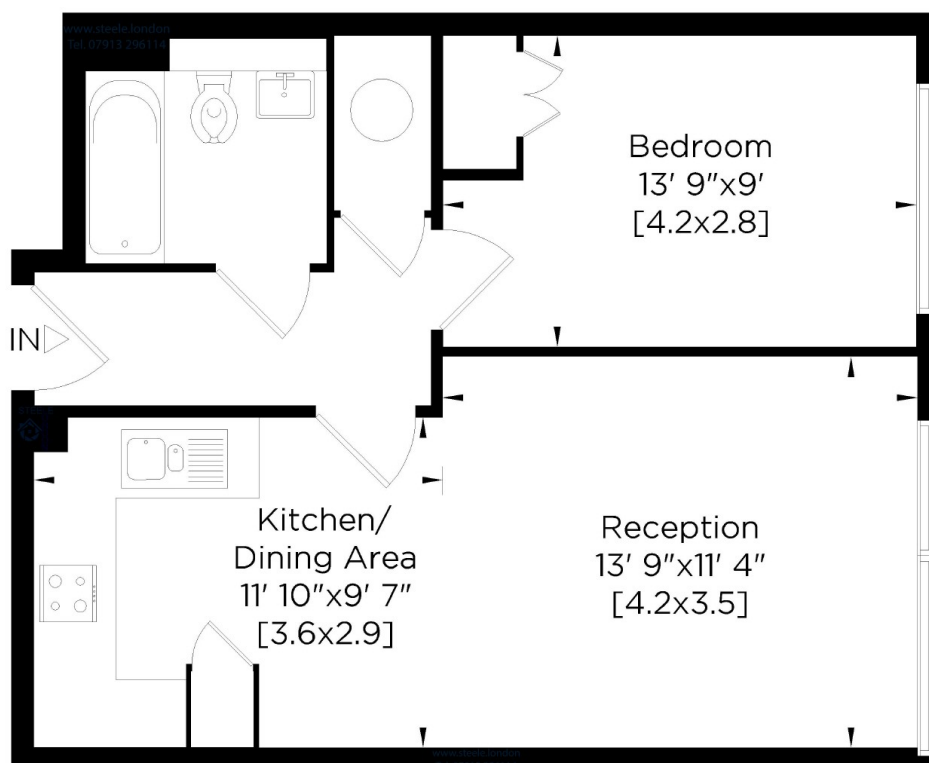

Prepared for Dexters Estate Agents - www.dexters.co.uk To Let 1 Bedroom Flat Empire Square West London SE1
Whilst every attempt has been made to ensure the accuracy of this Lettings floor plan, measurements of doors, windows, rooms and Sq.footage are approximate. The actual property will vary. For identification purposes only. Price on application for a 90 day licence to use this plan. No appliances tested. ©22102024. Not to scale.
Photography, Video, Drone, Floor Plans, Virtual Tours & EPC by www.steele.london
Email: patricia@steele.london - Tel: 07847 219401 - 07913 296114

Dexters

London Bridge
54 Borough High Street
London
SE1 1XL
Lettings
020 7650 5101

Energy Rating: A. We aim to make our particulars both accurate and reliable. However they are not guaranteed; nor do they form part of an offer or contract. If you require clarification on any points then please contact us, especially if you're traveling some distance to view. Please note that appliances and heating systems have not been tested and therefore no warranties can be given as to their good working order.



dexters.co.uk