



Royston Gardens, Ilford, IG1 3SY

£725,000



£725,000

Royston Gardens

Ilford, IG1 3SY

- Chain Free
- Three Bedroom
- Garage
- Driveway
- Great Location

A three bedroom semi-detached house with driveway offering off street parking as well as a garage and side access. The house has potential to extend (Subject to planning permission).

Upon entering the property, you are greeted with a reception room, dining room and separate kitchen that both lead out onto a private garden.

Ascending to the first floor, you will find three bedrooms and a family bathroom and separate wc.

The property has the potential to extend into the loft (subject to planning permission).

The property is situated within the Wanstead High schools catchment area with easy access to Redbridge Underground Station (Central Line), Wanstead Park offers pleasant country walks and cycle paths, Local shops are with easy access to the A12, A406, M11 and M25.



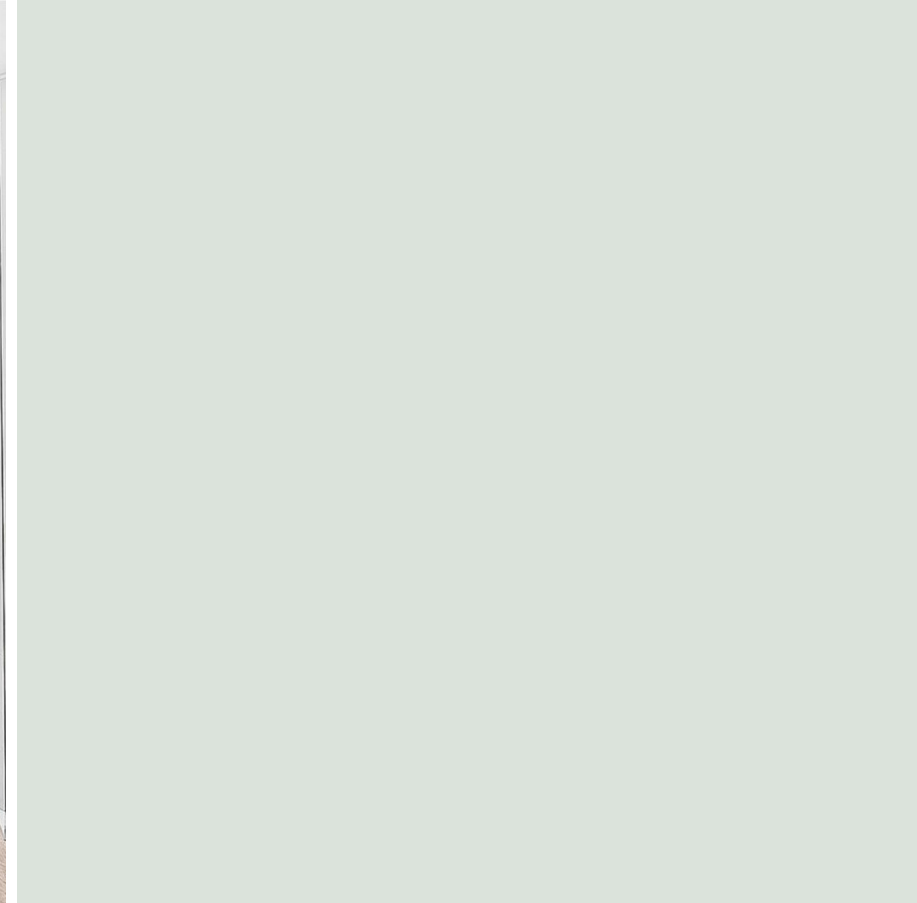

Directions





Floor Plans

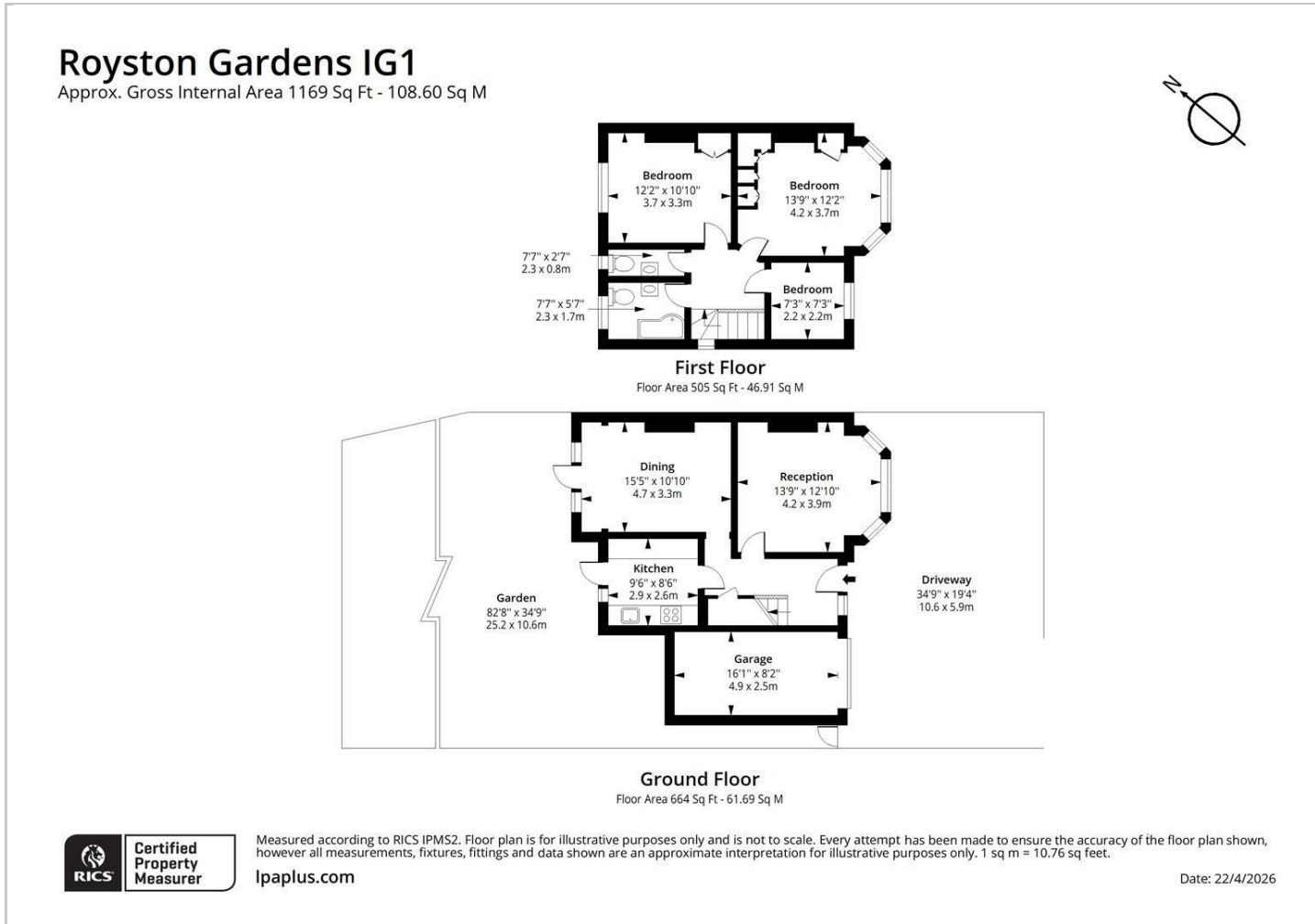

Location Map

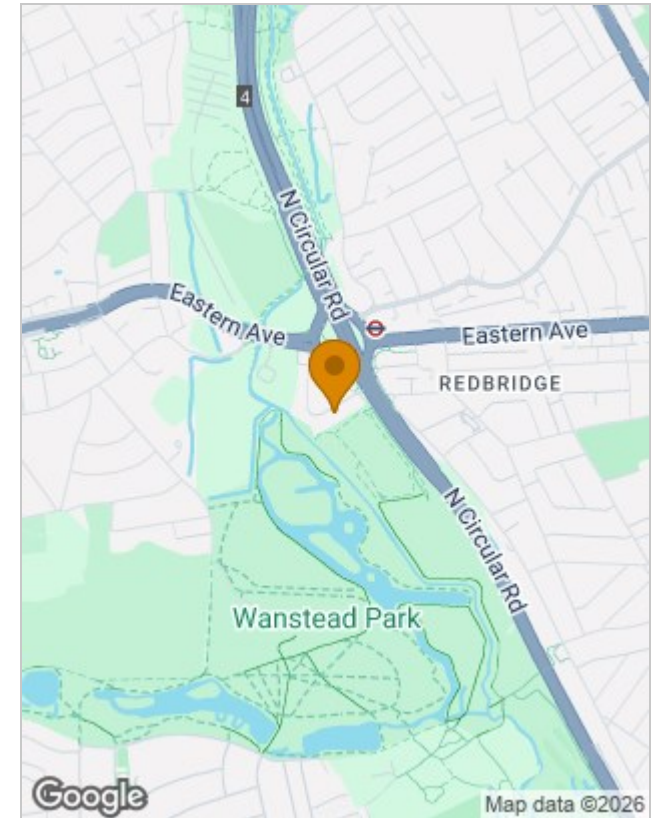

Energy Performance Graph

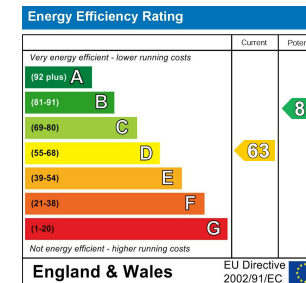

Viewing

Please contact our Redbridge Sales Office on 020 8551 0211 if you wish to arrange a viewing appointment for this property or require further information.

The particulars are set out as a general outline only for the guidance of intended purchasers or lessees, and do not constitute, any part of a contract. Nothing in these particulars shall be deemed to be a statement that the property is in good structural condition or otherwise nor that any of the services, appliances, equipment or facilities are in good working order. Purchasers should satisfy themselves of this prior to purchasing.