

The logo for Sinclair Hammelton, featuring the name in a serif font with a house icon between the words.

Sinclair  Hammelton



ASKING PRICE

£500,000

Vine Place

Westerham, TN16 1LU

The logo for Sinclair Hammelton, featuring the name in a serif font with a house icon between the words.

Sinclair  Hammelton

EPC RATING: G COUNCIL TAX BAND: D

Vine Place, Brasted Chart, Westerham, TN16

Approximate Area = 974 sq ft / 90.5 sq m

For identification only - Not to scale

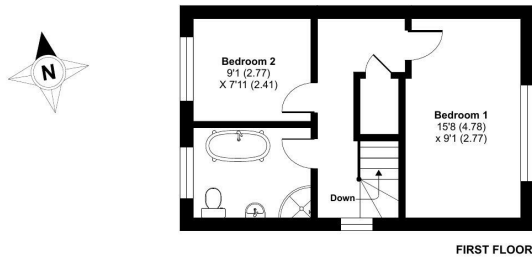

FIRST FLOOR

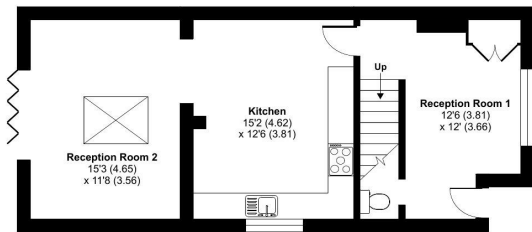

GROUND FLOOR

Floor plan produced in accordance with RICS Property Measurement 2nd Edition, Incorporating International Property Measurement Standards (IPMS2 Residential). © nichecom 2026. Produced for Withers & Curtis. REF: 1488903



Energy Efficiency Rating		Current	Potential
Very energy efficient - lower running costs			
(92 plus)	A		84
(81-91)	B		
(69-80)	C		
(55-68)	D		
(39-54)	E		
(21-38)	F		
(1-20)	G	15	
Not energy efficient - higher running costs			
England & Wales		EU Directive 2002/91/EC	



Agents Note: Whilst every care has been taken to prepare these particulars, they are for guidance purposes only. All measurements are approximate and are for general guidance purposes only and whilst every care has been taken to ensure their accuracy, they should not be relied upon and potential buyers/tenants are advised to recheck the measurements



OFFICE ADDRESS

1&2 The Grange
Westerham
Kent
TN16 7AH

OFFICE DETAILS

01959 587 460
infowh@sinclairhammelton.co.uk
<https://www.sinclairhammelton.co.uk/for-sale-in-westerham/>