



**HENDERSON
CONNELLAN**
ESTATE AGENTS

Wilton Road, Kettering NN15

"Hit the Starter Button"

1 1 1



"Hit the Starter Button"

Launch into home ownership with the fabulous mid mews home situated on the desirable Ise Village. The fresh, well-presented interior includes an entrance vestibule, free flowing Kitchen/Dining/Living Room with patio doors to the garden. Upstairs the landing leads to a principal bathroom and a double bedroom with built in wardrobes. Electric heating and UPVC double glazing compliment the inside. Outside there is a private driveway for one/two cars, lawned foregarden and an established enclosed garden. Shops, amenities and park walks are moments away!

Living/Dining Room/Kitchen - 6.38m x 3.3m (20'11" x 10'10")

Bedroom - 3.33m x 3.28m (10'11" x 10'9")

Bathroom - 2.57m x 1.42m (8'5" x 4'8")



Ground Floor
Approx. 21.1 sq. metres (226.7 sq. feet)



Total area: approx. 42.0 sq. metres (452.3 sq. feet)

First Floor
Approx. 21.0 sq. metres (225.6 sq. feet)

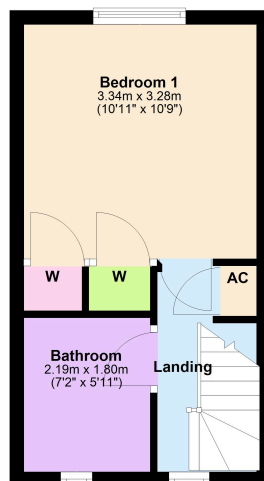

- Mid Mews Home
- Open plan Living
- Kitchen flowing to living/dining room
- One Bedroom room
- Rear Garden and private parking
- No Chain
- COUNCIL TAX: A
- EPC RATING: D



15-16 Market Place, Kettering,
Northamptonshire, NN16 0AJ

Disclaimer: These particulars do not form part of any offer or contract and should not be relied upon as statements or representations of fact. Any areas, measurements of distances are approximate. The text, photographs and plans are for guidance only and are not necessarily comprehensive.

