



ZAFER CETINEL

POWERED BY
exp™
UK

@ zafer.cetinel@exp.uk.com

zafercetinel.exp.uk.com

01242 374 844

Evesham Road, Cheltenham, GL52 3AA

Offers In Region Of £230,000

🛏️ 2 🚿 1 🛋️ 1



- PITTVILLE, CHELTENHAM
- TWO DOUBLE BEDROOMS
- COMMUNAL GARDENS AND PRIVATE ACCESS TO THE PARK
- KITCHEN / DINER / BALCONY
- CHAIN FREE
- TOP FLOOR APARTMENT ATTACHED TO PITTVILLE PARK
- MOST AMAZING VIEWS OF THE PARK
- GARAGE and PARKING
- SEPARATE LOUNGE
- REF ZAFER CETINEL



Stunning Top Floor Apartment in Pittville

Discover this exquisite top-floor apartment in the sought-after Pittville area, featuring private gated access to Pittville Park. Just a short stroll from the town center, this property offers breathtaking views of the park and historic Pump Rooms from every room.

The apartment is easily accessible via a lift and includes a spacious entrance hall with ample storage. It boasts two generous double bedrooms, a comfortable living room, a modern kitchen/diner, and a stylish shower room.

Additional highlights include double glazing, gas central heating, two private balconies, and a garage for secure parking. Chain-free and move-in ready, this property offers a perfect blend of comfort and convenience.

GROUND FLOOR
1087 sq.ft. (101.0 sq.m.) approx.

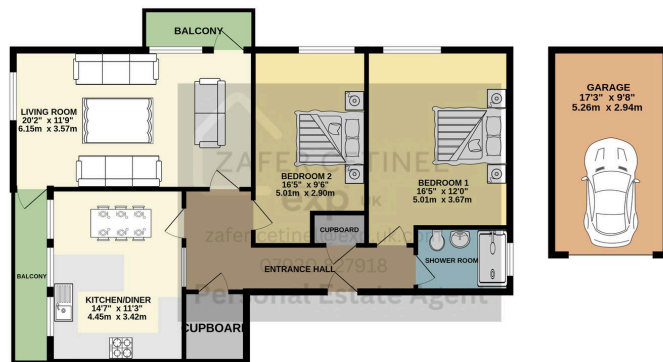

TOTAL FLOOR AREA: 1087 sq.ft. (101.0 sq.m.) approx.
Whilst every attempt has been made to ensure the accuracy of the floorplan contained here, measurements of walls, windows, doors and any other items are approximate and no responsibility is taken for any error, omission or mis-statement. This plan is for illustrative purposes only and should be used as such for any prospective purchase. The services, systems and appliances shown here are not been fitted and no guarantee as to their operability or efficiency can be given.
Issue with drawings 12/02

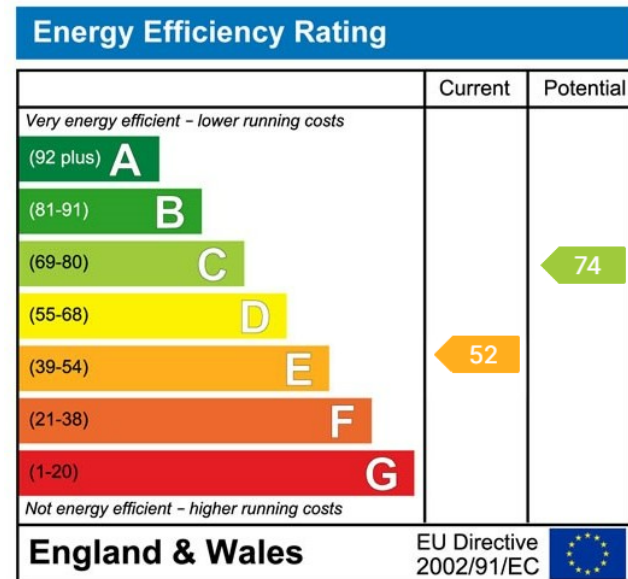

eXp World UK Ltd is a registered company at Level 37, 25 Canada Square, London, E14 5LQ.

Registered company number is 12016573. VAT Registration Number is 327 4120 29