



Ollerton

The Old Stables, Potts Lane



Ollerton, WA16 8SF

Potts Lane

£850,000



The Property

This beautifully presented, substantial, detached former stable has been sympathetically converted, maintained and improved over the years to now provide light, spacious and flexible living accommodation blending character features and modern convenience effortlessly. Particular mention must be made of the refitted Living Dining Kitchen in a contemporary style with breakfast bar and bi-fold doors to the garden, the master bedroom with vaulted ceiling, exposed beams, fitted wardrobes and ensuite shower room as well as the generous reception and bedroom proportions.

Located in a super position on a most sought-after road in the heart of the village, enjoying a lovely outlook and semi-rural surroundings, a short distance to Knutsford town centre and other local amenities whilst being ideally positioned for all major network links to the Northwest and beyond.

The property is approached over a courtyard driveway providing parking and access to the front entrance and integral garage with further parking to the side.

The gardens are a lovely feature of the property, being landscaped in design with an open, attractive outlook. Laid to lawn in the main with a range of well stocked, shaped borders containing a variety of different plants and foliage, all enclosed by brick elevations with trellis fencing giving a high degree of privacy. Stone flagged patio area with pergola covering and stone fireplace provides ideal opportunity for alfresco dining and enjoying the lovely outlook.

Directions

From Knutsford Town Centre proceed down Adams Hill passing the rail station on your left. At the traffic lights proceed straight onto Brook Street continuing onto Chelford Road (A537) for approx 2.7 miles. Take the right turn into School Lane where the property will soon be seen ahead of you on the corner of School Lane/Potts Lane.



- Beautifully presented detached property situated in a lovely semi-rural location
- Spacious & flexible living accommodation
- Living, dining kitchen with integrated appliances & separate utility room
- Downstairs WC
- Four generous bedrooms
- Two bathrooms (one en-suite)
- Stunning, private, enclosed garden
- More than ample off road parking
- Garage

Postcode – WA16 8SG
Tenure – Freehold
Local Authority – Cheshire East
Council Tax – Band G
EPC - G



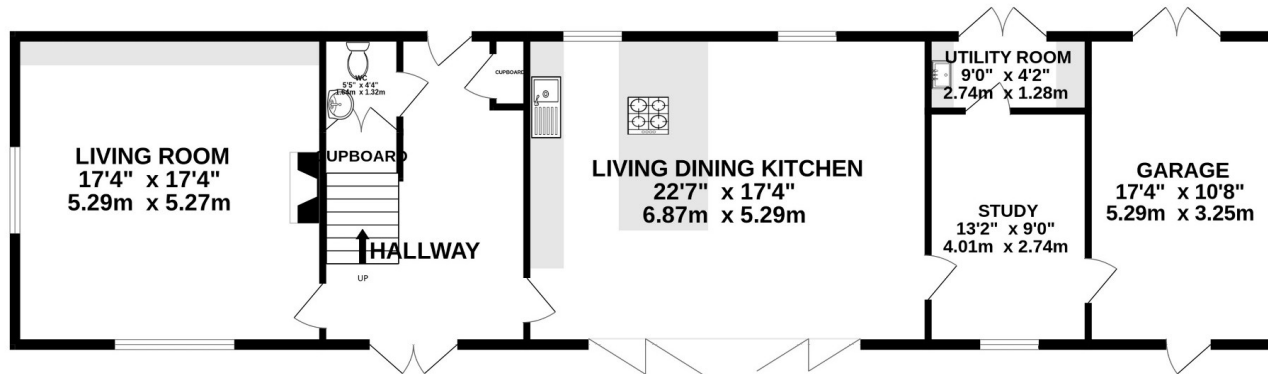

GROUND FLOOR
1225 sq.ft. (113.8 sq.m.) approx.

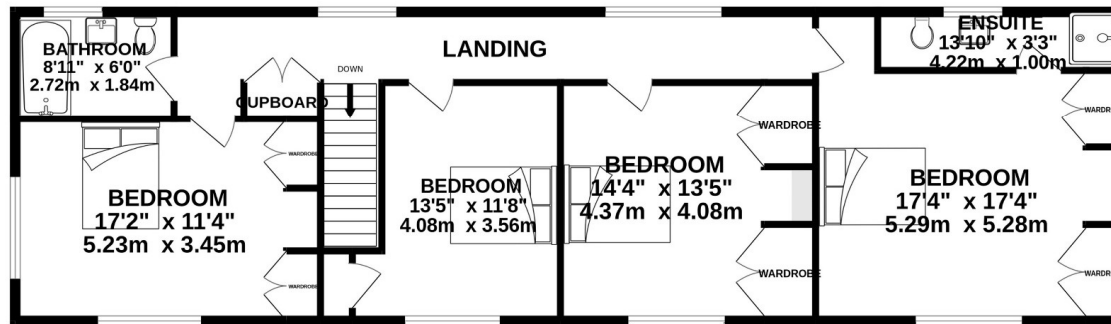

1ST FLOOR
1081 sq.ft. (100.4 sq.m.) approx.

TOTAL FLOOR AREA : 2305 sq.ft. (214.2 sq.m.) approx.

Whilst every attempt has been made to ensure the accuracy of the floorplan contained here, measurements of doors, windows, rooms and any other items are approximate and no responsibility is taken for any error, omission or mis-statement. This plan is for illustrative purposes only and should be used as such by any prospective purchaser. The services, systems and appliances shown have not been tested and no guarantee as to their operability or efficiency can be given.

Made with Metropix ©2026

103 King Street, Knutsford, Cheshire, WA16 6EQ

01565 654 000

E: info@irlamsestateagents.co.uk

www.irlamsestateagents.co.uk

I1021_ Printed by Ravensworth 01670 713330

Irlams (Estate Agents) Ltd for themselves and for the vendors or lessors of this property whose agents they are give notice that:

- (a) The particulars are set out as a general outline only for the guidance of intending purchasers or lessees, and do not constitute, nor constitute part of, an offer or contract;
- (b) All descriptions, dimensions, references to condition and necessary permissions for use and occupation, and other details are given in good faith and are believed to be correct but any intending purchasers or lessees should not rely on them as statements or representations of fact, but must satisfy themselves by inspection or otherwise as to the correctness of each of them;
- (c) No person in the employment of Irlams (Estate Agents) Ltd has any authority to make or give any representation or warranty whatsoever in relation to this property.
- (d) We believe the information above to be accurate at the point it was obtained however you may wish to make a final check with your Solicitor or with us in respect of anything above you feel crucial before you proceed with the purchase of this property.

