

ALLDAY
& MILLER



Cleave Avenue, Hayes, UB3 4EZ
£525,000

3 1 1 D



Cleave Avenue, Hayes, UB3 4EZ

£525,000

- Three Bedroom Home
- Off Street Parking (Rare On The Road)
- Excellent Condition Throughout
- 0.6 Miles From Asda Hayes Superstore
- Over 100 Ft Garden
- Mid Terraced With Rear Access
- Huge Potential For Extension (STPP)
- Five Minute Walk To Elizabeth Line Station
- Highly Desirable Location In The Heart Of Hayes
- Perfect For First Time Buyers & Investors

Description

This immaculate three-bedroom freehold mid-terraced home offers spacious and beautifully maintained accommodation, ideal for modern family living. The property is presented in excellent condition throughout and benefits from a practical layout, rear access, and rare off-street parking for up to two cars — a highly sought-after feature on the road. Further enhancing its appeal is the substantial scope for extension (STPP), providing fantastic potential for future growth and customisation. A superb opportunity for buyers seeking a home that is ready to move into while still offering long-term potential.

Situation

Cleave Avenue situated in the heart of Hayes close to a number of local amenities including Hayes & Harlington station with the popular Elizabeth line, making the journey to Central London a breeze. Transport links are also on hand for Southall, Heathrow, Hounslow, Uxbridge town centre and the M4/M25 motorways. Walking distance to highly regarded schools in the local area including Rosedale School and Woodend Academy. Hayes Town centre just moments away with its variety of local shops, restaurants, cafes, takeaways and coffee shops.



Floor Plans

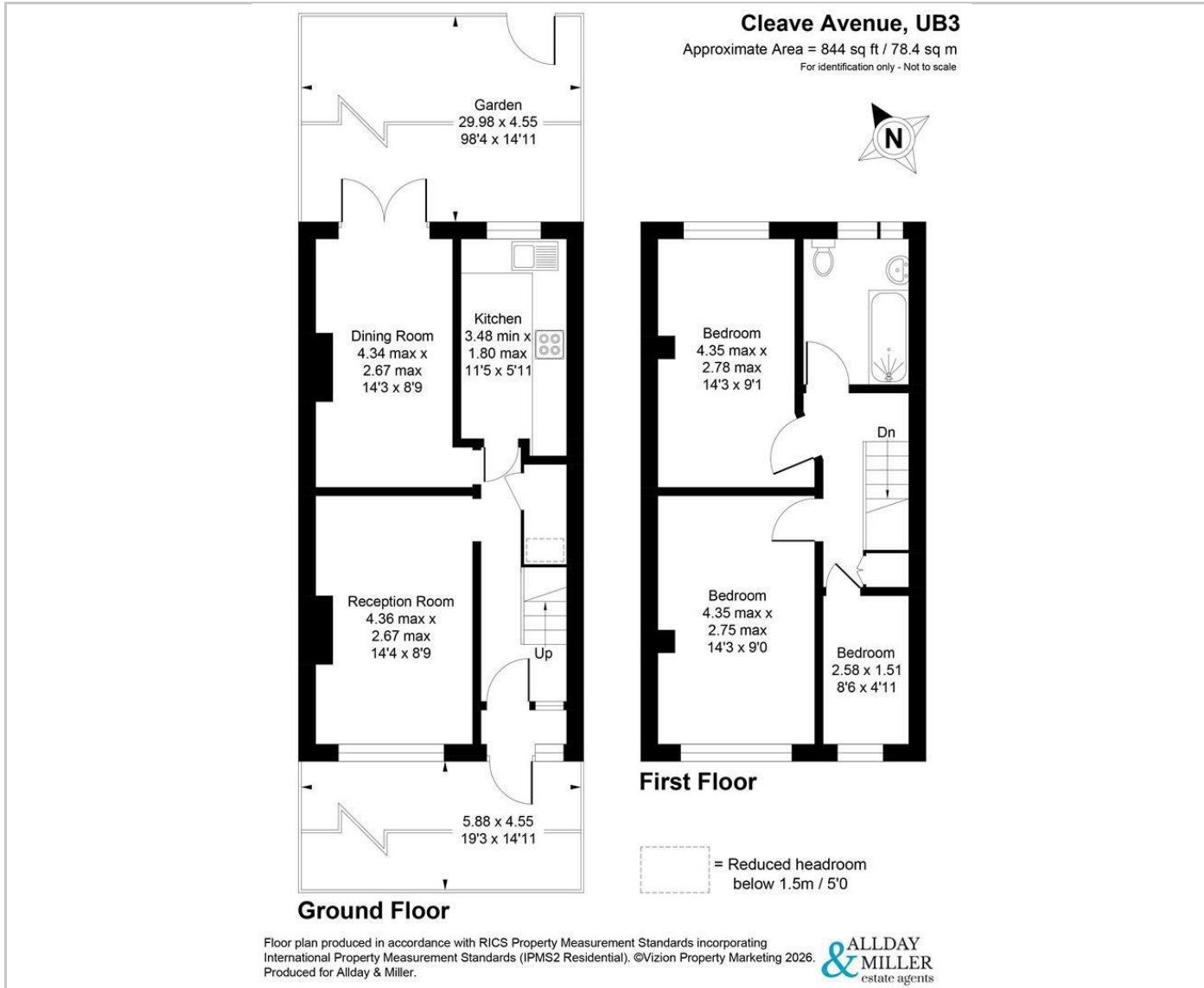

Area Map

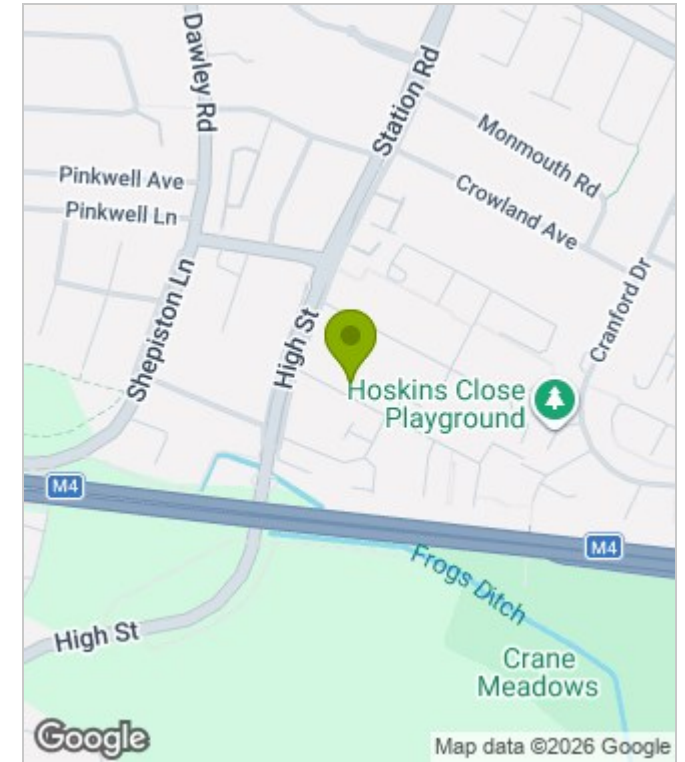

Energy Performance Graph

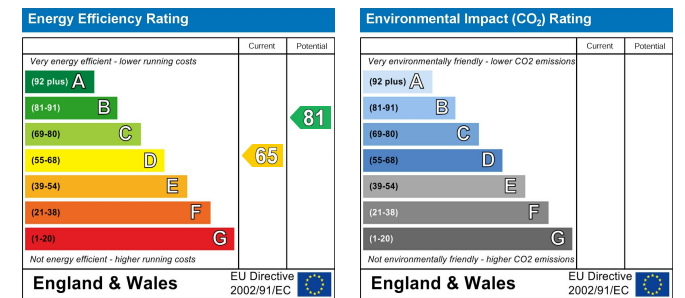

These particulars, whilst believed to be accurate are set out as a general outline only for guidance and do not constitute any part of an offer or contract. Intending purchasers should not rely on them as statements of representation of fact, but must satisfy themselves by inspection or otherwise as to their accuracy. No person in this firm's employment has the authority to make or give any representation or warranty in respect of the property.