

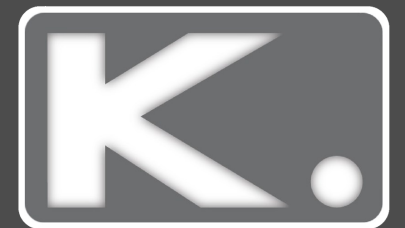

**3 Bed
House - Terraced
located in Hove**

£1,800 PCM



DIRECTIONS

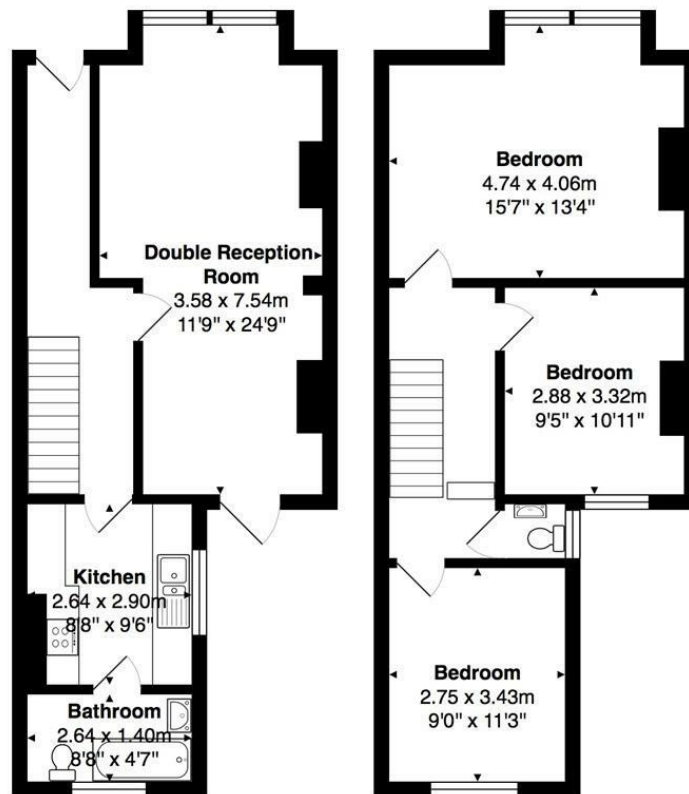

Ground Floor
Area: 46.3 m² ... 498 ft²

First Floor
Area: 47.2 m² ... 508 ft²

Total Area: 93.5 m² ... 1006 ft²

CONTACT

Kendrick Property Services - Brighton
10-12 Lewes Road
Brighton
East Sussex
BN2 3HP

E: lettings@kendrickpropertyservices.co.uk
T: 01273 699600
www.kendrickpropertyservices.co.uk

