



Fellows Road NW3

Parkheat
Sold on Service



Yellow street sign with a red circle and a blue square containing a white 'P'.

Blue parking sign with white text: 'P' in a blue square, 'Permitted to park here', 'Monday - Friday', '9 am - 6.30 pm', 'Residential', '11.30 am - 1.30 pm'.

White pillar with the number '26'.

White pillar with the number '26'.

Green recycling bin with the number '3'.

White sign with black text: 'FEL', 'RO'.

Black and white speed limit sign with the number '20'.



Fellows Road, NW3

Asking Price £842,000

Leasehold

- A delightful, spacious 3 bedroom, 2 bathroom garden apartment
- Set in an impressive detached corner period conversion
- Private and secluded 28ft south facing front garden
- 15ft reception with doors to garden and separate kitchen
- Own entrance on the lower floor - approaching 900 sq ft
- 15ft main bedroom with en suite bathroom
- Large second bedroom and third bedroom with access to small patio
- Plenty of storage
- 171 years from 1984
- Perfectly located for Primrose Hill, Belsize Park, England's Lane and Swiss Cottage



Parkheath
Sold on Service

Camden Tax band F

Belsize Park/Hampstead
208 Haverstock Hill
NW3 2AG
Sales 020 7431 1234
Lettings 020 7431 3104
nw3@parkheath.com

South/West Hampstead
192 West End Lane
NW6 1SG
Sales & Lettings
Tel 020 7794 7111
192@parkheath.com

Kensal Rise
54-56 Chamberlayne Rd
NW10 3JH
Tel 020 8960 4845
kensal@parkheath.com

Property Management
192 West End Lane
NW6 1SG
020 7433 6174
pm@parkheath.com

www.parkheath.com

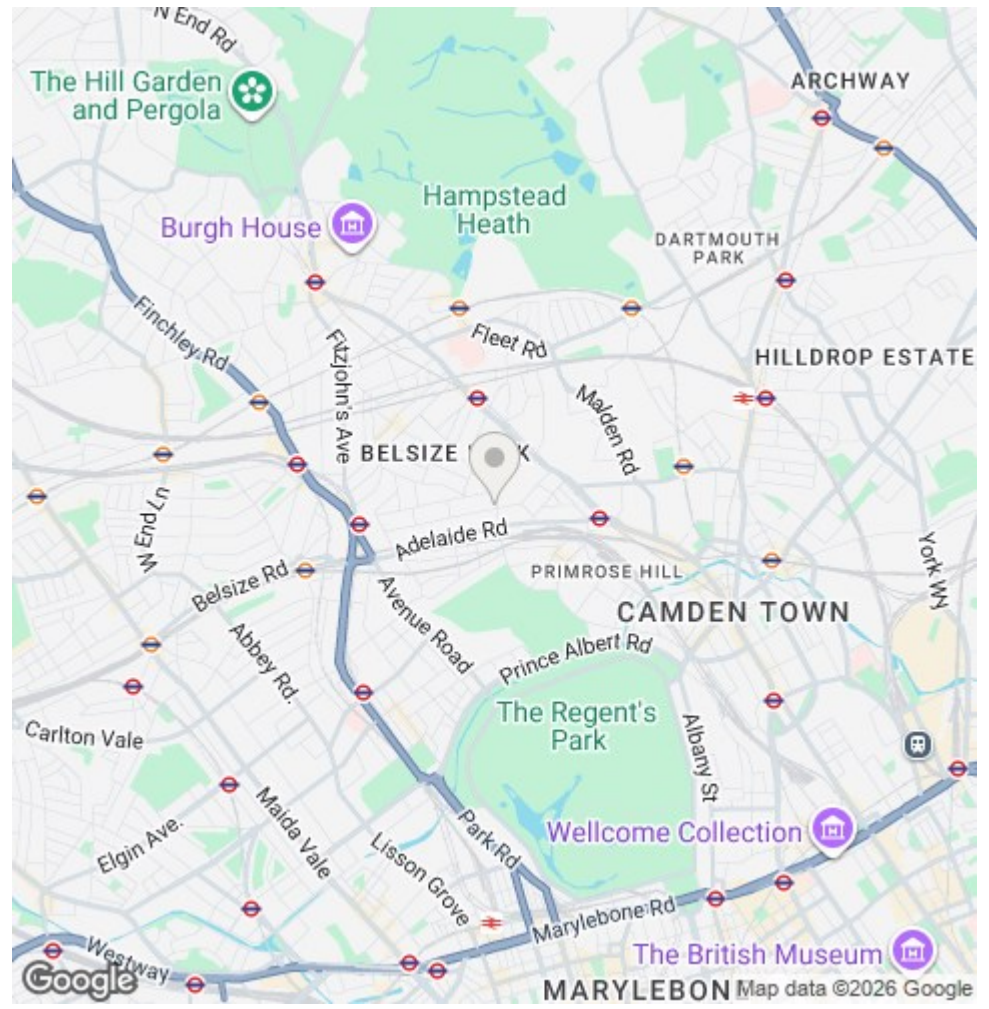
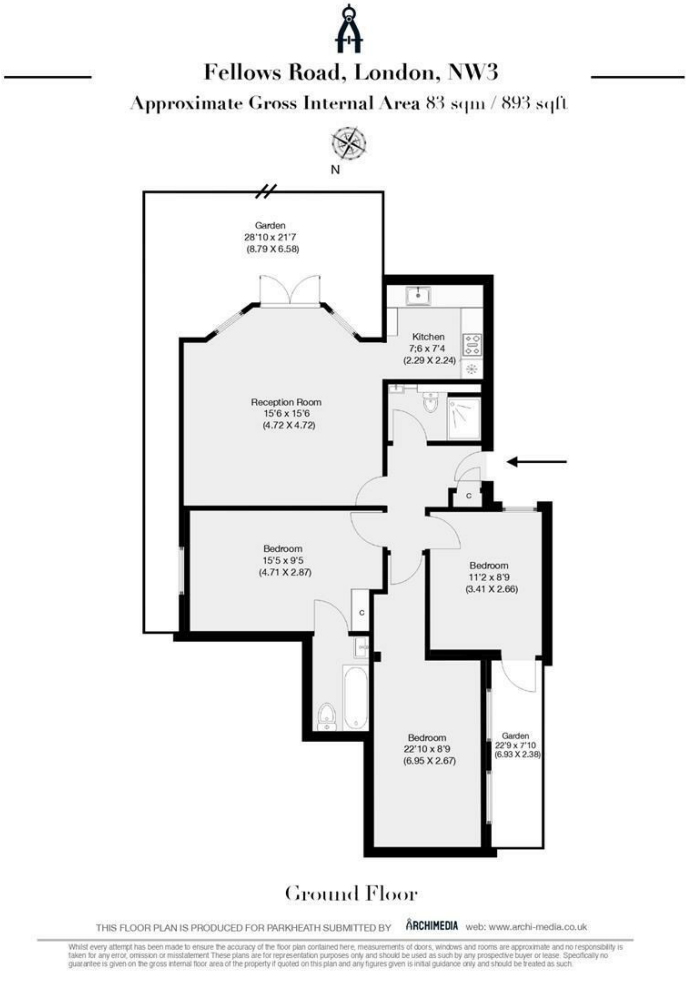

The particulars do not constitute part of an offer or contract. The particulars, including text, photographs and plans, are for the guidance only of prospective purchasers/tenants and must not be relied upon as statements of fact. The descriptions provided therein represent the opinion of the author and whilst given in good faith should not be construed as statements of fact. Nothing in these particulars shall be deemed a statement that the property is in good condition or otherwise or that any services or facilities are in good working order. All measurements are approximate