

Towers Wills

Town & Country

📞 01935 577 032 | 01460 298 530 | ✉ info@towerswills.co.uk



The Orangery, 4 Penn Hill, Yeovil, Somerset BA20 1SB

£175,000

Towers Wills offer for sale this beautiful Georgian orangery conversion! Stunning views across parkland! Forming part of a larger Grade II house conversion! With off road parking tucked away yet walking distance of Yeovil Town centre, Doctors Surgery and local amenities. Beautifully presented throughout this is truly a unique property. A great bungalow alternative! The property is accessed by a gentle slope which leads to the accommodation which is arranged over a ground floor private entrance hallway, large light open plan living area, kitchen, shower room, double bedroom, allocated parking space and communal lawned gardens on the edge of Yeovil Country Park.

Accommodation:

Nestled quietly behind sweeping parkland yet just moments from Yeovil's town centre, The Orangery offers a rare opportunity to purchase a truly unique single-storey home of outstanding character. Forming part of an elegant Grade II listed Georgian residence, this beautifully converted orangery enjoys glorious, uninterrupted views across Yeovil Country Park towards Ninesprings—an ever-changing natural backdrop framed by the property's exquisite arched period windows.

Gently approached via a sweeping, wheelchair-friendly pathway, the property immediately impresses with its private entrance and charming patio terrace enclosed by wrought-iron railings, hamstone pillars and vibrant planting. This is an idyllic spot to relax, dine or entertain while absorbing the tranquillity of the surrounding parkland.

Inside, the accommodation is arranged entirely on the ground floor, making it a fantastic alternative to bungalow living. A welcoming reception hallway—with its distinctive period arch window—sets the tone for the home's character and quality. Double doors open to a large utility cupboard with space for laundry appliances, complemented by an additional storage cupboard.

The heart of the property is the stunning open-plan living space, flooded with natural light and enjoying captivating views through its orangery windows. Seamlessly connected to the well-appointed kitchen, the space features stone-effect work surfaces, breakfast bar, larder units, integrated oven and hob, fridge, dishwasher, wine rack, and under-cupboard lighting—perfect for both everyday living and entertaining.

The master bedroom, occupying the second half of the original orangery, continues the theme of elegance with multiple arched windows overlooking the park, complete with secondary glazing to ensure peace and comfort. The modern shower room offers a fresh, stylish suite with part-tiled walls, shower cubicle, extractor fan and arched side window.

Externally, the property benefits from allocated off-road parking for one vehicle and sits just a short walk from shops, doctors' surgery, and local amenities—perfectly blending convenience with serenity. Offered to the market with vacant possession and no onward chain, The Orangery presents an exceptional chance to secure a beautifully presented, character-rich home in one of Yeovil's most picturesque settings.

A truly special property—rarely available and hard not to fall in love with.

Agents Note:

The property has a share of the freehold with 5 properties and the yearly cost for ground rent/service charges is approximately £400 per year.

Key Features

- Converted Georgian Orangery
- Ground Floor Accommodation
- One Bedroom
- Grade II Listed
- Private Entrance
- Allocated Parking

Contact Us

Towers Wills Estate Agents - Yeovil

114, Hendford Hill

Yeovil

Somerset

BA202RF

T: 01935 577032

E: info@towerswills.co.uk



Floor Plan

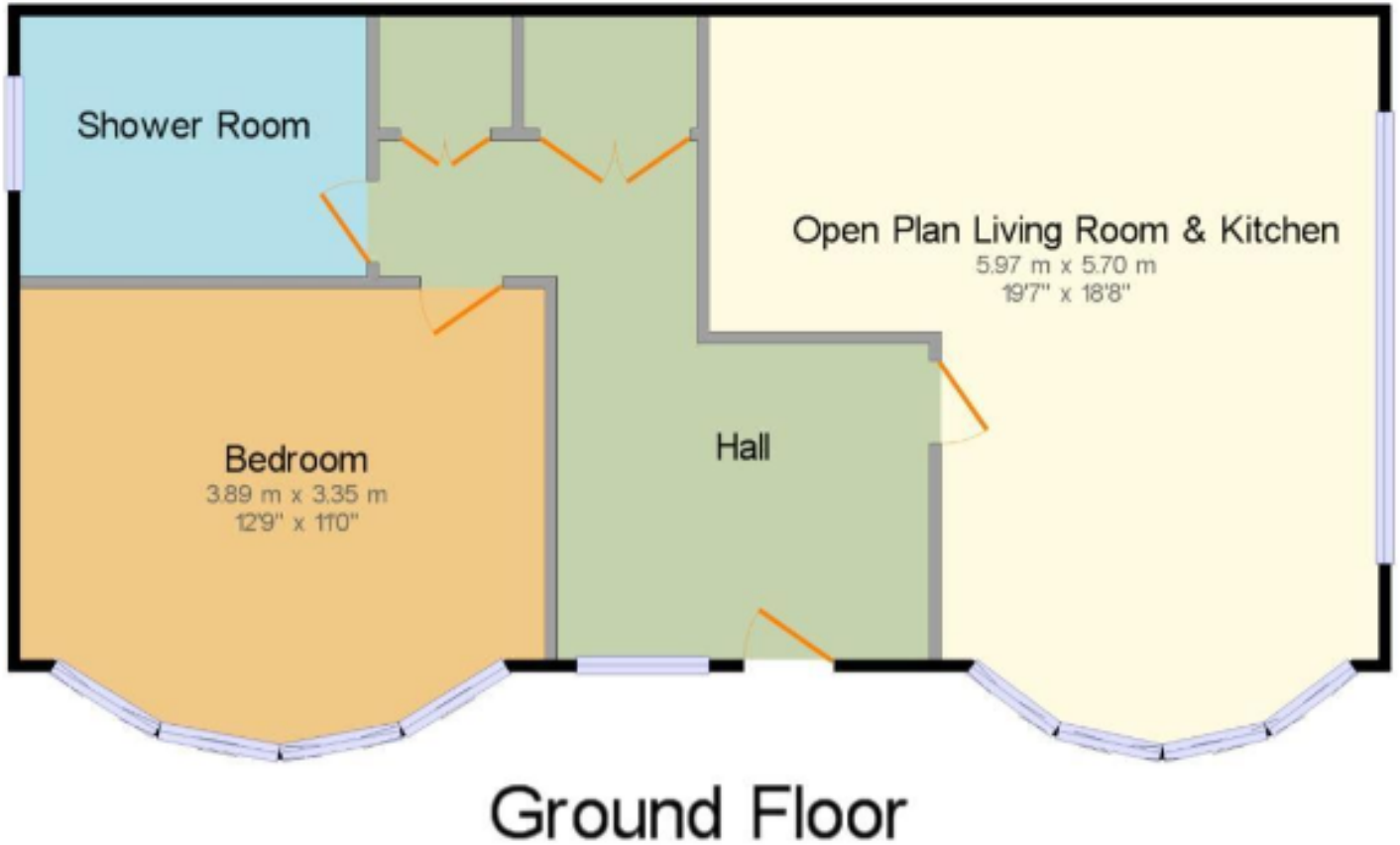

Please Note No tests have been undertaken of any of the services and any intending purchasers should satisfy themselves in this regard. Towers Wills Ltd for themselves and for the vendor of this property whose agents they are, give notice that, (i) these particulars do not constitute any part of an offer or contract, (ii) all statements contained within these particulars are made without responsibility on the part of Towers Wills or the vendor, (iii) whilst made in good faith, none of the statements contained within these particulars are to be relied upon as a statement of representation or fact, (iv) any intending purchaser must satisfy him/herself by inspection or otherwise as to the correctness of each of the statements contained within these particulars, (v) the vendor does not make or give either Towers Wills or any person in their employment any authority to make or give representation or warranty whatsoever in relation to this property.

Photographs / Floor Plans Photographs are reproduced for general information and it must not be inferred that any item is included for sale with this property. Please note floor plans are not to scale and are for identification purposes only. The photographs used in these particulars may have been taken with the use of a wide angle lens. If you have any queries as to the size of the accommodation or plot, please address these with the agent prior to making an appointment to view

Towers Wills

The White House, 114 Hendford Hill, Yeovil BA20 2RF

Yeovil 01935 577032 / South Petherton 01460 298530

info@towerswills.co.uk | www.towerswills.co.uk