



Mervyn Road, W13

£1,200,000

Dexters



Mervyn Road, W13

An impressive five bedroom Edwardian house located in this favoured Northfields location in catchment for Ofsted outstanding schools.

Recently redecorated and ready for purchasers to just move in and unpack. Many benefits include a West facing garden and scenic views of the green of West Ealing Bowls Club.

You will find this handsome house on the West side of this quiet residential road.

The reception hall brings you through to two interconnecting reception rooms which enjoy lots of natural light. There is a neat breakfast room before you find the modern fitted kitchen.

On the first floor, there are two double bedrooms and the well fitted main bathroom with two further bedrooms and a shower room on the top floor. Both upper floors have West facing views of Playing fields and the Bowls Green.

In catchment for outstanding schools including Fielding Primary and Elthorne High School with the Piccadilly line within walking distance.

Features

- Edwardian House
- Five Bedrooms
- Three Reception Rooms
- West Facing Garden
- Excellent Schools
- No Onward Chain







Mervyn Road, London, W13

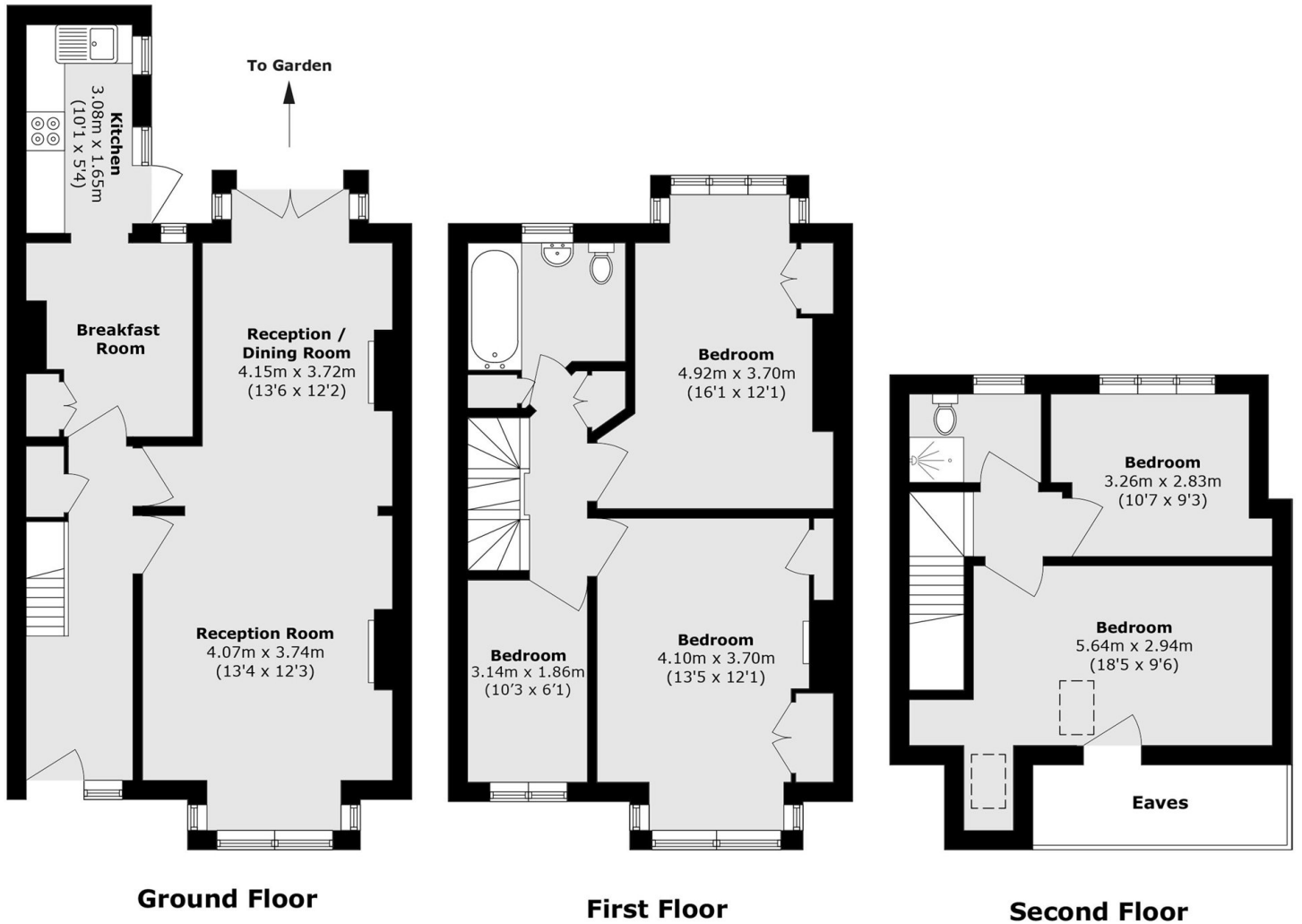

Total area (approx.): 137.9 sq. m (1484.3 sq. ft)

(Excluding Eaves)