



**Wheatley Road, WELWYN GARDEN CITY AL7 3LL**



**welcome to**

## **Wheatley Road, WELWYN GARDEN CITY**

This spacious two-bedroom semi-detached family home is conveniently located just over a mile from Welwyn Garden City town centre and its mainline train station with direct routes into London Kings Cross and Moorgate. Swallow Dell Primary School is only a short walk away, making this an ideal choice for families. The ground floor features an inviting entrance hall, a modern downstairs bathroom, a bright lounge with French doors opening onto the rear garden, and a fully fitted kitchen. Upstairs, the first floor offers two well-proportioned bedrooms and a useful W/C.

Externally, the property benefits from both front and rear gardens as well as a driveway providing EV charging point and off-street parking for multiple vehicles. Additional advantages include gas central heating, double glazing throughout, and excellent scope to extend (STPP).



### Lounge/Diner

15' 11" x 12' 9" ( 4.85m x 3.89m )

Double glazed window to rear, French doors to garden, wooden flooring, spotlights, storage cupboard.

### Kitchen

8' 6" x 7' 11" ( 2.59m x 2.41m )

Double glazed window to front, laminate wood flooring, electric oven, induction hob, sink/drain, heated towel rail.

### Downstairs Bathroom

Double glazed window to front, vinyl flooring, W/C, wash hand basin, spotlights.

### Bedroom One

15' 7" x 11' 9" ( 4.75m x 3.58m )

Double glazed window to front and side, carpet, radiator.

### Bedroom Two

10' x 7' 10" ( 3.05m x 2.39m )

Double glazed window to rear, carpet, radiator.

### Upstairs W/C

Double glazed window, W/C, wash hand basin, boiler cupboard.

### Outbuilding

Laminate wood flooring, electrics, extractor fan.

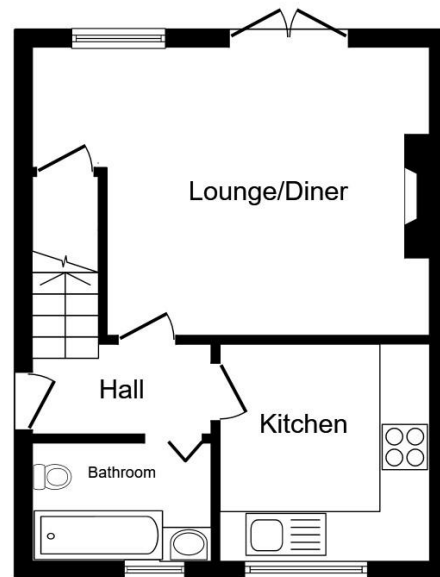

**Ground Floor**

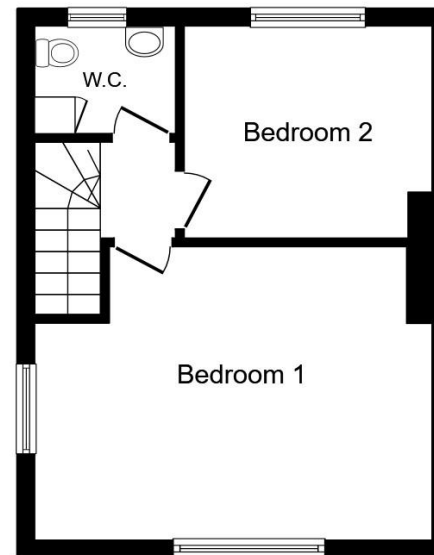

**First Floor**

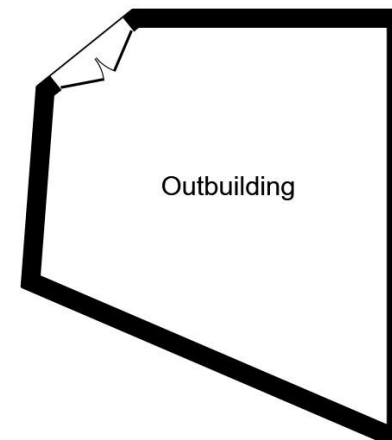

**Outbuilding**

Total floor area 75.0 m<sup>2</sup> (807 sq.ft.) approx

This floor plan is for illustrative purposes only. It is not drawn to scale. Any measurements, floor areas (including any total floor area), openings and orientation are approximate. No details are guaranteed, they cannot be relied upon for any purpose and they do not form part of any agreement. No liability is taken for any error, omission or misstatement. A party must rely upon its own inspection(s). Powered by [www.propertybox.io](http://www.propertybox.io)

  
william  
h brown



**check out more properties at** [williamhbrown.co.uk](http://williamhbrown.co.uk)





welcome to

## Wheatley Road, WELWYN GARDEN CITY

- Semi Detached House
- Two Bedrooms
- Downstairs Bathroom & Upstairs W/C
- Driveway for Multiple Cars
- Landscaped Rear Garden

Tenure: Freehold EPC Rating: D  
Council Tax Band: C



guide price

**£400,000**



check out more properties at [williamhbrown.co.uk](http://williamhbrown.co.uk)



Property Ref:  
WGN109470 - 0003

1. MONEY LAUNDERING REGULATIONS Intending purchasers will be asked to produce identification documentation at a later stage and we would ask for your co-operation in order that there is no delay in agreeing the sale. 2. These particulars do not constitute part or all of an offer or contract. 3. The measurements indicated are supplied for guidance only and as such must be considered incorrect. Potential buyers are advised to recheck measurements before committing to any expense. 4. We have not tested any apparatus, equipment, fixtures or services and it is in the buyers interest to check the working condition of any appliances. 5. Where an EPC, or a Home Report (Scotland only) is held for this property, it is available for inspection at the branch by appointment. If you require a printed version of a Home Report, you will need to pay a reasonable production charge reflecting printing and other costs. 6. We are not able to offer an opinion either written or verbal on the content of these reports and this must be obtained from your legal representative. 7. Whilst we take care in preparing these reports, a buyer should ensure that his/her legal representative confirms as soon as possible all matters relating to title including the extent and boundaries of the property and other important matters before exchange of contracts.

William H Brown is a trading name of Sequence (UK) Limited which is registered in England and Wales under company number 4268443, Registered Office is Cumbria House, 16-20 Hockliffe Street, Leighton Buzzard, Bedfordshire, LU7 1GN. VAT Registration Number is 500 2481 05.

  
william h brown



**01707 324361**



[WelwynGardenCity@williamhbrown.co.uk](mailto:WelwynGardenCity@williamhbrown.co.uk)



53 Wigmores North, WELWYN GARDEN CITY,  
Hertfordshire, AL8 6PG



**[williamhbrown.co.uk](http://williamhbrown.co.uk)**

Please note the marker reflects the  
postcode not the actual property