



**POOLE  
TOWNSEND**

# Newton Road, Dalton-in-Furness, LA15 8NF

£199,950

3 1 1



Situated in a popular residential area just outside Dalton town centre, this well-presented family home offers convenient access to local schools, bus routes, Morrisons Daily, the Newton Arms pub and nearby amenities. Set back from the road, the property features an enclosed front garden and a spacious open plan lounge and dining area with views to both front and rear, a feature fireplace and access to the patio, alongside a modern fitted kitchen with grey gloss units. Upstairs provides three bedrooms, including a main room with fitted storage, and a family bathroom. Externally, there is a gated driveway leading to a detached garage and a low-maintenance rear garden with colourful borders and a greenhouse. Further benefits include gas central heating, double glazing and no upper chain.

### Location

What3Words///greet.midwinter.insert

### Description

Situated in a popular residential area just outside Dalton town centre, this well-proportioned family home enjoys a convenient position on a local bus route and close to highly regarded primary schools, Morrisons Daily and Newton Arms pub. The town centre itself is only a short commute away, making this an ideal setting for families seeking both accessibility and a sense of community.

Set back from the road, the property features an enclosed front garden finished with decorative stone chippings and bordered planting. Stepping inside, the hallway provides a welcoming introduction, with a staircase directly ahead, useful under-stairs storage, and access into the main living accommodation.

The open plan lounge and dining room extends the full depth of the property, creating a bright and versatile living space with views over both the front and rear gardens. The lounge area features a polished fireplace with hearth and an open-fronted gas fire, forming a cosy focal point. To the rear, the dining area benefits from direct access to the patio and a bi-folding door that opens into the modern kitchen.

The kitchen is fitted with a range of wall and base units in a sleek



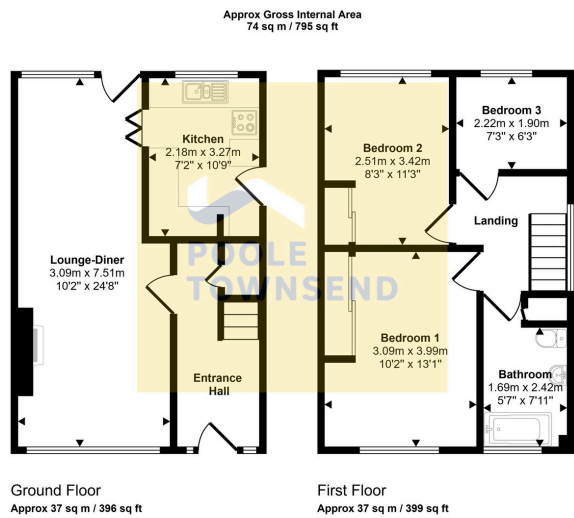

This floorplan is only for illustrative purposes and is not to scale. Measurements of rooms, doors, windows, and any items are approximate and no responsibility is taken for any error, omission or mis-statement. Icons of items such as bathroom suites are representations only and may not look like the real items. Made with Made Snappy 360.

- 3 Bed Semi-Detached House
- Close To Local Amenities
- No Upper Chain
- Featuring A Enclosed Front Garden
- A spacious Open Plan Lounge/dining Area
- A Modern Fitted Kitchen
- A Family Bathroom
- A Gated Driveway
- A Detached Garage And Low Maintenance Rear Garden
- Double Glazing

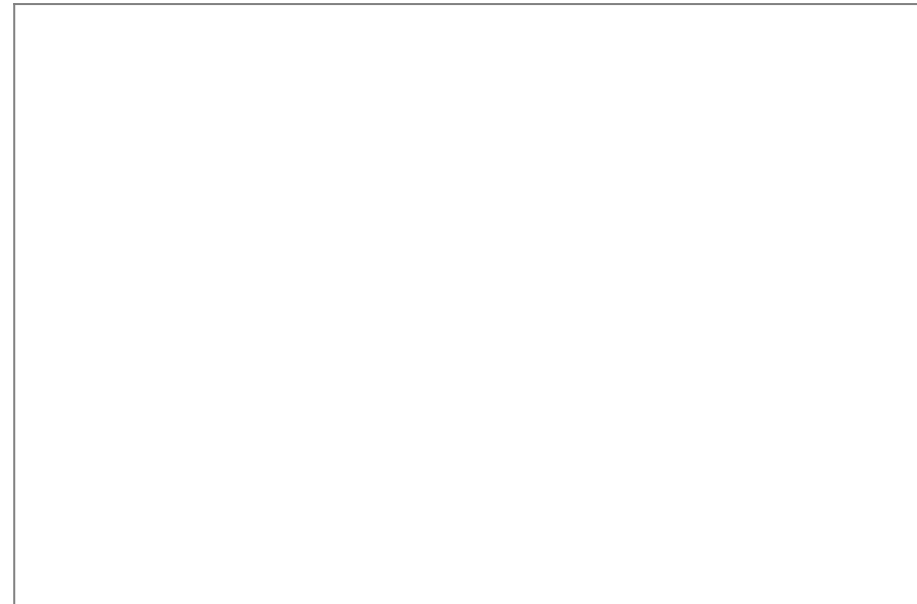

Visit us at  
[www.pooletownsend.co.uk](http://www.pooletownsend.co.uk)  
[enquiries@pooletownsend.co.uk](mailto:enquiries@pooletownsend.co.uk)

We are open  
 Monday – Friday 9.00 – 5.00  
 Saturday 9.00 – 1.00

Barrow 01229 811811  
 Ulverston 01229 588111  
 Grange 015395 33316  
 Kendal 01539 734455  
 Milnthorpe 015395 62044