



Hendre Farm Drive, offers over £200,000

- Semi-detached home
- Bright Living & dining area
- Converted Loft
- Good size garden with side access
- Council tax band B
- EPC Rating: D



 4  1  1



About the property

This inviting semi-detached property offers generous and versatile living accommodation arranged over three floors, making it a fantastic choice for families or anyone seeking extra space. The ground floor features a bright and welcoming living and dining area, providing a comfortable open space ideal for both everyday living and entertaining. The adjoining kitchen is well laid out, offering good storage and practical workspace while maintaining a natural flow throughout the home.

The first floor comprises three well-proportioned bedrooms, suitable for a range of uses such as children's rooms, guest accommodation, or a home office. A family bathroom also sits on this level, serving the household with convenience and functionality.

Adding to the home's appeal is the converted loft, which provides an additional bedroom. This versatile space is perfect as a master bedroom, teenager's room, or a quiet retreat separate from the main living areas.

Outside, the property boasts a spacious rear garden—ideal for outdoor dining, play, or gardening enthusiasts. The wide side entrance enhances accessibility and offers excellent potential for storage or future improvements. On-street parking is available directly outside the property, making day-to-day life easy and convenient.

The home falls within Council Tax Band B and has an EPC Rating of D, offering a good balance of affordability and energy efficiency.



Accommodation

Entrance Hall

14' 7" x 14' 1" (4.45m x 4.29m)

Living & Dining Room

Garden

19' 8" x 11' 6" (5.99m x 3.51m)

Kitchen

18' 4" max x 11' 1" max (5.59m max x 3.38m max)

Landing

Bedroom 2

11' 6" x 10' 10" (3.51m x 3.30m)

Bedroom 3

13' 5" x 5' 11" (4.09m x 1.80m)

Bedroom 4

10' 10" x 6' 7" (3.30m x 2.01m)

Bathroom

Landing

Bedroom 1

01633 221892

newport@peteralan.co.uk

Floorplan

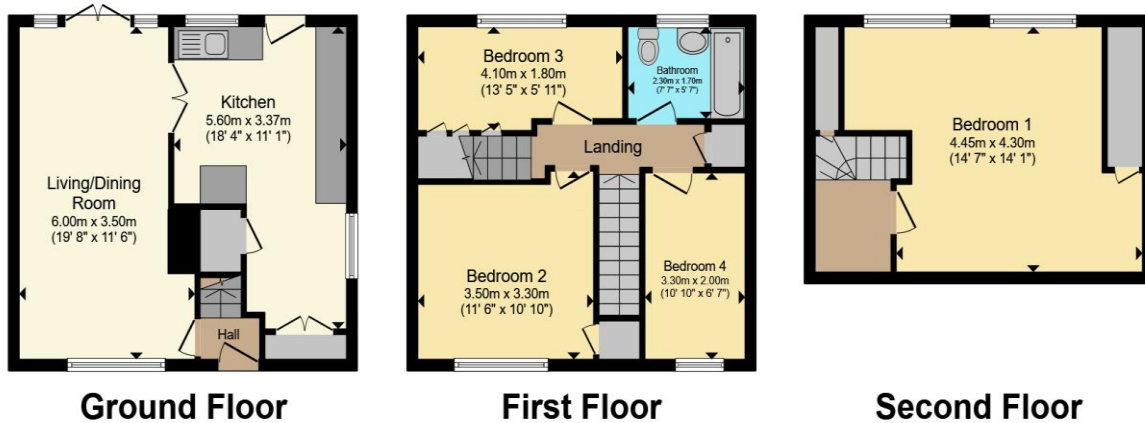

Total floor area 105.5 m² (1,136 sq.ft.) approx

This floor plan is for illustrative purposes only. It is not drawn to scale. Any measurements, floor areas (including any total floor area), openings and orientation are approximate. No details are guaranteed, they cannot be relied upon for any purpose and they do not form part of any agreement. No liability is taken for any error, omission or misstatement. A party must rely upon its own inspection(s). Powered by www.propertybox.io



Important Information

Note while we endeavour to make our sales details accurate and reliable, if there is any point which is of particular interest to you, please contact the office and we will be pleased to confirm the position for you. We have not personally tested any apparatus, equipment, fixtures, fittings or services and cannot verify they are in working order or fit for their purposes. Nothing in these particulars is intended to indicate that carpets or curtains, furnishings or fittings, electrical goods (whether wired or not). Gas fires or light fittings or any other fixtures not expressly included form part of the property offered for sale. This computer generated Floorplan, if applicable, is intended as a general guide to the layout and design of the property. It is not to scale and should not be relied upon for dimensions. Tenure: We cannot confirm the tenure of the property as we have not had access to the legal documents. The buyer is advised to obtain verification from their solicitor or surveyor.

Peter Alan Limited is registered in England and Wales under company number 2073153. Registered Office is Cumbria House, 16-20 Hockliffe Street, Leighton Buzzard, Bedfordshire, LU7 1GN. VAT Registration Number is 500 2481 05. For activities relating to regulated mortgages and non-investment insurance contracts, Peter Alan Limited is an appointed representative of Connells Limited which is authorised and regulated by the Financial Conduct Authority. Connells Limited's Financial Services Register number is 302221. Most buy-to-let

