



## Ravensdon Street, SE11

£375,000

A fantastic one bedroom raised ground floor home comprising of a reception room to the front, a separate kitchen to the rear and high ceilings throughout. Due to its central location this would be a brilliant pied a terre. Furthermore the property has high ceilings, good storage a long lease and it is being sold with no onward chain.

In the centre of Kennington, Ravensdon Street is quietly tucked away and just moments from a number of pubs, eateries and local shops. High in community spirit, this perfect Kennington location has great access to transport links that are unbeatable with Kennington, Oval and Vauxhall stations close by, within a short stroll of Kennington Park and within easy reach of the City and West End.

### Features

- One Bedroom
- Raised Ground Floor
- No Onward Chain
- High Ceilings
- Excellent Location
- Long Lease

# Ravensdon Street, LONDON, SE11

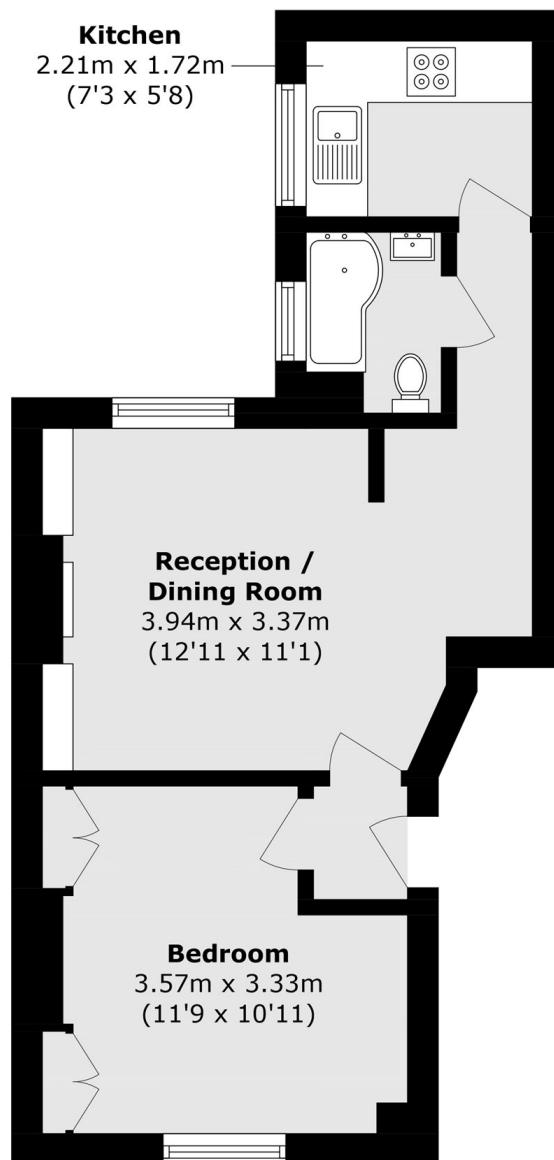

Total area (approx.): 35.8 sq. m (385.3 sq. ft)