

35 Wychwood Close, Milton Under Wychwood OX7 6JB

Witney Market Square c. 11.1 miles. Oxford c. 22 miles. Charlbury Rail station c. 7 miles. Offered 'For Sale' with NO ONWARD CHAIN and situated in a popular village, an extended 2 bedroom semi-detached bungalow. The accommodation has been extended to the rear, which has enlarged both bedrooms, and there is a conservatory across the back of the bungalow. Gas central heating is installed. There are modest-size gardens and the further advantage of a driveway and garage to the side, although an adjustment to the drive is necessary to make it fully functioning. Properties built pre-2000 may contain asbestos in certain materials used in their construction or in subsequent building work. Examples of these materials are; Artex, vinyl tiles, sheet boards, corrugated roofing, pipework and lagging/insulation. These are generally considered safe unless disturbed but prospective buyers must take their own advice.

**THOMAS
MERRIFIELD**

SALES LETTINGS

e. witney@thomasmerrifield.co.uk

t. 01993 772000

Price £285,000

www.thomasmerrifield.co.uk



35 Wychwood Close, Milton-Under-Wychwood, Oxfordshire OX7 6JB

- Kitchen
- Living Room
- Conservatory
- 2 Bedrooms
- Shower Room
- Modest Size Gardens
- Garage
- Gas Central Heating
- Popular Village Location
- No Onward Chain

Approach Milton Under Wychwood from Shipton Under Wychwood. After the Murco garage turn left into Frog Lane, which becomes The Sands. Turn left (also The Sands), which becomes Jubilee Lane. Turn right into Wychwood Drive. Take the second right cul-de-sac into Wychwood Close. Number 35 is facing you - marked by a Thomas Merrifield For Sale Board. 02D26 All mains services. Ultrafast broadband available. Mobile & data: 'EE' - 73% performance (Source: Ofcom).

35 Wychwood Close, Milton under Wychwood

Total Approx. Floor Area 966 Sq.Ft. (89.70 Sq.M.)

All items illustrated on this plan are included in the "Total Approx Floor Area"

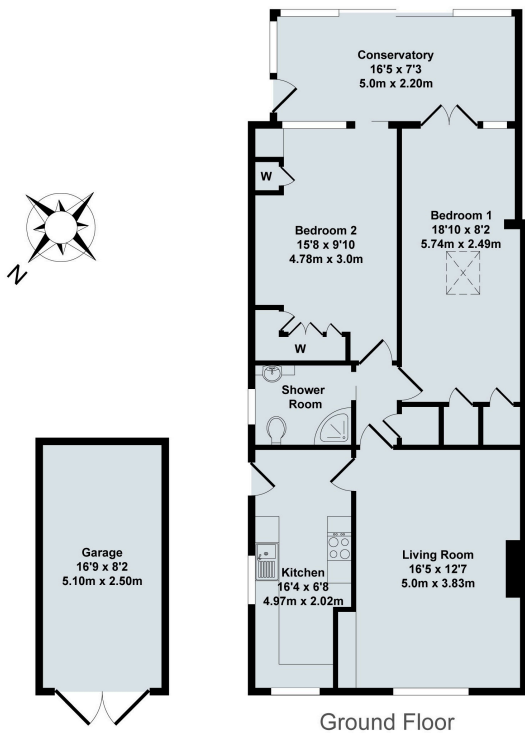

Local Authority:

WODC Tax Band: C / EPC Rating: 61/D.

Contact:

52 Market Square, Witney,
Oxfordshire, OX28 6AF

Tenure:

Freehold

Tel: 01993 772000

Email: witney@thomasmerrifield.co.uk

Important Notice

Thomas Merrifield for themselves and their clients give notice that:-

1. They are not authorised to make or give representation or warranty in relation to this property, either on their own behalf or on behalf of the Seller. They assume no responsibility for any statement made in these particulars. These particulars do not form part of any offer or contract and must not be relied upon as statements or representations of fact.
2. Whilst every attempt has been made to ensure the accuracy of the floorplan contained here, measurements of doors, windows, rooms and any other items are approximate and no responsibility is taken for any error, omission, or mis-statement.
3. All areas, measurements or distances are approximate. The particulars are intended for guidance only and are not necessarily comprehensive. A wide angle lens may have been used in photography. Thomas Merrifield have not tested appliances or services and it should not be assumed that the property has all necessary planning, building regulation and other consents. Buyers must satisfy themselves with the property by inspection or otherwise.
4. Reference to any mechanical or electrical equipment does not constitute a representation that such equipment is capable of fulfilling its function and prospective Buyers must make their own enquiries.
5. They have no responsibility for any expenses or costs incurred by prospective Buyers in inspecting properties which have been sold, let or withdrawn. Applicants are advised to contact the Agent to check availability and any other information of particular importance to them, prior to inspecting the property, particularly if travelling some distance.