



FOR SALE

Kentish Town Road, Kentish Town NW5

PRICE £385,000



Kentish Town Road, Kentish Town NW5

PRICE £385,000

This well-presented first-floor one double bedroom apartment offers exceptionally well-balanced and thoughtfully arranged living accommodation, making it an ideal choice for first-time buyers, professionals, or savvy investors. The property boasts a bright and airy open-plan kitchen and reception room, perfect for both relaxing and entertaining, complemented by a generously sized double bedroom and a modern, well-appointed bathroom.

Flooded with natural light and offering a comfortable, welcoming atmosphere throughout, this apartment combines practicality with contemporary living. Its intelligent layout maximises space and functionality, creating a home that feels both stylish and easy to live in.

Perfectly positioned just moments from Camden Town and Kentish Town Northern Line Underground stations, the property also benefits from superb transport links via Kentish Town Thameslink and Kentish Town West Overground, providing fast and convenient access across London. Residents can enjoy an exciting array of independent shops, cafés, restaurants, pubs, and green spaces, all within easy walking distance, truly offering the best of vibrant North London living.

With its fantastic location, excellent transport connections, and strong rental potential, this is a must-see property.







385,000.00



1 Bedroom



Leasehold



1 Bathroom



London Borough of Camden



1 Reception



Council Tax Band



EPC Band



Parking

KENTISH TOWN | 189 Kentish Town Rd | London | NW5 2JU | T: 020 7284 1222 | hello@oliverstown.com

ASSOCIATED MAYFAIR | 121 Park Lane | London | W1K 7AG | T: 020 3368 8602 | hello@oliverstown.com

FIRST FLOOR
448 sq.ft. (41.6 sq.m.) approx.

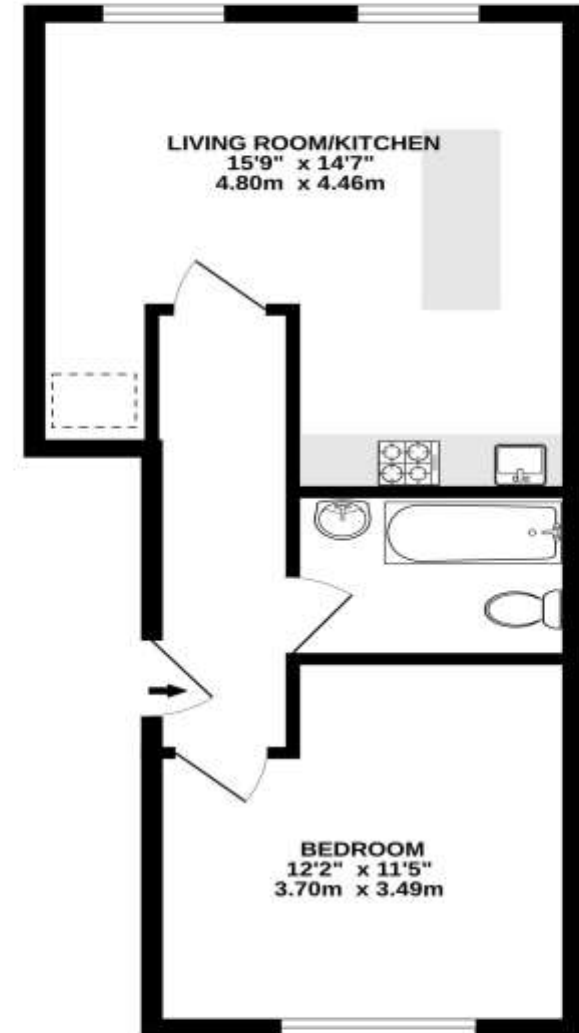

TOTAL FLOOR AREA : 448sq.ft. (41.6 sq.m.) approx.

Whilst every attempt has been made to ensure the accuracy of the floorplan contained here, measurements of doors, windows, rooms and any other items are approximate and no responsibility is taken for any error, omission or mis-statement. This plan is for illustrative purposes only and should be used as such by any prospective purchaser. The services, systems and appliances shown have not been tested and no guarantee as to their operability or efficiency can be given.
Made with Metropex ©2024

