



64A Paxton Crescent

Armthorpe, Doncaster, DN3 2AW

Asking Price £150,000

Situated within this popular and convenient location, a larger style 3 bedroom semi detached house, offering well appointed accommodation ideal for young family or first time buyer.

Briefly comprises; hall, cloaks / WC, good sized dining kitchen with appliances,

First floor ; 3 well proportioned bedrooms and bathroom with shower.

Outside; driveway to the side provides off road parking, further parking to front. Well enclosed rear garden.

- larger styled modern 3 bedroom semi with private off road parking
- walking distance to a host of local amenities within Armthorpe
- great for commuting, with easy access to M18 / M180
- ideal for young family / first time buyer
- approx 4 miles to City Centre and mainline railway
- well presented throughout
- large dining kitchen, lounge, and ground floor WC

Viewing

Please contact our Office on 01302 751616 if you wish to arrange a viewing appointment for this property or require further information.



Floor Plan

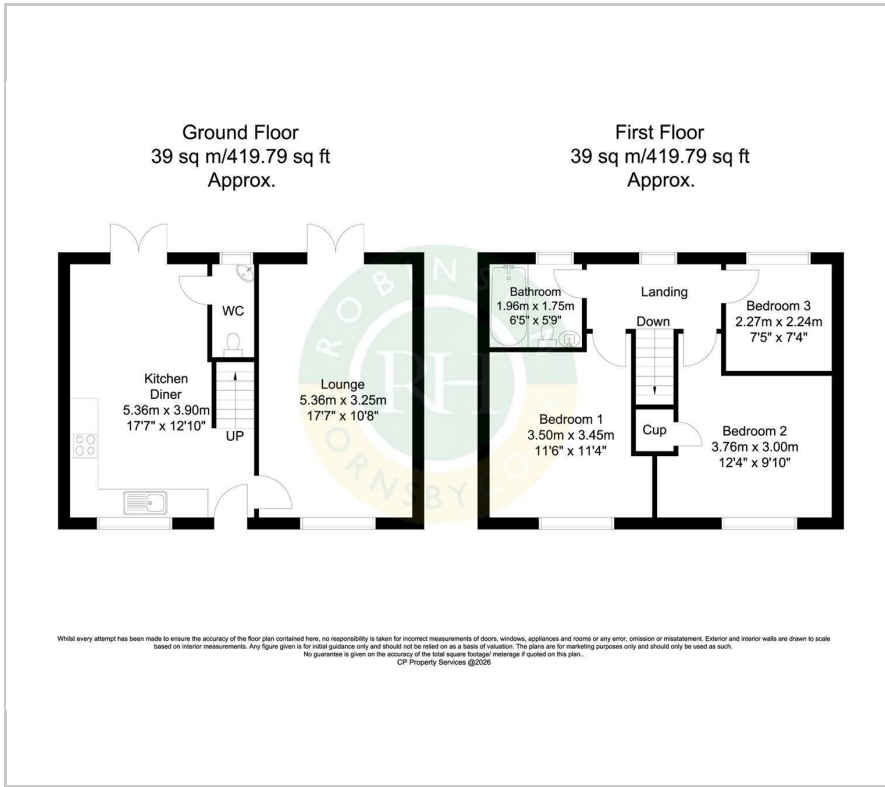

Area Map



Energy Efficiency Graph

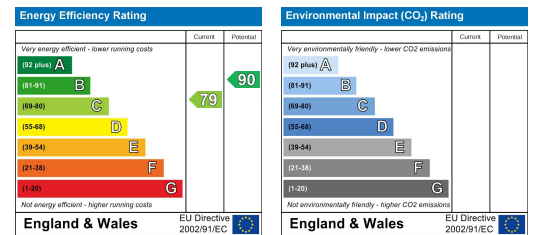

These particulars, whilst believed to be accurate are set out as a general outline only for guidance and do not constitute any part of an offer or contract. Intending purchasers should not rely on them as statements of representation of fact, but must satisfy themselves by inspection or otherwise as to their accuracy. No person in this firm's employment has the authority to make or give any representation or warranty in respect of the property.