



De Warrene Court, Norfolk, IP26 4RT

Rent - Guide Price £250,000 Deposit -

TO BE SOLD BY MODERN METHOD OF AUCTION

A well presented modern detached 3 bedroom bungalow residence with garage pleasantly situated in a small cul-de-sac within the Norfolk village of Methwold. The property benefits from comfortable, contemporary accommodation throughout and an early viewing is recommended.

- 3-BEDROOM DETACHED BUNGALOW
- UPVC DOUBLE GLAZING
- GARAGE & OFF ROAD PARKING
- CONTEMPORARY FIXTURES & FITTINGS
- VIEWINGS RECOMMENDED
- MODERN DEVELOPMENT OF HOMES
- UNDERFLOOR AIR SOURCE HEATING
- EDGE OF VILLAGE LOCATION
- EN-SUITE
- TO BE SOLD VIA AUCTION



Council Tax Band: D - EPC Rating: B 85

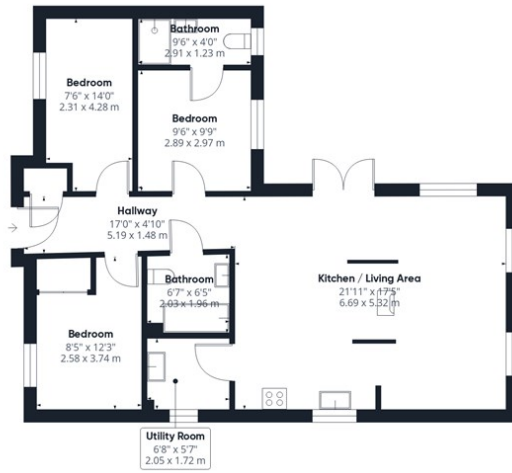

Ground Floor Building 1



Ground Floor Building 2

Approximate total area⁽¹⁾
 1129 ft²
 104.8 m²

(1) Excluding balconies and terraces

Calculations reference the RICS IPMS 3C standard. Measurements are approximate and not to scale. This floor plan is intended for illustration only.

GIRAFFE 360

