

St Uny Crescent Carn Brea Village TR15 3BD

Guide Price £170,000

Tenure - Freehold

Council Tax Band - B

Floor Area - 678.12 sq ft

- TWO BEDROOM DETACHED BUNGALOW
 - CASH BUYERS ONLY
 - OFF ROAD PARKING AVAILABLE
- TUCKED AWAY RESIDENTIAL LOCATION
 - WRAP-AROUND GARDEN
 - SHORT DRIVE AWAY FROM LOCAL AMENITIES
 - NO ONWARD CHAIN
- DOUBLE GLAZING THROUGHOUT
- CONNECTED TO ALL MAINS SERVICES
- PLEASE SCAN THE QR CODE FOR MATERIAL INFORMATION



 **Millerson**
millerson.com

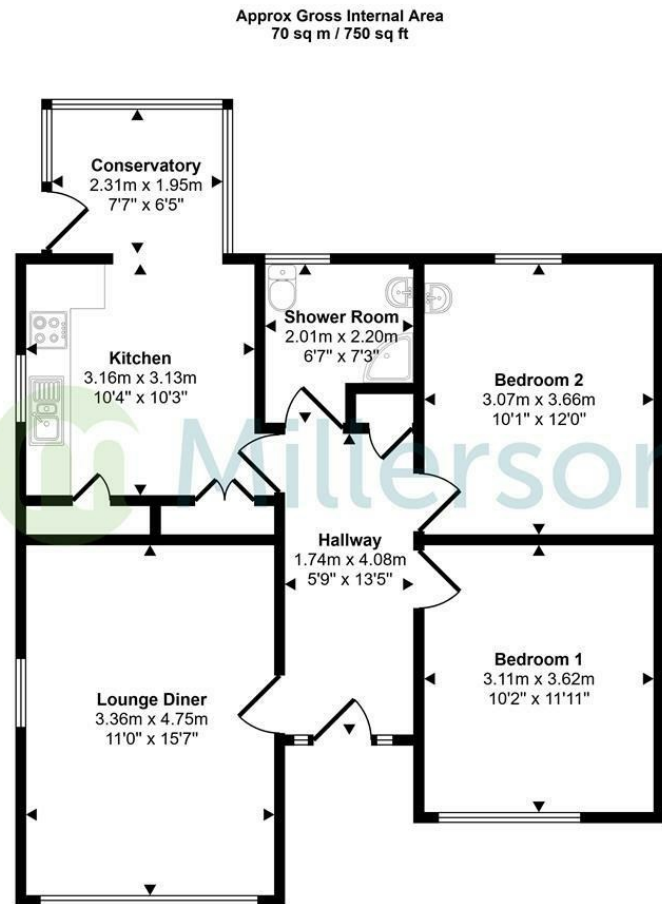

Floorplan

This floorplan is only for illustrative purposes and is not to scale. Measurements of rooms, doors, windows, and any items are approximate and no responsibility is taken for any error, omission or mis-statement. Icons of items such as bathroom suites are representations only and may not look like the real items. Made with Made Snappy 360.

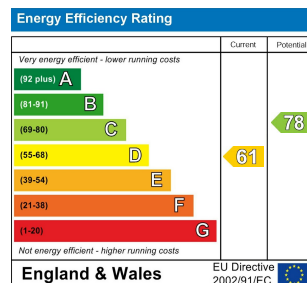

Needing To Sell?

Are you interested in this property but aren't currently in a proceedable position?

Don't Panic!

Contact Us On The Details Below To Arrange A Valuation



Here To Help

29 Commercial Street
Camborne
Cornwall
TR14 8JY

E: camborne@millerson.com

T: 01209 612255

www.millerson.com

Scan QR For
Material Information



Scan
me!