



£215,000 Region



- End back to back terrace
- 4 bedrooms, bathroom and shower room w/c
- Prime Hyde Park location
- Let until 30th June 2026
- Gross rent £26,052 inc bills
- Close to universities & city centre



A FOUR BEDROOMED END BACK TO BACK TERRACE, LOCATED IN THIS PRIME LETTING LOCATION IN HYDE PARK, A SHORT WALK TO LOCAL SHOPS, THE HYDE PARK PICTURE HOUSE, PUBS, TRAIN STATION, THE LOVELY OPEN SPACES OF HYDE PARK WITH THE UIVERSITIES AND CITY CENTRE JUST BEYOND.

An ideal investment purchase, the property is currently let until 30th June 2026 at £26,052 including bills (circa £19,396 p/a excluding bills).

The accommodation comprises an open plan lounge and modern fitted kitchen, a lower ground floor bedroom and shower room w/c, two first floor bedrooms and a further fourth bedroom and bathroom w/c on the top floor with large dormer windows.

The property is street lined with ample on street parking.

The pitched and flat roof were renewed in March 2025 with a guarantee in place.

The property has a lawful use C4 (HMO) certificate.

The sale is subject to the successful buyer retaining the current lettings management agent, Springwell Properties, until at least the remainder of the agreed tenancy.





Score	Energy rating	Current	Potential
92+	A		
81-91	B		84 B
69-80	C		
55-68	D	68 D	
39-54	E		
21-38	F		
1-20	G		

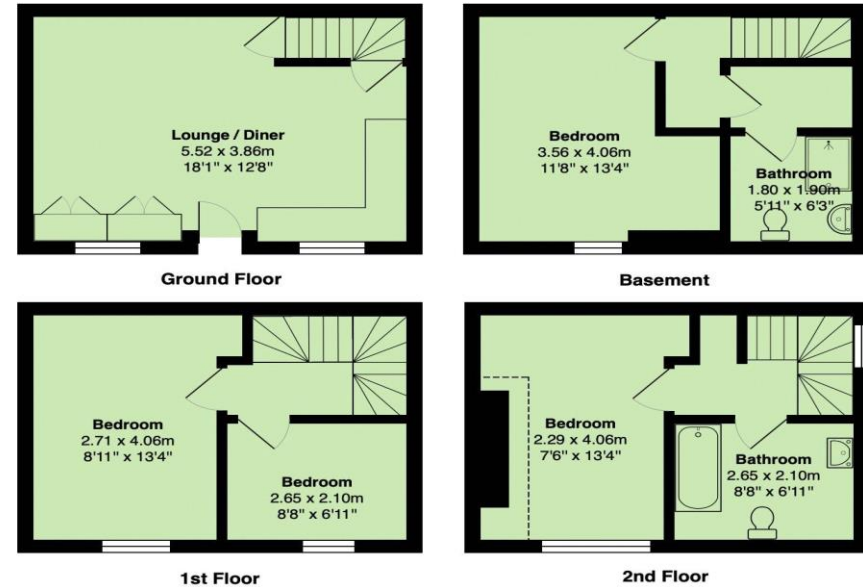

Total Area: 88.3 m² ... 951 ft²

Tenure	Freehold
Council Tax Band	A
Possession	Sold subject to existing tenancies
Offer procedure	

If you would like to make an offer on this property, please contact our office as soon as possible. Any evidence of funding you can provide to support your offer will help to inform the seller of your position.

We strongly advise taking independent mortgage advice and can recommend a mortgage broker along with other property professionals.

Viewings

All viewings are by appointment. Please note that some viewing arrangements may require at least 24 hours notice.

Appliances/Services

None of the above appliances/services have been tested by ourselves. We recommend purchasers arrange for a qualified person to check all appliances/services before legal commitment.

Management Clause

If a third party agent is involved with the letting of this property, there may be associated obligations and fees for a buyer. We advise your legal advisor checks any agreements or contracts prior to commitment.

Houses in Multiple Occupation (HMO)

This property is in an Article 4 direction area which relates to Houses in Multiple Occupation (HMO's). Please see the [Leeds City Council website](#) for more information