



## Adelaide Avenue, SE4

£1,500 Per calendar month

Overlooking Hilly Fields, this charming second floor flat within this pretty period building is ideally placed for Ladywell station. The property comprises an open-plan reception room/kitchen area, one double bedroom, and a modern en-suite bathroom.

Within easy reach of the high streets in Crofton Park, Brockley and Honor Oak Park where there are a number of restaurants. Ladywell Station is less than a 5 minute walk away.

### Features

- Second Floor Flat
- Open Plan Kitchen / Reception
- Modern En-Suite Bathroom
- Spacious Double Bedroom
- Opposite Hilly Fields
- Close to Ladywell station

Adelaide Avenue,  
London, SE4

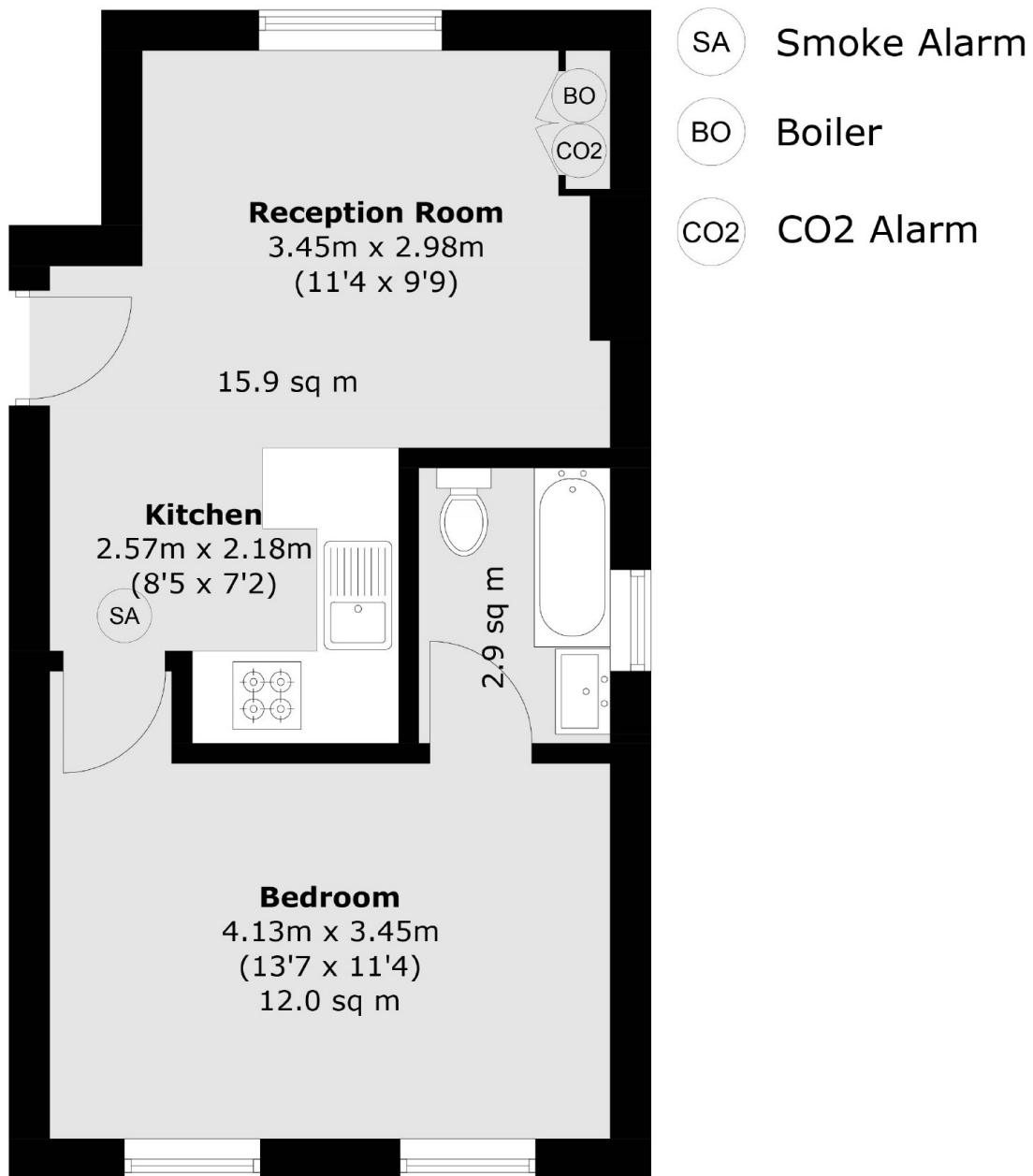

Total area (approx.): 32.2 sq. m (346.6 sq. ft)