



DRAGMORE STREET, SW4

£2,650 PCM

- New build development
- Two bedrooms
- Two bathrooms
- Private balcony
- Open plan
- Energy rating: C





ABOUT THE HOME

A luxury two double bedroom, two bathroom apartment on the third floor, with a private balcony. The property would be suitable for a couple or two sharers.

Situated in the heart of the Clapham Park, Dragmore Street is convenient for access to Clapham South and Brixton.





Second Floor

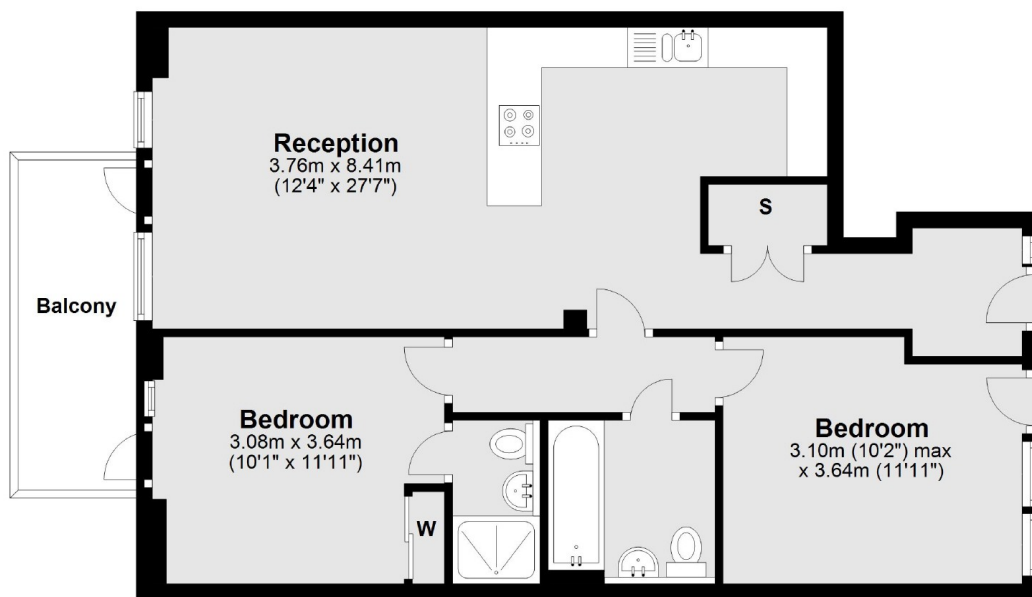

Total area: approx. 68.6 sq. metres (737.9 sq. feet)

JACKSONS CLAPHAM

73 Abbeville Road, London,
SW4 9JN
Sales: 020 8487 3177
Lettings: 020 8487 3178

Energy Rating: C We aim to make our particulars both accurate and reliable. However they are not guaranteed; nor do they form part of an offer or contract. If you require clarification on any points then please contact us, especially if you're traveling some distance to view. Please note that appliances and heating systems have not been tested and therefore no warranties can be given as to their good working order.