



Living  
made  
better

Hoola Apartments  
Royal Victoria Dock, E16 1UW



Asking Price £575,000

# Hoola Apartments, Royal Victoria Dock, E16 1UW

Madison Brook

## Property Summary

A spacious two bedroom apartment set on the seventh floor offering approximately 899 sq ft of living space, featuring a large open-plan reception/kitchen area and an impressive wrap-around balcony with dock views. Residents benefit from a 24-hour concierge, gym, and allocated parking, and the property is chain free, ideally located close to Royal Victoria DLR, Canning Town Underground and the Elizabeth Line.

Service Charge: £5,259 pa | Ground Rent: £450 pa | Lease Remaining: 989 years

## Floorplan

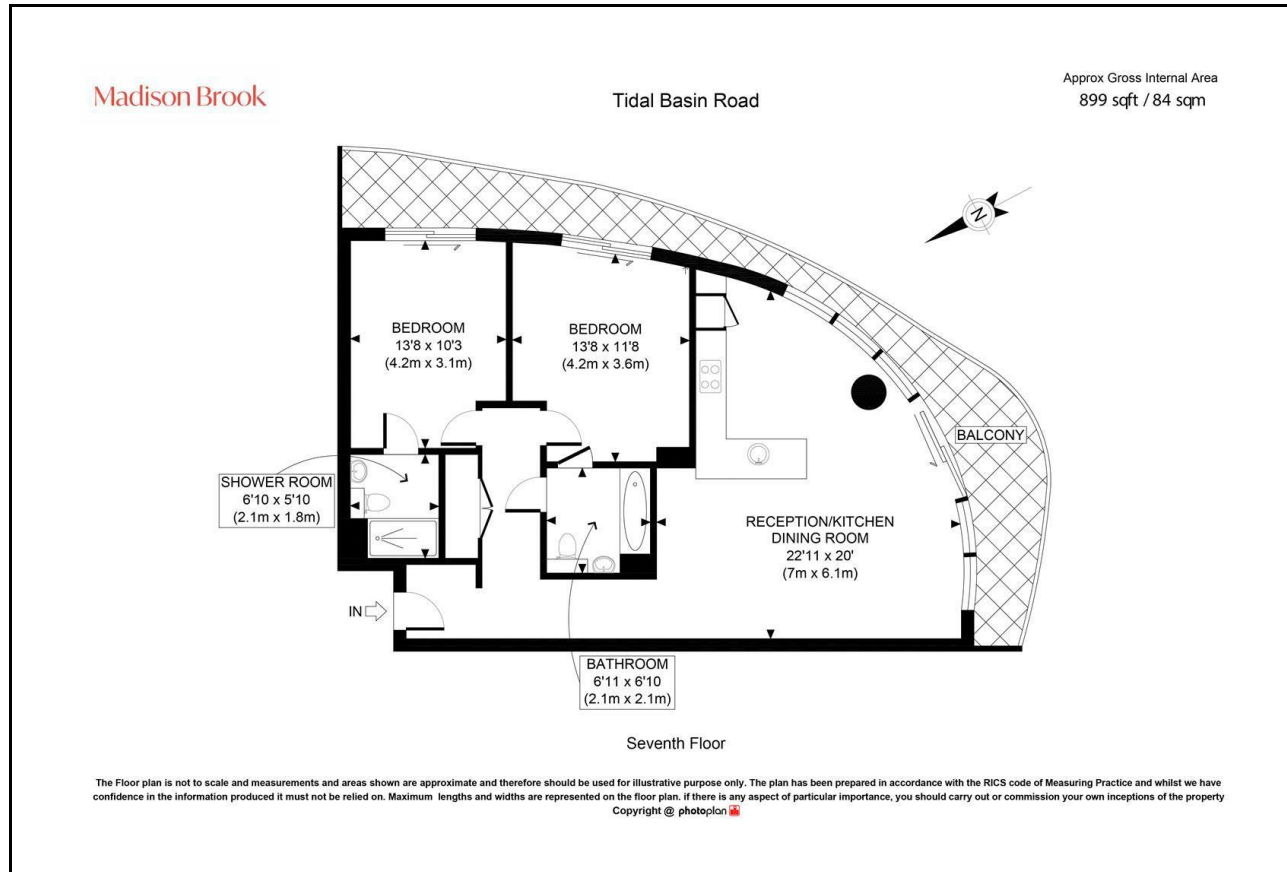

## Area Map

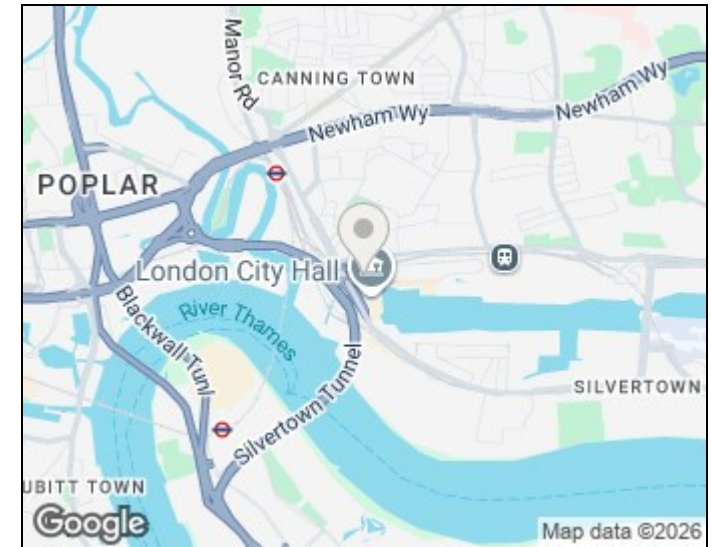

## Energy Efficiency Graph

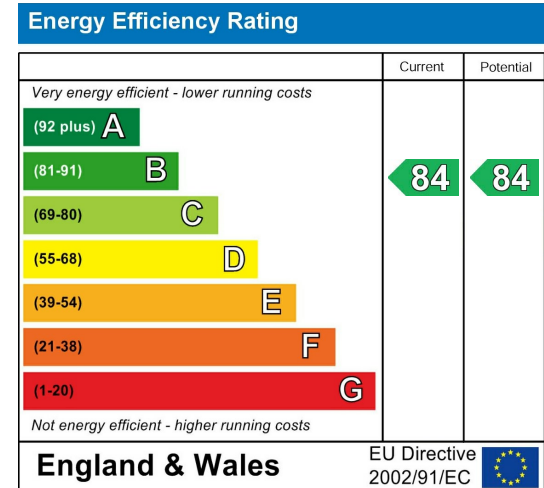

These particulars, whilst believed to be accurate are set out as a general outline only for guidance and do not constitute any part of an offer or contract. Intending purchasers should not rely on them as statements of representation of fact, but must satisfy themselves by inspection or otherwise as to their accuracy. No person in this firm's employment has the authority to make or give any representation or warranty in respect of the property.

Unit B 20 Western Gateway, Royal Victoria  
Dock, London, E16 1BS  
Tel: 020 3946 6000 Email:  
docklands@madisonbrook.com  
<https://madisonbrook.com/>